

THIS COPY IS PROVIDED ON A RESTRICTED BASIS AND IS NOT TO BE USED IN ANY WAY DETRIMENTAL TO THE INTERESTS OF PANDUIT CORP.

NOTE: PIN DRIVEN IN FLUSH  
HERE AT ASSEMBLY

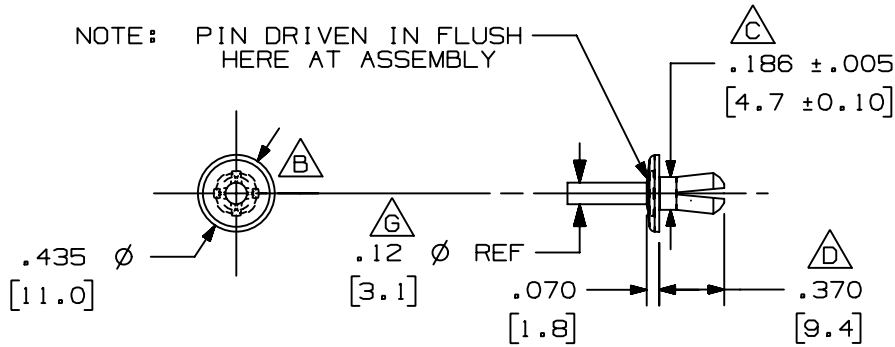

PANDUIT P/N	WEIGHT
NR1 -	.11LB/ 100PCS. (50g/ 100PCS.)

- NOTES:
- SEE CURRENT CATALOG FOR ADDITIONAL PART SUFFIXES TO INDICATE COLOR AND OR PACKAGE QUANTITY.
  - DIMENSIONS IN PARENTHESES ARE METRIC.

F A I

TOTAL THICKNESS PANEL & DUCT	HOLE SIZE + .005 [ .10 ] - .000 [ .00 ]	ANSI STANDARD STRAIGHT SHANK TWIST DRILL BIT SIZE
.156 - .187 [ 4.0 - 4.7 ]	.187 [ 4.7 ]	15
.187 - .218 [ 4.8 - 5.5 ]	.193 [ 4.9 ]	11
.219 - .250 [ 5.6 - 6.35 ]	.203 [ 5.2 ]	7
.251 - .281 [ 6.38 - 7.1 ]	.213 [ 5.4 ]	4

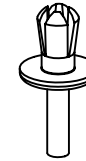

E

CAD FILENAME/LAYERS D36401BA\_DC\_NR1\_RIVET\_01C.prt

PANDUIT CORP. TINLEY PARK, ILLINOIS

PUSH RIVET  
(NR1)

UNLESS OTHERWISE SPECIFIED,  
DIMENSIONAL TOLERANCES ARE:  
(.X) ± (.XXX) ± .020 (.5)  
(.XX) ± ANGLES ±

UNLESS OTHERWISE SPECIFIED,  
ALL DIMENSIONS ARE GIVEN  
IN INCHES, THIRD ANGLE PROJECTION.

DRAWN BY  
R<sup>2</sup>  
DATE  
1-29-64  
CHK'D  
CEF

MAT'L:  
NYLON 6/6  
NATURAL

SCALE FULL

DRAWING NO.  
D-191

DWG  
SIZE  
A

REV	DATE	BY	CHK	DESCRIPTION	ECN	R	CUST	SUP
--	-----	---	---	J. ADDED DRILL BIT SIZE I. CHANGED COLUMN TITLE	-----	---	---	
9	11-23-05	JCST	JKG	H. CHANGED DIMENSIONS TO RANGES G. ADDED REFERENCE DIMENSION	D-191	JKG	JKG	
8	8-29-01	JCST	JKG	F. DUAL DIMENSIONED CHART.	D-191	JKG	JKG	
7	9-13-00	JHNU	HIW	E. REVISED AND REDRAWN	D-191	HIW	HIW	
6	4-15-84	DW/CEF	DW/CEF	D. REV'D DIM WAS .380 C. REV'D DIM. WAS .185 AND ADDED TOL.	D-191	CEF	CEF	
5	7-31-79	RJ/MP	RJ/MP	B. ADDED RING SLOT TO FACE OF HEAD, ECN 191-5	D-191	JSR	JSR	
4	3-18-76	REC	REC	A. ADDED PANEL & HOLE SIZE CHART.	D-191	JSR	JSR	
3	9-26-72	JRL	JRL	REDRAWN WITH FORMAT CHANGE	D-191	JSR	JSR	