

- NOTES:**
- THIS PRODUCT IS RoHS COMPLIANT.
 - MATERIALS:**
 CENTER PIN: COPPER ALLOY, NICKEL PLATED
 SLEEVE CONTACT: SPRING COPPER ALLOY, SILVER PLATED
 PIN TERMINAL AND SHUNT: COPPER ALLOY, SILVER PLATED
 HOUSING AND COVER: HIGH TEMPERATURE THERMOPLASTIC, BLACK
 - SPECIFICATIONS:**
 LIFE: 5000 CYCLES;
 INSERTION FORCE: 5LB [2.3 KG] MAX;
 WITHDRAWL FORCE: 0.5 LB [0.2 KG] MIN;
 CONTACT RESISTANCE: 30 MILLIOHM MAX, 60 MILLIOHM MAX. AFTER TEST;
 INSULATION RESISTANCE: 30 MEGAOHM MIN. @ 100VDC;
 DIELECTRIC WITHSTANDING VOLTAGE: 250VAC FOR 1 MINUTE;
 CURRENT (CARRYING): 5A
 OPERATING TEMPERATURE: -30°C TO +65°C

CUSTOMER DRAWING

| | | | | | | | | | | | |
|-----------|------------|---------|----|------|--|--|-------|-------|--------------|--------------|--|
| | | | | | STAR SYMBOL DENOTES CRITICAL DIMENSION | THIS DRAWING DESCRIBES A DESIGN CONSIDERED PROPRIETARY IN NATURE, DEVELOPED AND MANUFACTURED BY SWITCHCRAFT INC. AND IS RELEASED ON A CONFIDENTIAL BASIS FOR IDENTIFICATION PURPOSES ONLY. | | | | | |
| | | | | | UNLESS OTHERWISE SPECIFIED | SIZE | WIDTH | MULT | LBS/M | TEMPER | |
| | | | | | 1. ALL DIMENSIONS IN INCHES | FINISH | | | | MATERIAL | |
| | | | | | - TWO PLACE DECIMALS ±0.02 | SPEC No. | | | | SPEC No. | |
| | | | | | - THREE PLACE DECIMALS ±0.005 | FIRST USED ON | | SCALE | | Switchcraft® | |
| | | | | | | 4:1 | | | | | |
| A | ECO 25775 | 1/22/07 | BS | TJK | DATE DRAWN | BY | CHKD | APVD | SHEET 1 OF 2 | | |
| REV | ECO NUMBER | DATE | BY | APVD | 1/17/07 | BS | TJK | TJK | PART No. | | |
| REVISIONS | | | | | DO NOT SCALE DRAWING | | | | | RASH712BK | |
| | | | | | | | | | | REV A | |

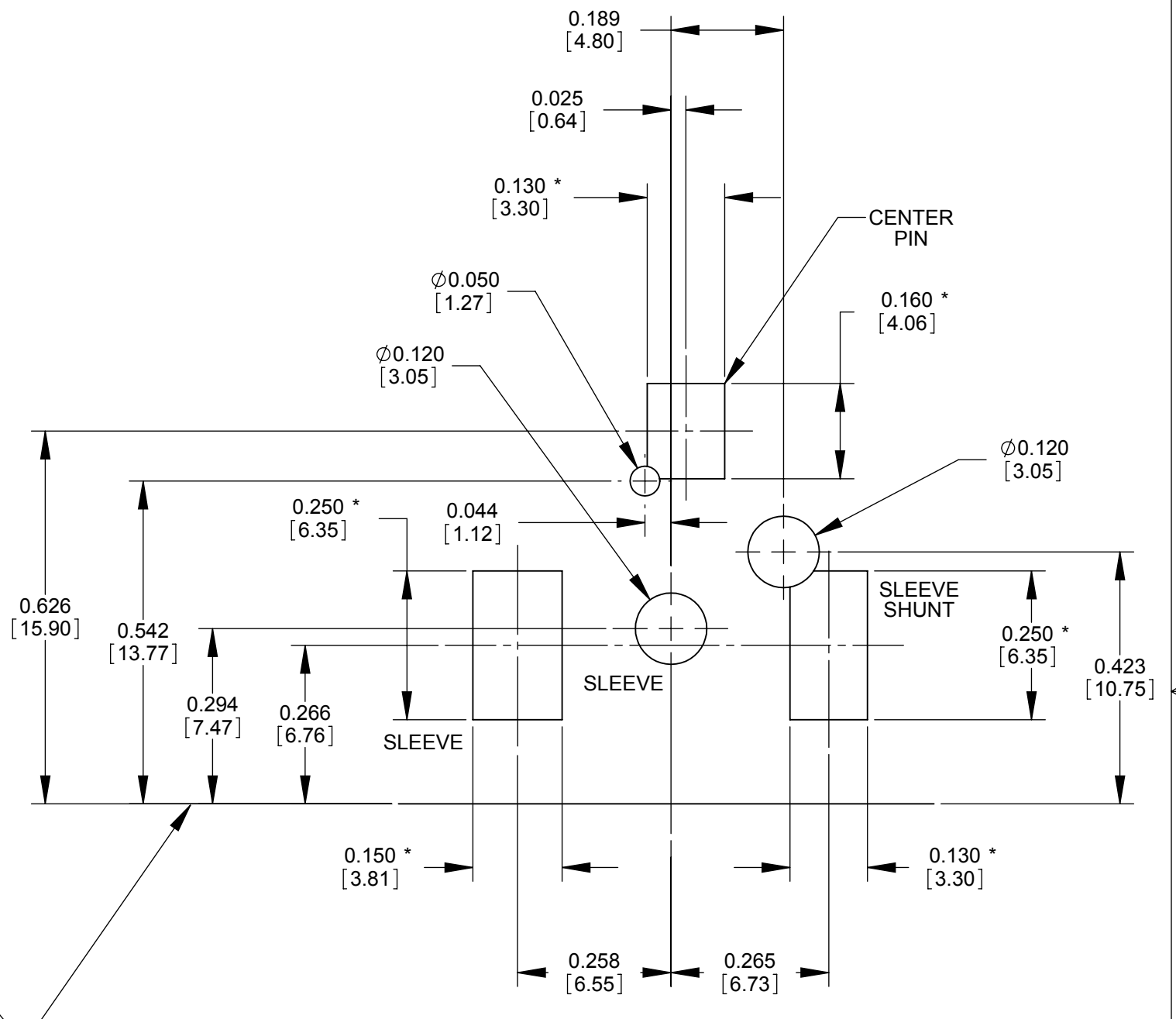
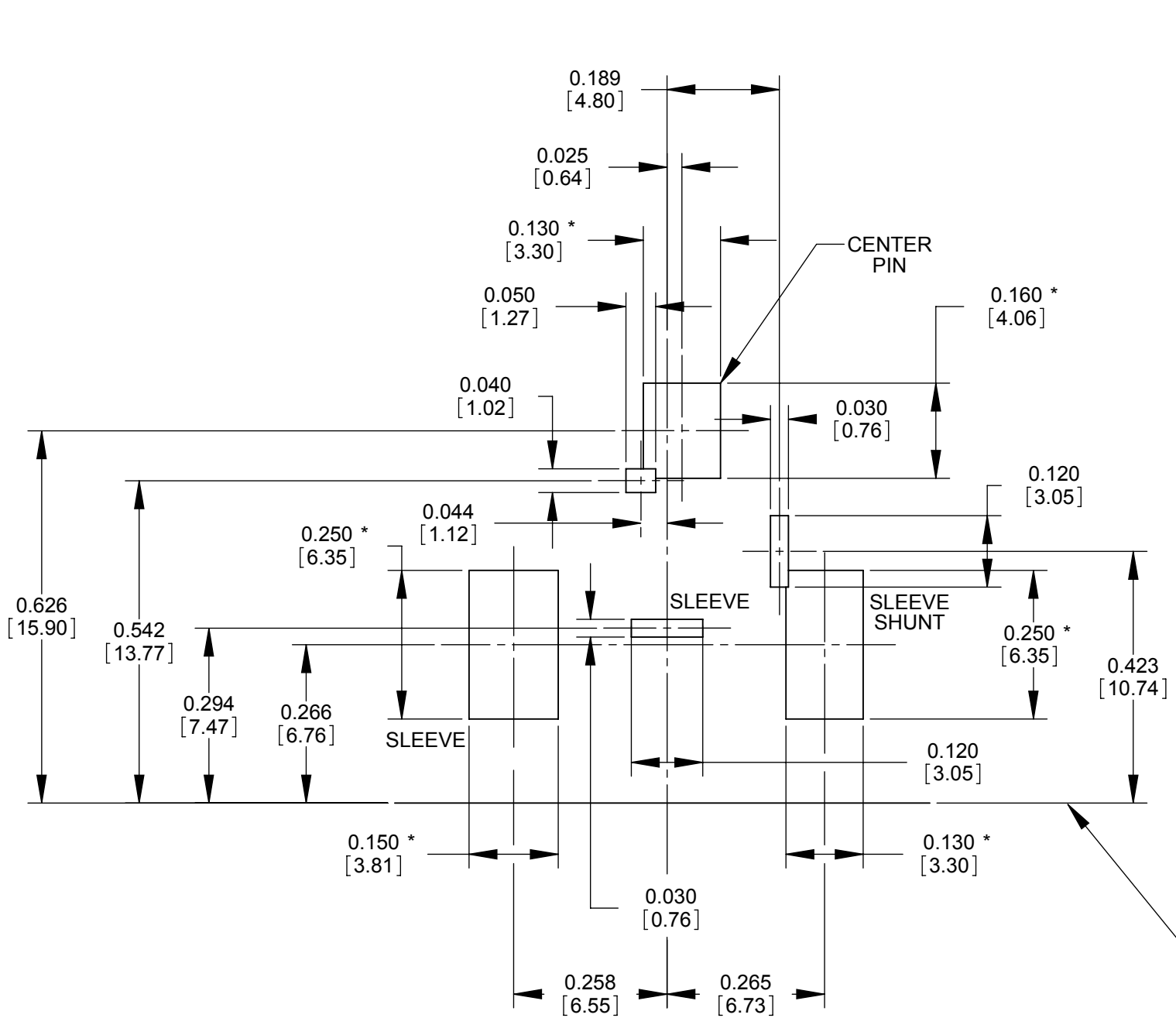

JACK MATING FACE
(EDGE OF PC BOARD)

RECOMMENDED PC BOARD LAYOUT
(COMPONENT SIDE)

ALTERNATE PC BOARD LAYOUT
(COMPONENT SIDE)

CUSTOMER DRAWING

NOTE: * SURFACE MOUNT PADS.

| | | |
|------------------------|---------------------------------|----------|
| SCALE 4:1 | Switchcraft [®] | |
| DATE DRAWN 08/20/08 | | |
| DRAWN BY BS | TOOL No. RASH712BK | REV A |