

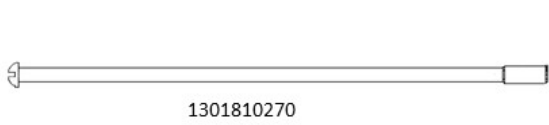

# Product Change Notification

|   |   |                     |        |
|---|---|---------------------|--------|
| <b>Date Issued :</b>                              | November 04, 2022   | <b>PCN Number :</b> | 512855 |
| <b>Reason for Change :</b>                        | Change Supplier   |                     |        |
| <b>Description of Change :</b>                    | Add a new supplier to increase capacity to cover any future customer demand |                     |        |
| <b>Assessment of Change :</b>                     | First Article Inspection  |                     |        |
| <b>Planned Implementation Date :</b>              | May 31, 2023  |                     |        |
| <b>Sample Availability Date:</b>                  | March 24, 2023  |                     |        |
| <b>Internal Molex Qualification Date :</b>        | May 18, 2023  |                     |        |
| <b>Last date to request Samples by Customer :</b> | March 24, 2023  |                     |        |
| <b>Traceability Code Markings / Date :</b>        | Date code   |                     |        |

Before Picture



1301810270



1302264172

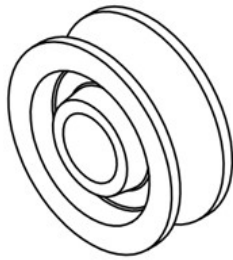

1302263862

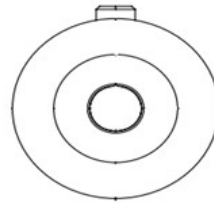

1302263049

1 1

Molex Confidential Information  
 © 2016 Molex – All Rights Reserved. Unauthorized Reproduction/Distribution is Prohibited.



After Picture

## Overview

- This notification is to inform you about addition of new Supplier or Sub Supplier impacting the part(s) as per attached list. No changes will be made to product as part of this change
- Product Impact
  - No impact to fit, form or function.
- Part Number Impact
  - See attached impacted parts list
- NO PPAP or samples available.

2

Molex Confidential Information  
© 2016 Molex – All Rights Reserved. Unauthorized Reproduction/Distribution is Prohibited.

**molex**

# RELEASED

You may address inquires regarding this PCN by clicking on the below link  
[mailto:pcn\\_coordinator@molex.com?subject=PCN\\_Notification:512855](mailto:pcn_coordinator@molex.com?subject=PCN_Notification:512855)  
or contact your Local Sales Engineer.

Note: While responding, please retain " PCN Notification : **PCN Notification: 512855** " in the e-mail Subject line for faster response.

[Molex, LLC](#)  
2222 Wellington Court  
Lisle, IL 60532  
TEL (800) 786-6539  
[www.molex.com](http://www.molex.com)

**PCN No Part List**

512855 [1300840042](#)

512855 [1300840053](#)

512855 [1300840068](#)

512855 [1300840077](#)

512855 [1300840078](#)

512855 [1300840099](#)

512855 [1300840120](#)

512855 [1300840343](#)

512855 [1300840373](#)

512855 [1300920037](#)

512855 [1301250001](#)

512855 [1301250002](#)

512855 [1301250004](#)

512855 [1301250014](#)

512855 [1301250016](#)

512855 [1301250018](#)

512855 [1301250020](#)

512855 [1301250022](#)

512855 [1301250024](#)

512855 [1301250027](#)

512855 [1301250029](#)

512855 [1301250031](#)

512855 [1301250033](#)

512855 [1301250037](#)

512855 [1301250042](#)

512855 [1301250043](#)

512855 [1302260079](#)

512855 [1302260080](#)

512855 [1302262224](#)

512855 [1302262236](#)