

- NOTES:
- MATERIAL:
HOUSING - GLASS FILLED THERMOPLASTIC, 94-V0, BLACK
TERMINALS - HIGH PERFORMANCE COPPY ALLOY
 - FINISH:
CONTACT AREA: SELECT GOLD 0.76µm MIN
SOLDER TAIL: 2.54µm MIN TIN (MATTE)
UNDERPLATE: 1.27µm MIN NICKEL ALL OVER
 - PRODUCT SPECIFICATION: PS-151038-0001(TBD)
 - PACKAGING SPECIFICATION: PK-151038-0001.
 - APPLICATION SPECIFICATION: AS-151038-0001 (TBD)
 - MATING PC BOARD THICKNESS = 1.60±0.16MM OVER CONTACT PADS.
 - PRODUCT IS ELV AND RoHS COMPLIANT, LEVEL OF COMPLIANCE:6/6

ALL BANNED SUBSTANCES ARE REMOVED:

- Pb (LEAD)
- HEXAVALENT CHROMIUM (CrVI)
- CADMIUM
- MERCURY
- POLYBROMINATED BIPHENYL (PBB)
- POLYBROMINATED DIPHENYL ETHER (PBDE)

8. THIS PART CONFORMS TO CLASS B REQUIREMENTS OF COSMETIC SPEC PS-45499-002.

STANDOFF ADDED EC NO: S2015-0846 DRAWN: MHL LONG 2015/01/28 CHKD: CGTAN 2015/02/09 APPR: SHLENI 2015/02/09	QUALITY SYMBOLS ∇=0 ∇=0 ∇=0	GENERAL TOLERANCES (UNLESS SPECIFIED) <table border="1"> <tr> <th></th> <th>mm</th> <th>INCH</th> </tr> <tr> <td>4 PLACES</td> <td>± ---</td> <td>± ---</td> </tr> <tr> <td>3 PLACES</td> <td>± ---</td> <td>± ---</td> </tr> <tr> <td>2 PLACES</td> <td>± 0.15</td> <td>± ---</td> </tr> <tr> <td>1 PLACE</td> <td>± 0.25</td> <td>± ---</td> </tr> <tr> <td>0 PLACE</td> <td>± ---</td> <td>± ---</td> </tr> </table>		mm	INCH	4 PLACES	± ---	± ---	3 PLACES	± ---	± ---	2 PLACES	± 0.15	± ---	1 PLACE	± 0.25	± ---	0 PLACE	± ---	± ---	DIMENSION STYLE MM ONLY DRAWN BY DATE MHL LONG 2013/11/15 CHECKED BY DATE CGTAN 2014/05/22 APPROVED BY DATE SHLENI 2014/05/30	SCALE 4:1 DESIGN UNITS METRIC THIRD ANGLE PROJECTION	TITLE EDGE LINE+ 98CKTS .062" PCB 0.75MM PITCH SALES DRAWING molex
		mm	INCH																				
	4 PLACES	± ---	± ---																				
	3 PLACES	± ---	± ---																				
	2 PLACES	± 0.15	± ---																				
1 PLACE	± 0.25	± ---																					
0 PLACE	± ---	± ---																					
	ANGULAR ±1/2° DRAFT WHERE APPLICABLE MUST REMAIN WITHIN DIMENSIONS	MATERIAL NO. 1510380098 SIZE C	DOCUMENT NO. SD-151038-0098	SHEET NO. 1 OF 3																			
		THIS DRAWING CONTAINS INFORMATION THAT IS PROPRIETARY TO MOLEX INCORPORATED AND SHOULD NOT BE USED WITHOUT WRITTEN PERMISSION																					

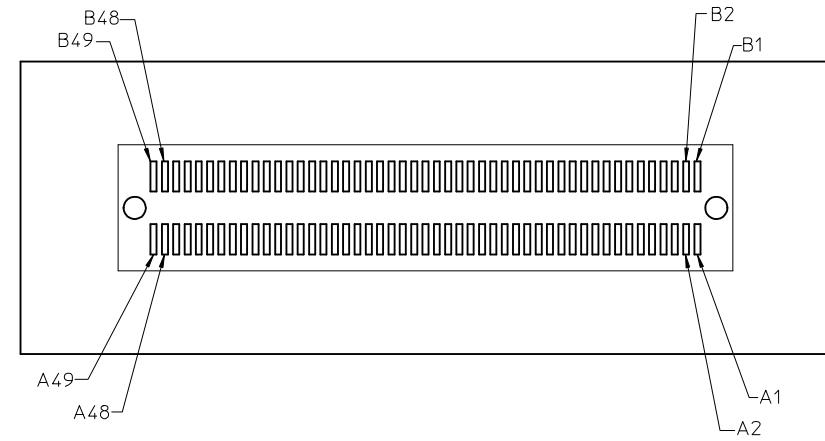
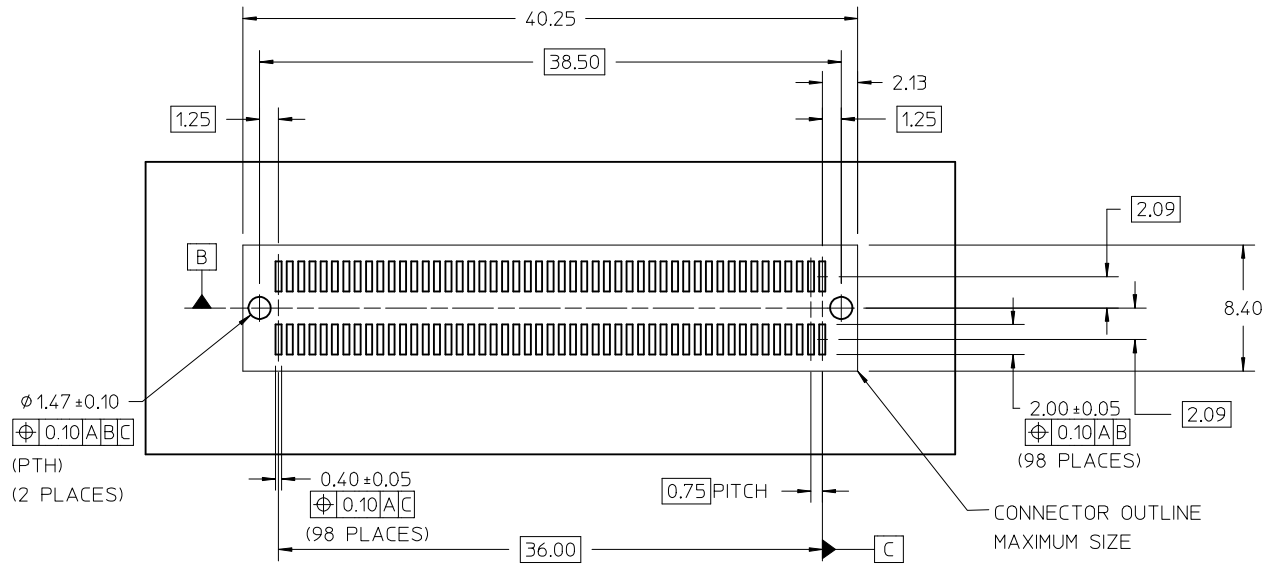

FOOT PRINT NOTES:
 1. DATUM -A- IS THE TOP OF THE PCB

SEE SHEET 1 EC NO: S2015-0846 DRAWN: MHL LONG CHKD: CGTAN APPR: SHLENI	2015/01/28 2015/02/09 2015/02/09	QUALITY SYMBOLS ▽=0 ▽=0 ▽=0	GENERAL TOLERANCES (UNLESS SPECIFIED) <table border="1"> <thead> <tr> <th></th> <th>mm</th> <th>INCH</th> </tr> </thead> <tbody> <tr> <td>4 PLACES</td> <td>± ---</td> <td>± ---</td> </tr> <tr> <td>3 PLACES</td> <td>± ---</td> <td>± ---</td> </tr> <tr> <td>2 PLACES</td> <td>± 0.15</td> <td>± ---</td> </tr> <tr> <td>1 PLACE</td> <td>± 0.25</td> <td>± ---</td> </tr> <tr> <td>0 PLACE</td> <td>± ---</td> <td>± ---</td> </tr> </tbody> </table>		mm	INCH	4 PLACES	± ---	± ---	3 PLACES	± ---	± ---	2 PLACES	± 0.15	± ---	1 PLACE	± 0.25	± ---	0 PLACE	± ---	± ---	DIMENSION STYLE MM ONLY DRAWN BY DATE MHL LONG 2013/11/15 CHECKED BY DATE CGTAN 2014/05/22 APPROVED BY DATE SHLENI 2014/05/30	SCALE 4:1 DESIGN UNITS METRIC THIRD ANGLE PROJECTION	TITLE EDGE LINE+ 98CKTS .062" PCB 0.75MM PITCH SALES DRAWING molex
		mm	INCH																					
	4 PLACES	± ---	± ---																					
	3 PLACES	± ---	± ---																					
	2 PLACES	± 0.15	± ---																					
1 PLACE	± 0.25	± ---																						
0 PLACE	± ---	± ---																						
MATERIAL NO. SEE SHEET 1	DOCUMENT NO. SD-151038-0098	SHEET NO. 2 OF 3																						
DRAFT WHERE APPLICABLE MUST REMAIN WITHIN DIMENSIONS			SIZE C	THIS DRAWING CONTAINS INFORMATION THAT IS PROPRIETARY TO MOLEX INCORPORATED AND SHOULD NOT BE USED WITHOUT WRITTEN PERMISSION																				
SEE SHEET 1																								

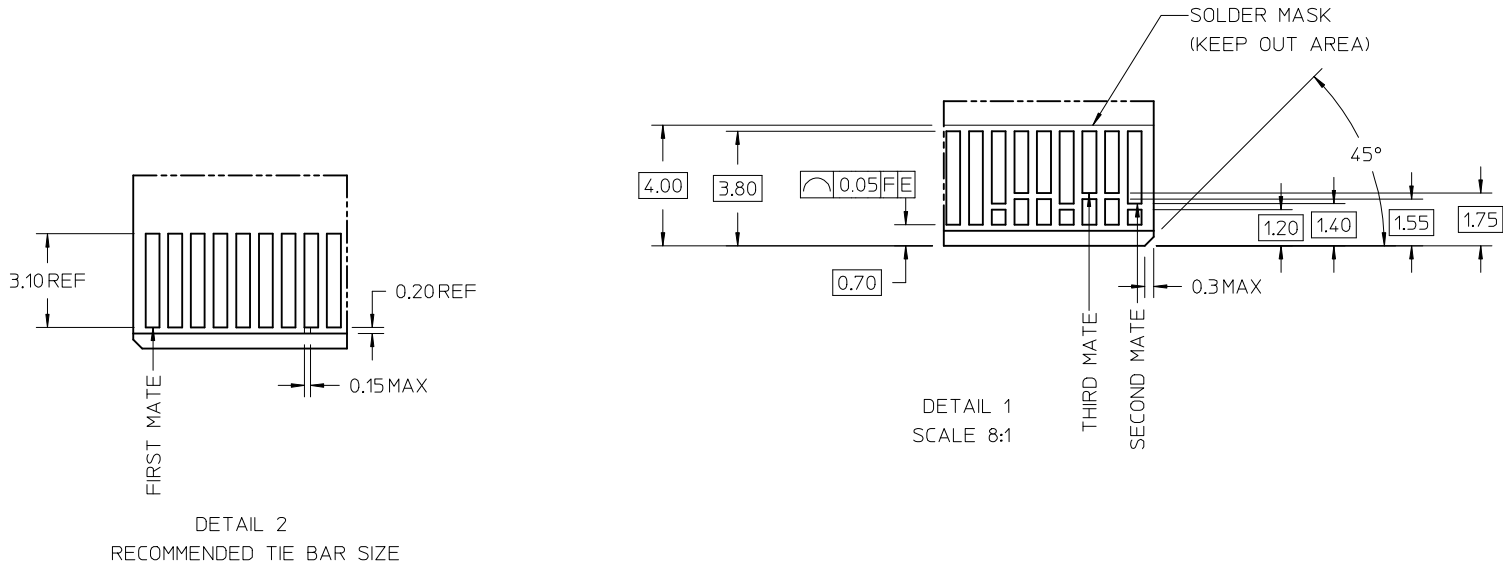
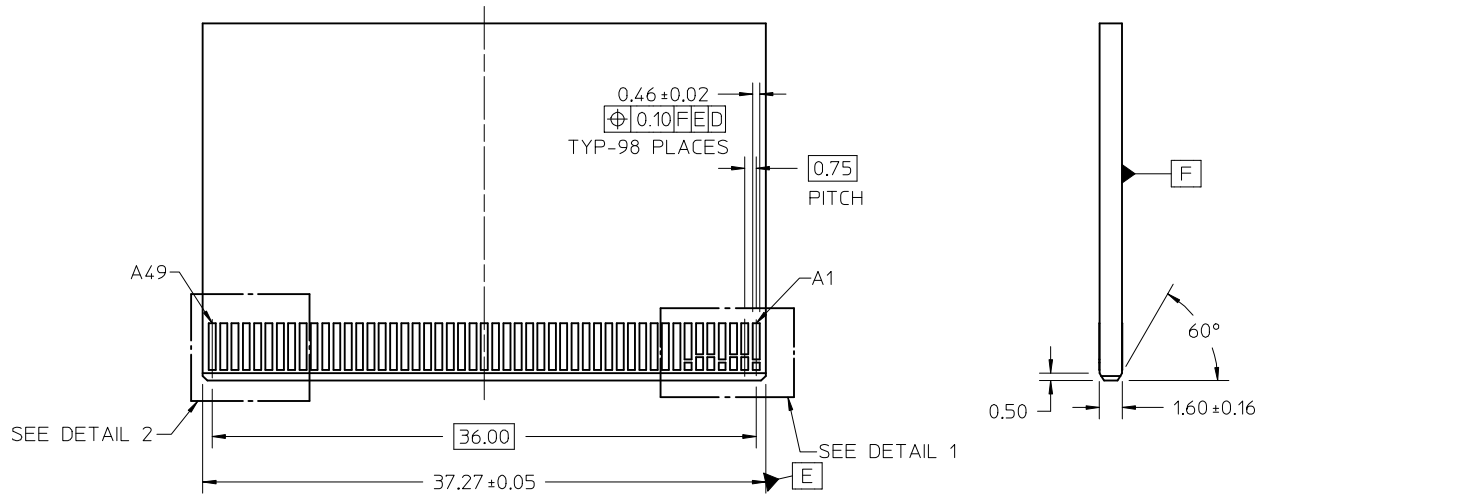

- NOTE:
1. THESE ARE GENERIC DETAILS THAT DESCRIBES THE CONFIGURATION OF VARIOUS PCB DESIGN ELEMENTS. THE CUSTOMER MUST DETERMINE WHERE AND WHEN TO USE EACH ELEMENT TO ACCOMMODATE THEIR SPECIFIC APPLICATION.
 2. CHAMFER ROUGHNESS NOT TO EXCEED 3.17µM.
 3. EDGE CARD CHAMFER NOT TO GO THROUGH GOLD PAD.

SEE SHEET 1 EC NO: S2015-0846 DRAWN: MHL10NG 2015/01/28 CHKD: CGTAN 2015/02/09 APPR: SHLENI 2015/02/09	QUALITY SYMBOLS	GENERAL TOLERANCES (UNLESS SPECIFIED)		DIMENSION STYLE MM ONLY		SCALE 4:1	DESIGN UNITS METRIC	THIRD ANGLE PROJECTION
	▽=0	mm	INCH	DRAWN BY MHL10NG	DATE 2013/11/15	TITLE EDGE LINE+ 98CKTS .062" PCB 0.75MM PITCH SALES DRAWING		
	▽=0	4 PLACES ± --- ± ---	3 PLACES ± --- ± ---	CHECKED BY CGTAN	DATE 2014/05/22			
	▽=0	ANGULAR ±1/2°		APPROVED BY SHLENI	DATE 2014/05/30	molex DOCUMENT NO. SD-151038-0098		
	▽=0	DRAFT WHERE APPLICABLE MUST REMAIN WITHIN DIMENSIONS		MATERIAL NO. SEE SHEET 1	SHEET NO. 3 OF 3			
REV	SIZE C THIS DRAWING CONTAINS INFORMATION THAT IS PROPRIETARY TO MOLEX INCORPORATED AND SHOULD NOT BE USED WITHOUT WRITTEN PERMISSION							

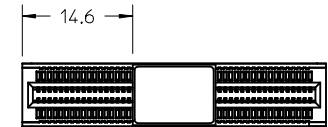
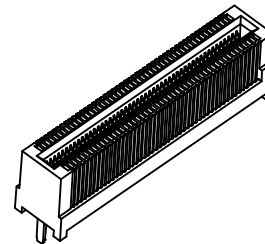
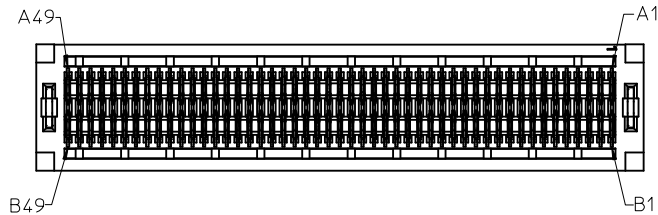
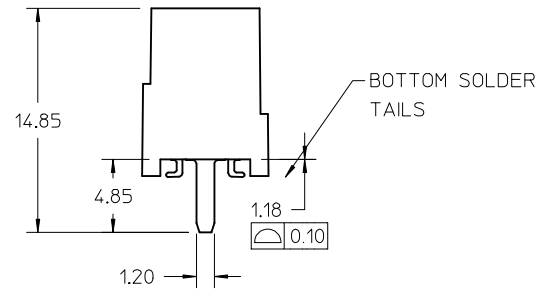
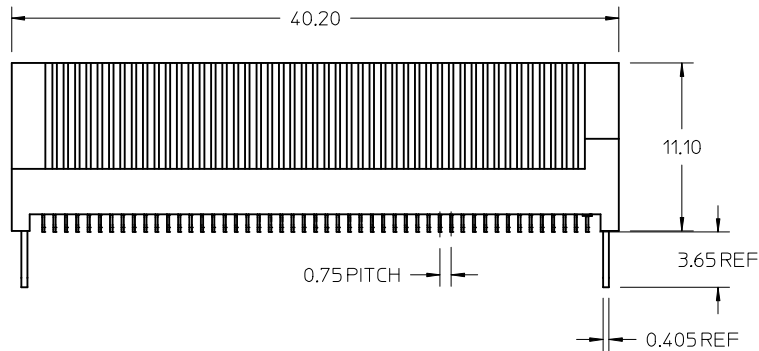
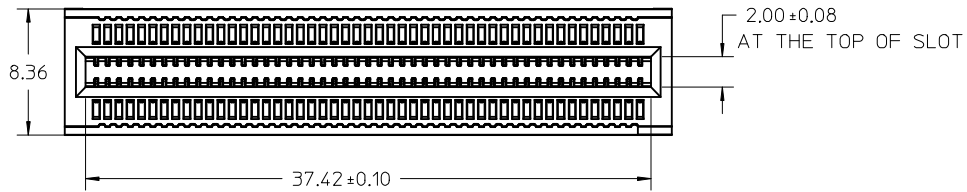

- NOTES:
- MATERIAL:
HOUSING - GLASS FILLED THERMOPLASTIC, 94-V0, BLACK
TERMINALS - HIGH PERFORMANCE COPPY ALLOY
 - FINISH:
CONTACT AREA: SELECT GOLD 0.76µm MIN
SOLDER TAIL: 2.54µm MIN TIN (MATTE)
UNDERPLATE: 1.27µm MIN NICKEL ALL OVER
 - PRODUCT SPECIFICATION: PS-151038-0001(TBD)
 - PACKAGING SPECIFICATION: PK-151038-0001.
 - APPLICATION SPECIFICATION: AS-151038-0001 (TBD)
 - MATING PC BOARD THICKNESS = 1.60±0.16MM OVER CONTACT PADS.
 - PRODUCT IS ELV AND RoHS COMPLIANT, LEVEL OF COMPLIANCE:6/6

ALL BANNED SUBSTANCES ARE REMOVED:

- Pb (LEAD)
- HEXAVALENT CHROMIUM (CrVI)
- CADMIUM
- MERCURY
- POLYBROMINATED BIPHENYL (PBB)
- POLYBROMINATED DIPHENYL ETHER (PBDE)

8. THIS PART CONFORMS TO CLASS B REQUIREMENTS OF COSMETIC SPEC PS-45499-002.

STANDOFF ADDED EC NO: S2015-0846 DRAWN: MHL LONG 2015/01/28 CHKD: CGTAN 2015/02/09 APPR: SHLENI 2015/02/09	QUALITY SYMBOLS	GENERAL TOLERANCES (UNLESS SPECIFIED)		DIMENSION STYLE MM ONLY		SCALE 4:1	DESIGN UNITS METRIC	THIRD ANGLE PROJECTION	
	▽=0	mm	INCH	DRAWN BY	DATE	TITLE EDGE LINE+ 98CKTS .062" PCB 0.75MM PITCH SALES DRAWING			
	▽=0	4 PLACES ± ---	± ---	MHL LONG	2013/11/15				
	▽=0	3 PLACES ± ---	± ---	CHECKED BY	DATE	DOCUMENT NO. SD-151038-0098			
	▽=0	2 PLACES ± 0.15	± ---	CGTAN	2014/05/22				
▽=0	1 PLACE ± 0.25	± ---	APPROVED BY	DATE	SHEET NO. 1 OF 3		THIS DRAWING CONTAINS INFORMATION THAT IS PROPRIETARY TO MOLEX INCORPORATED AND SHOULD NOT BE USED WITHOUT WRITTEN PERMISSION		
▽=0	0 PLACE ± ---	± ---	SHLENI	2014/05/30					
REV	DESCRIPTION	ANGULAR ±1/2°		MATERIAL NO. 1510380098					
		DRAFT WHERE APPLICABLE MUST REMAIN WITHIN DIMENSIONS		SIZE C					

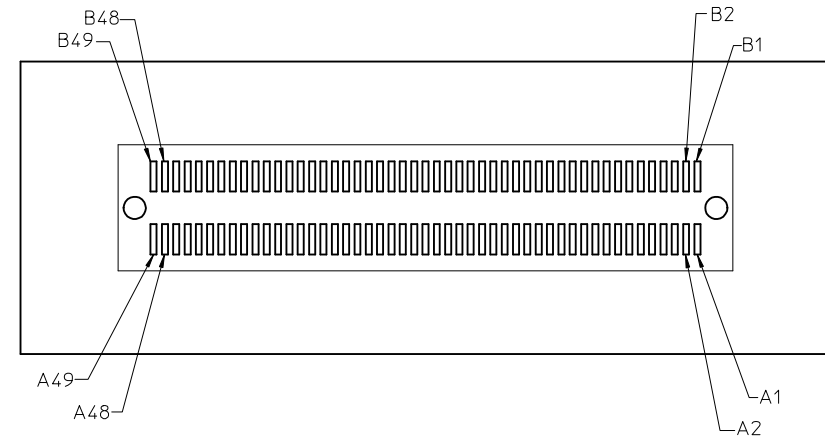
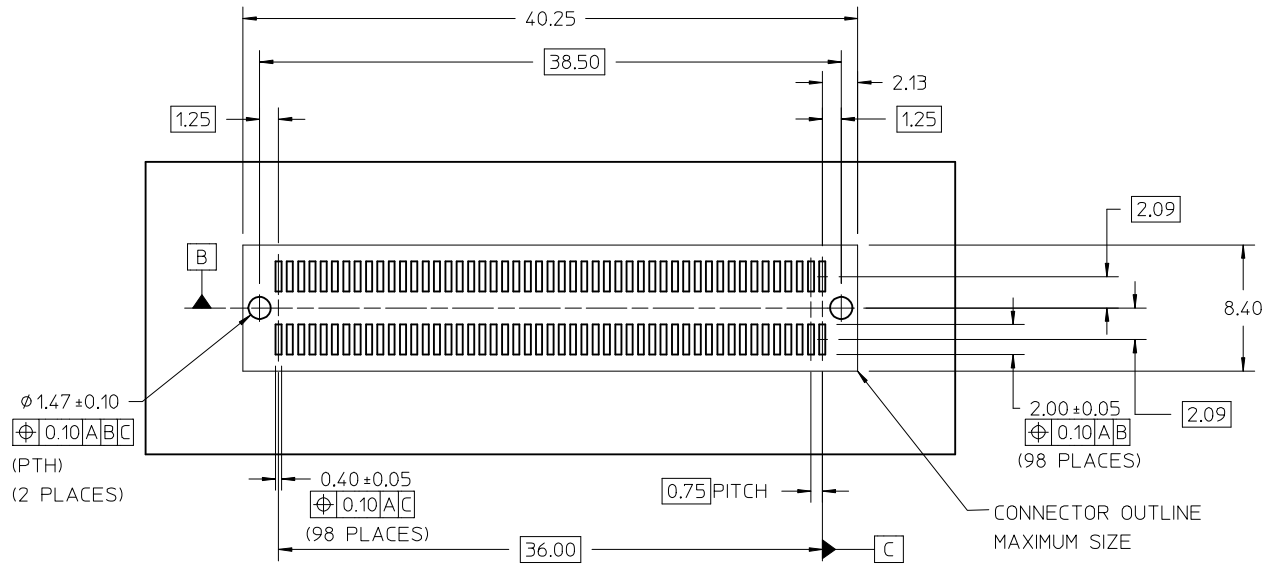

FOOT PRINT NOTES:
 1. DATUM -A- IS THE TOP OF THE PCB

SEE SHEET 1 EC NO: S2015-0846 DRAWN: MHL IONG CHKD: CGTAN APPR: SHLENI	2015/01/28 2015/02/09 2015/02/09	QUALITY SYMBOLS ▽=0 ▽=0 ▽=0	GENERAL TOLERANCES (UNLESS SPECIFIED) <table border="1"> <thead> <tr> <th></th> <th>mm</th> <th>INCH</th> </tr> </thead> <tbody> <tr> <td>4 PLACES</td> <td>± ---</td> <td>± ---</td> </tr> <tr> <td>3 PLACES</td> <td>± ---</td> <td>± ---</td> </tr> <tr> <td>2 PLACES</td> <td>± 0.15</td> <td>± ---</td> </tr> <tr> <td>1 PLACE</td> <td>± 0.25</td> <td>± ---</td> </tr> <tr> <td>0 PLACE</td> <td>± ---</td> <td>± ---</td> </tr> </tbody> </table>		mm	INCH	4 PLACES	± ---	± ---	3 PLACES	± ---	± ---	2 PLACES	± 0.15	± ---	1 PLACE	± 0.25	± ---	0 PLACE	± ---	± ---	DIMENSION STYLE MM ONLY DRAWN BY DATE MHL IONG 2013/11/15 CHECKED BY DATE CGTAN 2014/05/22 APPROVED BY DATE SHLENI 2014/05/30	SCALE 4:1 DESIGN UNITS METRIC THIRD ANGLE PROJECTION	TITLE EDGE LINE+ 98CKTS .062" PCB 0.75MM PITCH SALES DRAWING molex
		mm	INCH																					
	4 PLACES	± ---	± ---																					
	3 PLACES	± ---	± ---																					
2 PLACES	± 0.15	± ---																						
1 PLACE	± 0.25	± ---																						
0 PLACE	± ---	± ---																						
MATERIAL NO. SEE SHEET 1	DOCUMENT NO. SD-151038-0098	SHEET NO. 2 OF 3																						
DRAFT WHERE APPLICABLE MUST REMAIN WITHIN DIMENSIONS			SIZE C	THIS DRAWING CONTAINS INFORMATION THAT IS PROPRIETARY TO MOLEX INCORPORATED AND SHOULD NOT BE USED WITHOUT WRITTEN PERMISSION																				
SEE SHEET 1																								

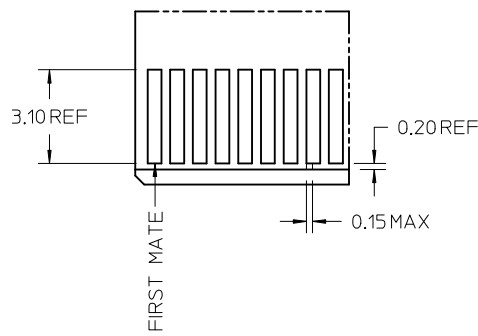
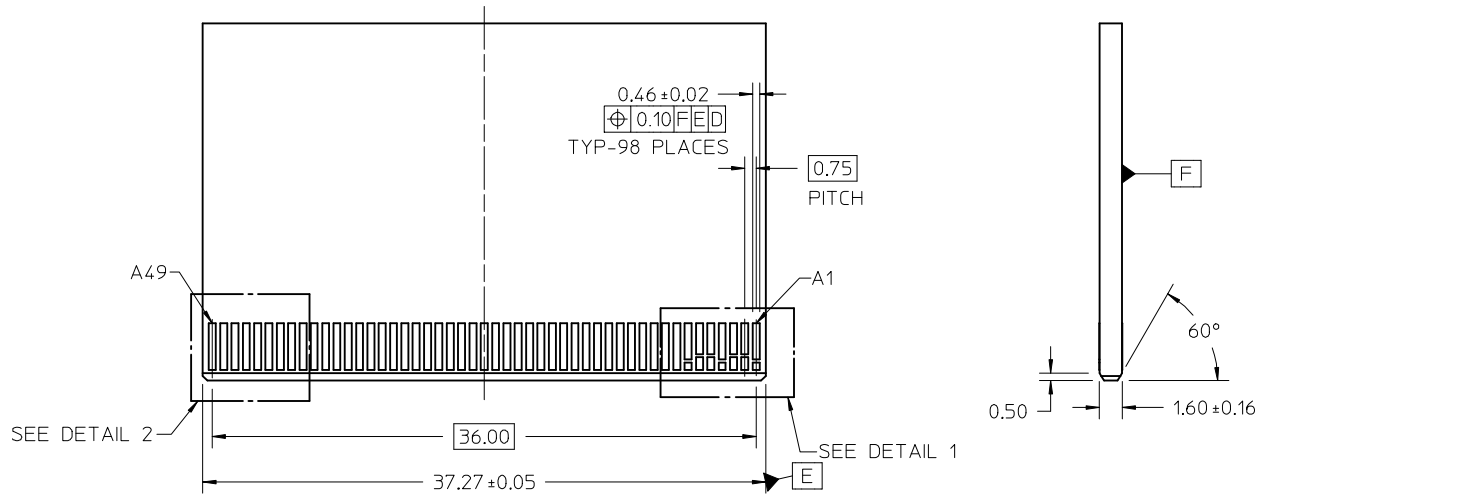

DETAIL 2
RECOMMENDED TIE BAR SIZE

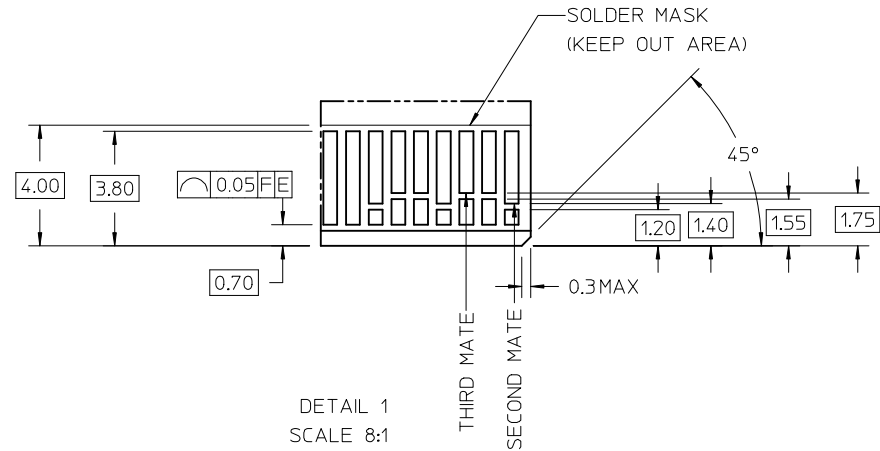

DETAIL 1
SCALE 8:1

NOTE:

1. THESE ARE GENERIC DETAILS THAT DESCRIBES THE CONFIGURATION OF VARIOUS PCB DESIGN ELEMENTS. THE CUSTOMER MUST DETERMINE WHERE AND WHEN TO USE EACH ELEMENT TO ACCOMMODATE THEIR SPECIFIC APPLICATION.
2. CHAMFER ROUGHNESS NOT TO EXCEED 3.17µM.
3. EDGE CARD CHAMFER NOT TO GO THROUGH GOLD PAD.

SEE SHEET 1 EC NO: S2015-0846 DRAWN: MHL LONG CHKD: CGTAN APPR: SHLENI	2015/01/28 2015/02/09 2015/02/09	QUALITY SYMBOLS 	GENERAL TOLERANCES (UNLESS SPECIFIED)		DIMENSION STYLE MM ONLY		SCALE 4:1	DESIGN UNITS METRIC	THIRD ANGLE PROJECTION			
			4 PLACES ± --- ± ---	3 PLACES ± --- ± ---	2 PLACES ± 0.15 ± ---	1 PLACE ± 0.25 ± ---	0 PLACE ± --- ± ---	mm	INCH	DRAWN BY MHL LONG	DATE 2013/11/15	TITLE EDGELINE+ 98CKTS .062" PCB 0.75MM PITCH SALES DRAWING
			ANGULAR ±1/2°			MATERIAL NO.		DOCUMENT NO.		SHEET NO.		
			DRAFT WHERE APPLICABLE MUST REMAIN WITHIN DIMENSIONS			SEE SHEET 1		SD-151038-0098		3 OF 3		
			THIS DRAWING CONTAINS INFORMATION THAT IS PROPRIETARY TO MOLEX INCORPORATED AND SHOULD NOT BE USED WITHOUT WRITTEN PERMISSION									