

REV	ECN.NO:	B Y	DATE
A0	NEW-DWG	SYSTEM	09/08/14

NOTE:
MATERIAL:
HOUSING: PBT+30%GF UL 94V-0
CONTACT: BRASS
SHELL: SPCC
PLATING:
CONTACT: GOLD FLASH AND TIN
OVER NICKEL PLATED
SHELL: NICKEL OVER ALL PLATING
SPECIFICATION:
VOLTAGE RATING: 30V
CURRENT RATING: 1.5A
CONTACT RESISTANCE TERMINAL: 30mΩ MAX
DIELECTRIC WITHSTANDING VOLTAGE: 500V AC
INSULATION RESISTANCE: 1000MΩ MIN
MECHANICAL:
MATING: 35N MAX.
WITHDRAWAL FORCE: 10N MIN
DURALILITY: 1500 CYCLES MIN
ENVIRONMENTAL:
TEMPERATURE RANGE: -20°C ~ +85°C

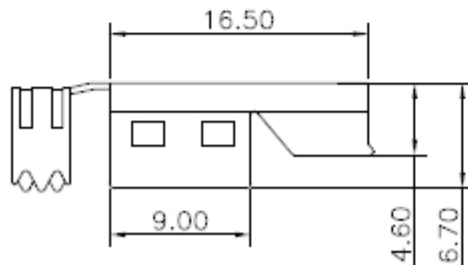
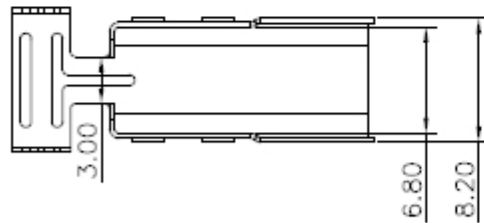
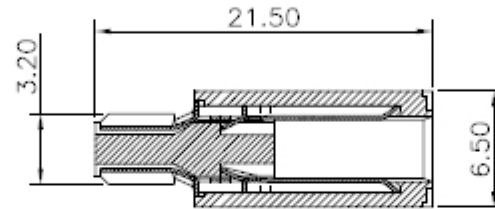
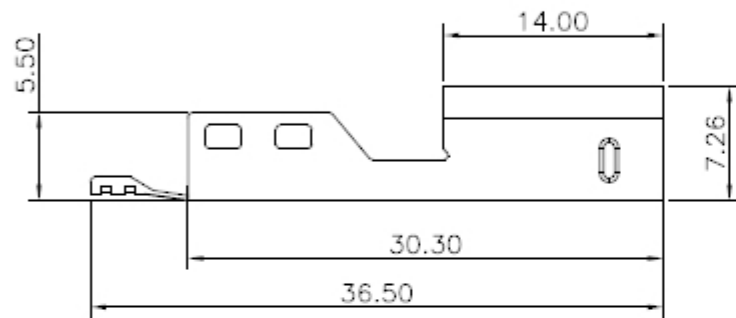
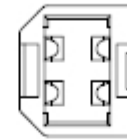
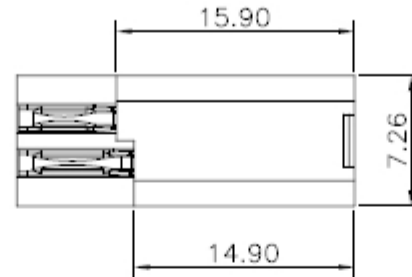
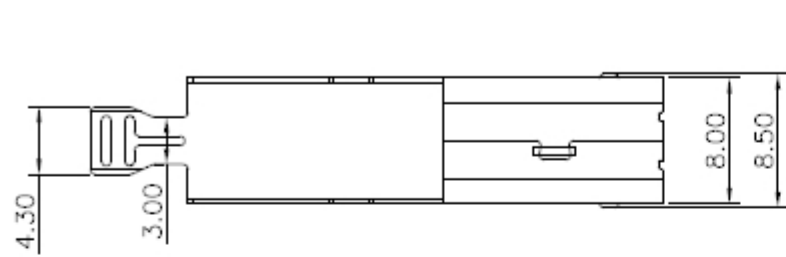

-TOLERANCES- UNLESS OTHERWISE SPECIFIED		CnC Tech,LLC				
X.X ±0.30	X.X' ±3'	APPD:	PRODUCT NO: 1001-029-02300			
X.XX ±0.15	X.XX' ±1'	CHECK:	DATE	SCALE	UNIT	PAGE
X.XXX ±0.10	X.XXX' ±0.5'	DRAW:	2009.08.14	FREE	MM	Z 1