

LOOSE PIECE		TAPE MOUNTED		SPECIFICATIONS						
MATERIAL NUMBER	ENGINEERING NUMBER	MATERIAL NUMBER	ENGINEERING NUMBER	STUD SIZE	"S" ±.005 [0.13]	"W" ±.010 [0.25]	"C" MIN.	"L" MAX.	"H"	STOCK ±.001 [0.025] THICKNESS
190580016	B-801-12HD	---	---	12	.515 [13.08]	.750 [19.05]	.611 [15.52]	1.586 [40.28]	---	.050 [1.27]
---	---	---	---	14	.265 [6.73]					
---	---	---	---	38	.390 [9.91]					
---	---	---	---	56	.328 [8.33]					
190580026	B-801-76HD	---	---	76	.453 [11.51]	.375 [9.53]	.303 [7.70]	1.091 [27.71]	.980 [24.89]	.050 [1.27]
190580037	B-828-06HD	---	---	6	.146 [3.71]					
190580041	B-828-08HD	---	---	8	.173 [4.39]					
190580047	B-828-10HD	190580050	B-828-10HDT	10	.198 [5.03]					
190580055	B-830-10HD	---	---	10	.198 [5.03]	.530 [13.46]	.393 [9.98]	1.258 [31.95]	.980 [24.89]	.050 [1.27]
190580063	B-830-14HD	190580068	B-830-14HDT	14	.265 [6.73]					
190580072	B-830-56HD	190580077	B-830-56HDT	56	.328 [8.33]					
---	---	---	---	4	.119 [3.02]					
---	---	---	---	6	.146 [3.71]	.282 [7.16]	.306 [7.77]	1.047 [26.59]	.980 [24.89]	.050 [1.27]
---	---	---	---	8	.173 [4.39]					
---	---	---	---	10	.198 [5.03]					
190580112	B-840-14HD	---	---	14	.265 [6.73]					
190580117	B-840-38HD	190580119	B-840-38HDT	38	.390 [9.91]	.592 [15.04]	.466 [11.84]	1.362 [34.59]	1.172 [29.77]	.050 [1.27]
190580123	B-840-56HD	---	---	56	.328 [8.33]					

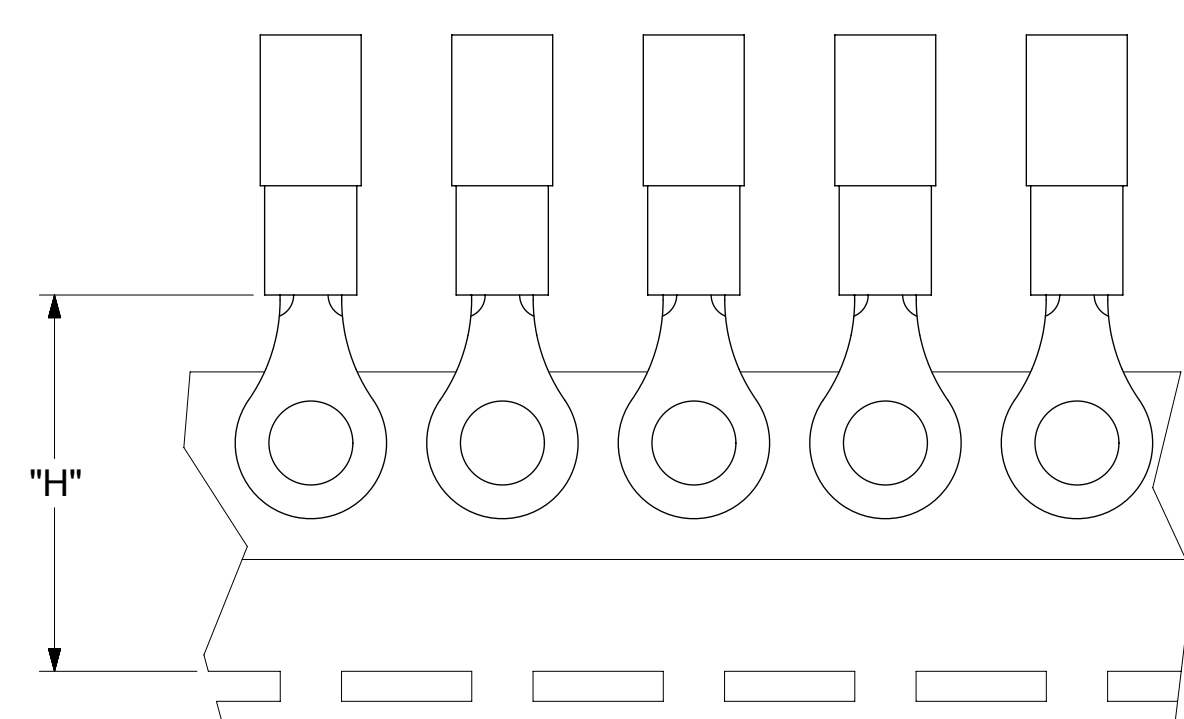
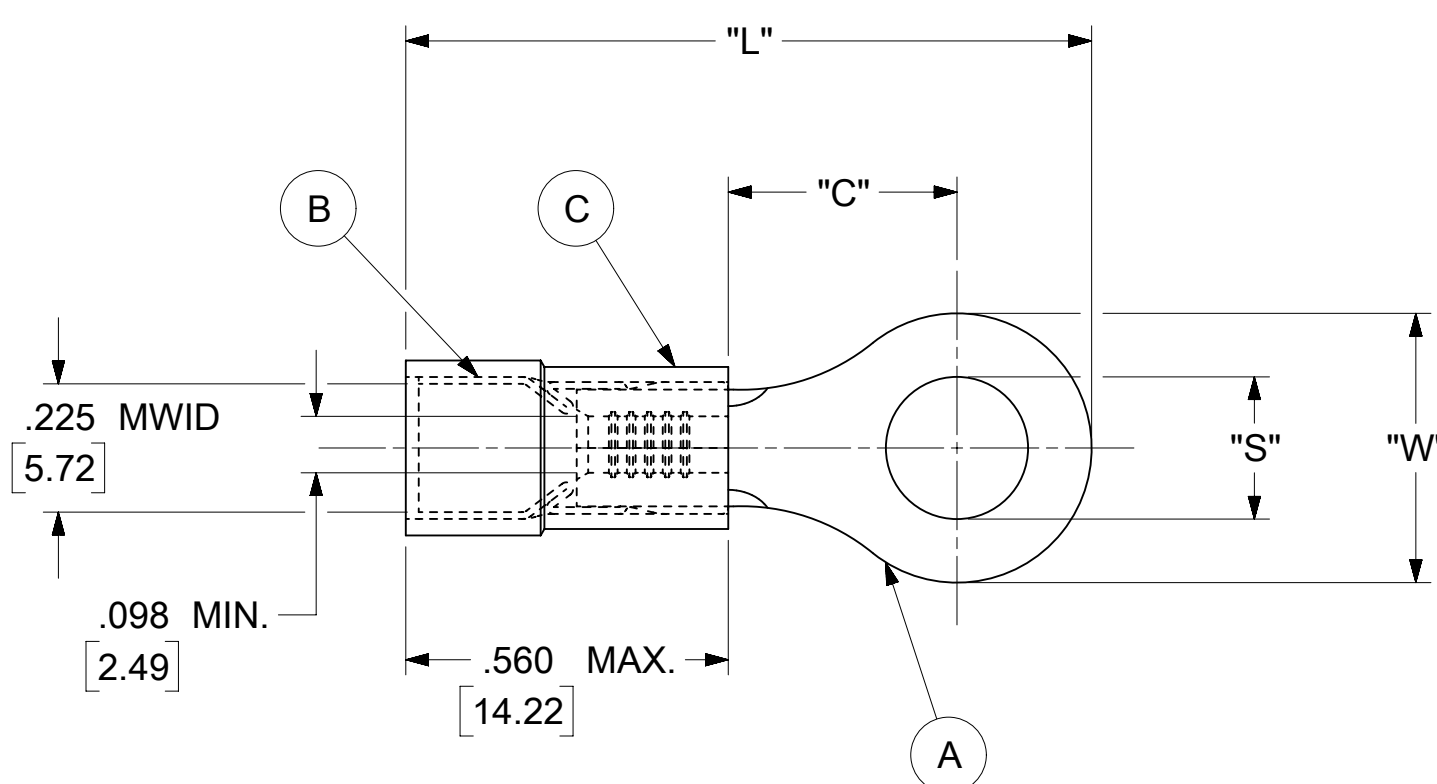

PARTS ON TAPE

- NOTES:
- MATERIAL:
 - (A). RING TONGUE TERMINAL: COPPER PLATING: ELECTRO-TIN (.0003 MIN.)
 - (B). TIN-PLATED BRASS FUNNEL FERRULE
 - (C). INSULATION: NYLON (YELLOW)
 - MWID: MAXIMUM WIRE INSULATION DIAMETER
 - WIRE SIZE: 16 -14 AWG
1.0 -2.5 MM²
 - "UL" LISTING #E32244
"CSA" LISTING #18689
 - ALL DIMENSIONS IN INCHES/[MM].
 - PARTS ARE ROHS COMPLIANT.
 - DIMS. SHOWN ARE FOR REFERENCE ONLY.

SYMBOLS	THIS DRAWING CONTAINS INFORMATION THAT IS PROPRIETARY TO MOLEX ELECTRONIC TECHNOLOGIES, LLC AND SHOULD NOT BE USED WITHOUT WRITTEN PERMISSION			
	DIMENSION UNITS	SCALE		CURRENT REV DESC: MIGRATION TO ECTR/NX
▽ = 0	INCH/MM	NTS		EC NO: 619818 DRWN: ABENJAMINLW 2019/06/18 CHK'D: GROJAS01 2019/06/27 APPR: JMACNEIL 2019/07/10
▽ = 0	GENERAL TOLERANCES (UNLESS SPECIFIED)			
▽ = 0		MM	INCH	INITIAL REVISION: DRWN: JJ 1984/11/29 APPR: JMACNEIL 2019/07/10
▽ = 0	4 PLACES	±	±	
▽ = 0	3 PLACES	±	± 0.005	SERIES 19058
▽ = 0	2 PLACES	± 0.13	± 0.01	
▽ = 0	1 PLACE	± 0.25	±	MATERIAL NUMBER SEE TABLE
▽ = 0	0 PLACES	±	±	
▽ = 0	ANGULAR TOL	± 0.5 °		CUSTOMER GENERAL MARKET
▽ = 0	DRAFT WHERE APPLICABLE MUST REMAIN WITHIN DIMENSIONS			
▽ = 0	THIRD ANGLE PROJECTION		DRAWING	SHEET NUMBER 1 OF 1



RING TONGUE HEAVY
DUTY TERMINAL AVIKRIMP 800-SERIES

PRODUCT CUSTOMER DRAWING

DOCUMENT NUMBER	DOC TYPE	DOC PART	REVISION
190580016	PSD	000	A

MATERIAL NUMBER	ENGINEERING NUMBER	STUD SIZE	MAX "S"	"MWID"	MAX "L"	INSULATION MAT.	PACKAGING
190580058	B-830-10HDRR	1Ø	.214	.245	1.36	YEL, NYLON W/3 BLK STRIPES	LOOSE PIECE
190580066	B-830-14HDRR	*	.278	.245	1.36	YEL, PVC W/3 BLK STRIPES	
190580075	B-830-56HDRR	*	.340	.245	1.36	YEL, NYLON W/3 BLK STRIPES	
190580059	B-830-10HDRRT	1Ø	.214	.245	1.36	YEL, NYLON W/3 BLK STRIPES	TAPE MOUNTED (C1)
190580067	B-830-14HDRRT	*	.278	.245	1.36	YEL, PVC W/3 BLK STRIPES	
190580076	B-830-56HDRRT	*	.340	.245	1.36	YEL, NYLON W/3 BLK STRIPES	

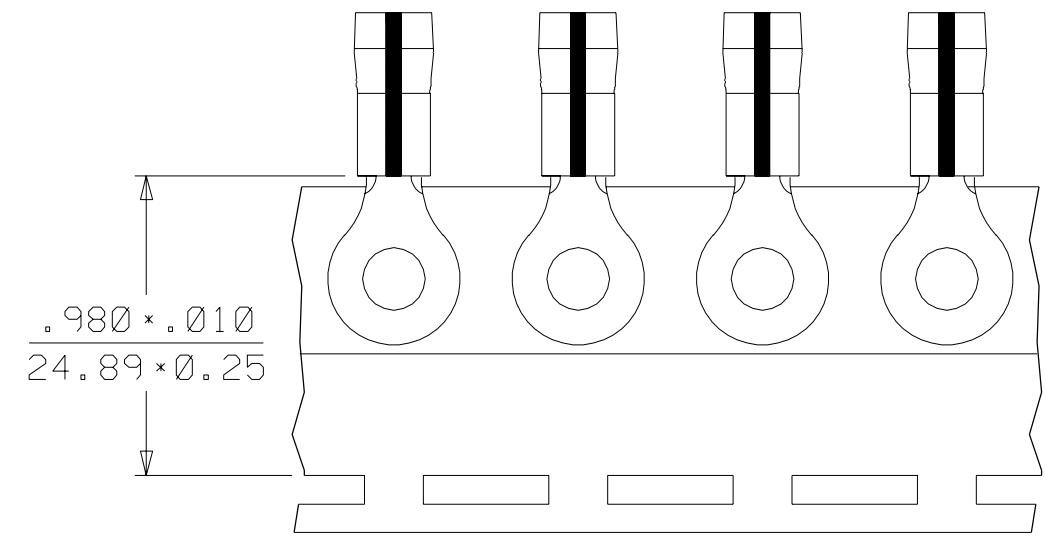
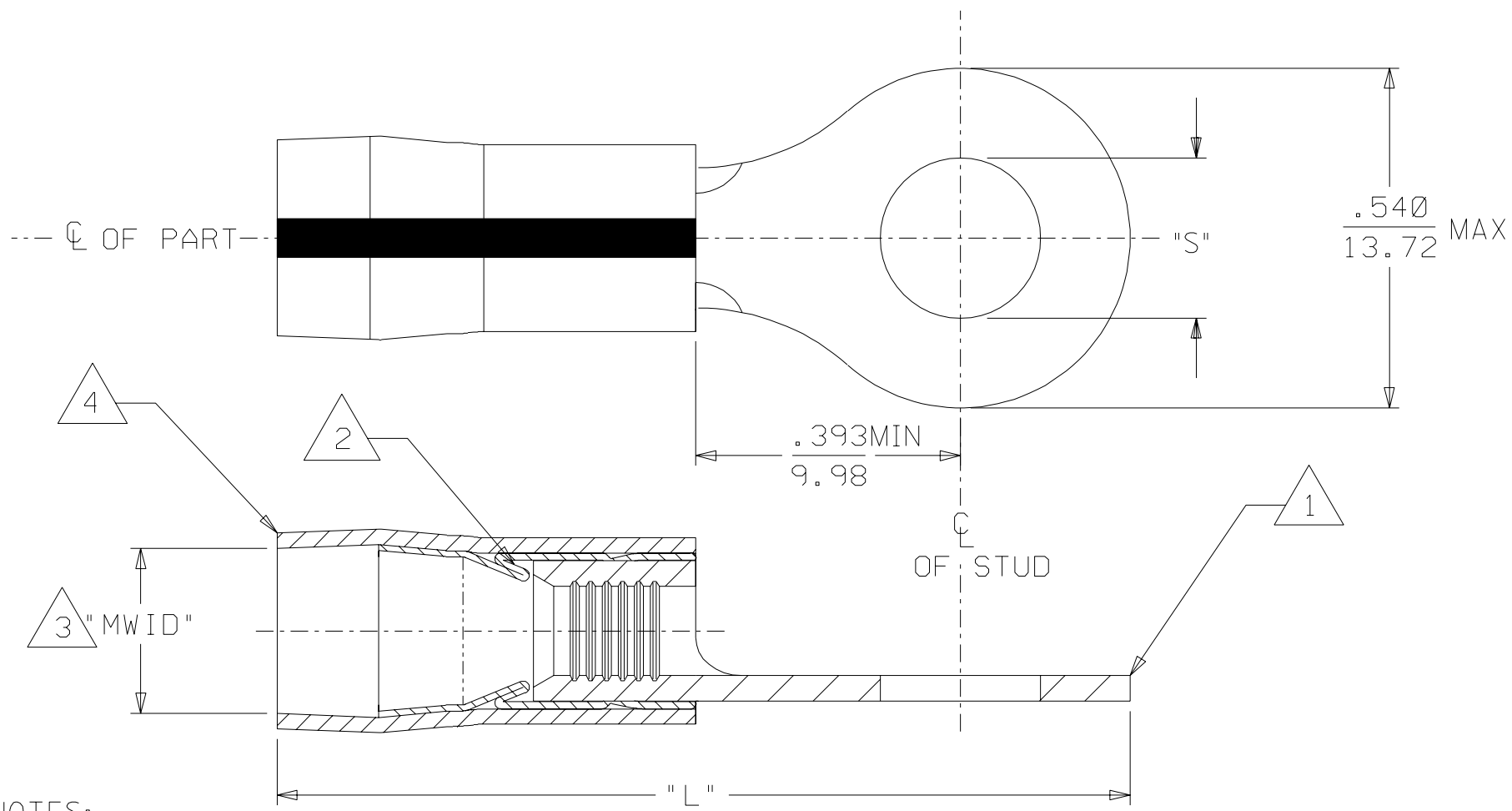

TAPE MOUNTING LOCATION

SALES DRAWING

- NOTES:
- 1. TERMINAL MATERIAL: BRASS
FINISH: ELECTRO-TIN
 - 2. FERRULE MATERIAL: BRASS
FINISH: ELECTRO-TIN.
 - 3. "MWID" = MAXIMUM WIRE INSULATION DIAMETER.
 - 4. INSULATION MATERIAL SEE CHART.

MATERIAL CHG	DESCRIPTION	QUALITY SYMBOLS
EC NO. ETC2002-0256		MAJOR = 0
DRWN: BRE		CRITICAL = 0
CHK: HEB		
APPR: RWD		
CI	REV	

GENERAL TOLERANCES: (UNLESS SPECIFIED)	
4 PLACES	±0. ±.
3 PLACES	±0. ±.005
2 PLACES	±0.13 ±.01
1 PLACE	±0.25 ±.
ANGULAR: ± 2°	
DRAFT WHERE APPLICABLE MUST REMAIN WITHIN DIMENSIONS	

SCALE	DESIGN UNITS
NO: NE	<input type="checkbox"/> mm <input checked="" type="checkbox"/> INCH
DRAWN BY & DATE	BRE 01/12/20
CHECKED BY & DATE	HEB 01/12/20
APPROVED BY & DATE	RWD 01/12/20
CAD FILENAME	SD-19058-005.DGN

DIMENSIONS:		SHT	REV
<input type="checkbox"/> mm	<input checked="" type="checkbox"/> INCH		
<input type="checkbox"/> mm ONLY			REVISE ON CAD ONLY
THIRD ANGLE PROJECTION			
TITLE: AVIKRIMP RAILROAD RING TONGUE TERMINALS 16-14 AWG			
MOLEX INCORPORATED			
MATERIAL NO.	DRAWING NO.	SHEET NO.	
SEE CHART	SD-19058-005	1 OF 1	
THIS DRAWING CONTAINS INFORMATION THAT IS PROPRIETARY TO MOLEX INCORPORATED AND SHOULD NOT BE USED WITHOUT WRITTEN PERMISSION.			SIZE B