

LOC	DIST	REVISIONS					
		P	LTR	DESCRIPTION	DATE	DWN	APVD
-	-		A	INITIAL REVISION	27OCT11	LS	GS

MICRO-MATCH

Ausführung:
Workmanship:

- Leichte Handhabung / Easy handling
- Linearer Hub / Straight action principle
- Entriegelbare Zwangssperre / Ratchet release
- Einfache Druckjustage mit Zahnarretierung / Simple pressure adjustment with locking device
- Vorschubeinheit mit Trennvorrichtung / Feeding and cutting device
- Präzise geschliffene Profile / Precisely ground profiles
- Ergonomisch geformte Soft-Handgriffe
Farbe: Signalgelb (ähnl. RAL 1003)
Ergonomically formed soft-grips
Colour: yellow (similar RAL 1003)
- Voll recyclefähig;
RoHS(Richtlinie.2002/95/EG) konform
Fully recyclable;
RoHS(Directive.2002/95/EG) compliant

Following documentation are enclosed /
folgende Dokumentation werden beigelegt
(english and german)

- operating instruction sheet
Bedienungsanleitung

INSTRUCTION SHEET /
BEDIENUNGSANLEITUNG

TE- P/N 744012-3

Abmessungen:

Dimensions:

- Länge: ca. 230 mm
Length: approx. 230 mm
- Breite: ca. 170 mm
Width: approx. 170 mm
- Gewicht: ca. 685 g
Weight: approx. 685 g

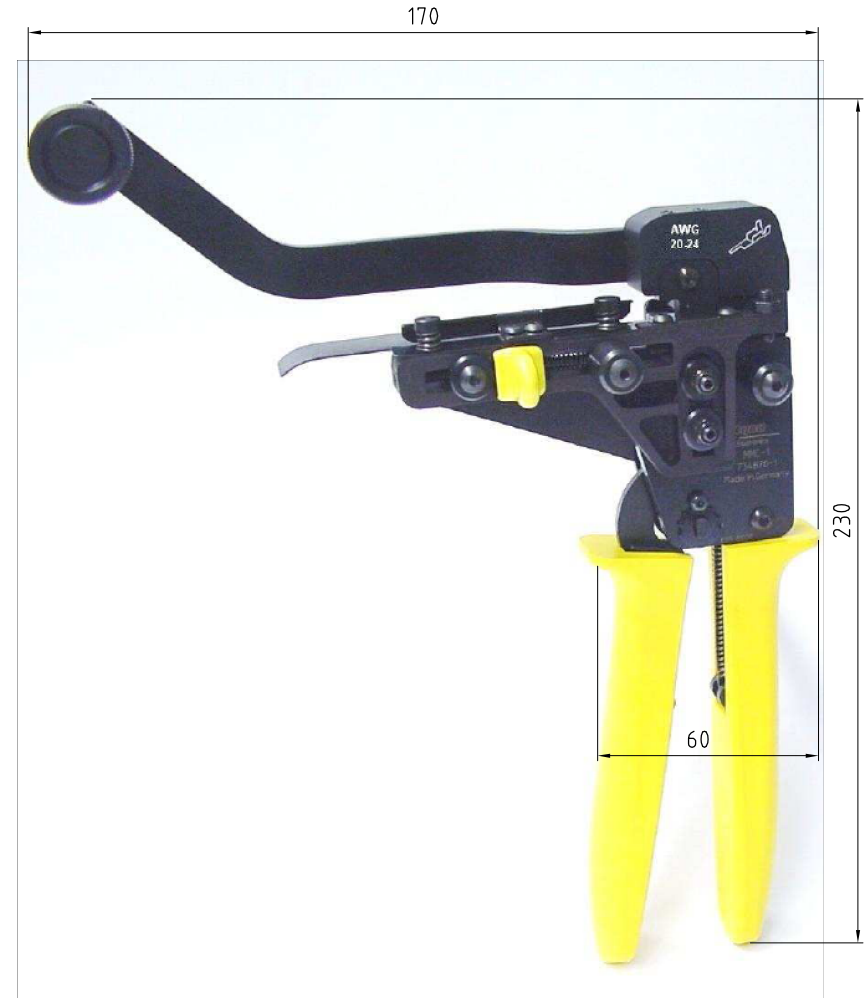

APPLICATION SPECIFICATION /
Verarbeitungsspezifikation:

114-19051

PROCESSABLE TE CONTACTS /
Verarbeitbare TE Kontakte:

Micro Match Cosi

TE-P/N 1-338097-1

AWG 20-24

THIS DRAWING IS A CONTROLLED DOCUMENT.

DIMENSIONS:
mm

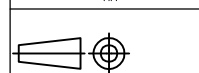

MATERIAL FINISH

TOLERANCES UNLESS OTHERWISE SPECIFIED:

0 PLC	± -
1 PLC	± -
2 PLC	± -
3 PLC	± -
4 PLC	± -
ANGLES	± -

DWN	L. Sandhu	27OCT11
CHK	G. Stegmayer	27OCT11
APVD	G. Stegmayer	27OCT11
PRODUCT SPEC	-	
APPLICATION SPEC	-	
WEIGHT	0.685kg	



NAME
**CRIMP HAND TOOL,
MICRO-MATCH COSI, AWG 20-24**

SIZE	CAGE CODE	DRAWING NO	RESTRICTED TO
A3	00779	©= 734870-1	-

CUSTOMER DRAWING	SCALE	SHEET	1 OF 1	REV	A
------------------	-------	-------	--------	-----	---