

## MPLCH0520LR33

Aliases (UPIF0520LR3300)

Not for New Design

KEMET, MPLCH, Power, 0.33 uH, 20%, 2220

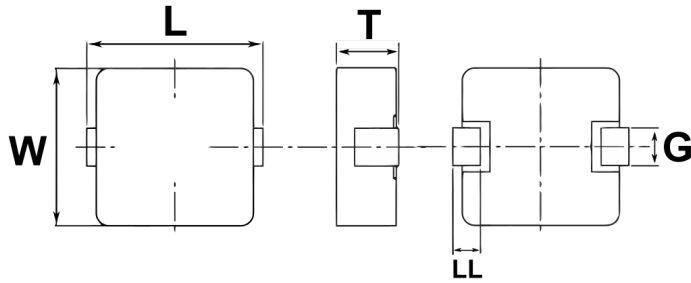

Click [here](#) for the 3D model.

### Dimensions

L	5.5mm MAX
W	5mm +/-0.2mm
T	2mm MAX
LL	1.1mm NOM
G	2.5mm +/-0.2mm

### Packaging Specifications

Packaging	T&R, 380mm
Packaging Quantity	5000

### General Information

Series	MPLCH
Style	SMD
Chip Size	2220
Description	Shielded, Surface Mount Inductor
Features	Large Current Inductors
RoHS	Yes
Core	Composite
Miscellaneous	40 (K) Temperature Rise Max.

### Specifications

Inductance	0.33 uH
Inductance Tolerance	20%
Temperature Range	-40/+125°C
Shielded	Yes
Current	14 A (Isat, 30% Drop In Inductance), 9.1 A (Irms, 40C Rise By Self Heating)
DC Resistance	6.8 mOhms

Statements of suitability for certain applications are based on our knowledge of typical operating conditions for such applications, but are not intended to constitute - and we specifically disclaim - any warranty concerning suitability for a specific customer application or use. This information is intended for use only by customers who have the requisite experience and capability to determine the correct products for their application. Any technical advice inferred from this information or otherwise provided by us with reference to the use of our products is given gratis, and we assume no obligation or liability for the advice given or results obtained.