

DO NOT SCALE FROM THIS PRINT

NOTES:

1. Ⓢ REPRESENTS A CRITICAL DIMENSION.
2. MAXIMUM BURR ALLOWANCE: .0015[0.038]
3. LATCH RETENTION FORCE: 1.000LB[4.45N]
4. POSITIONS 2 THRU 5 TO BE BULK PACKAGED, ALL OTHER POSITIONS TO BE TUBED.

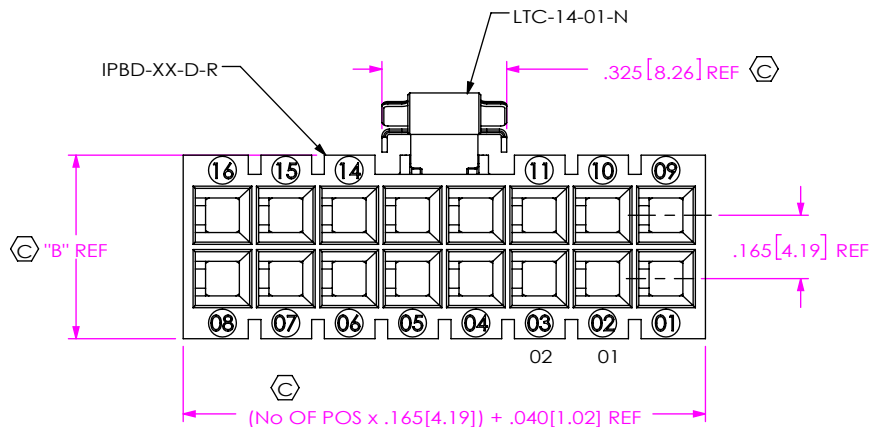
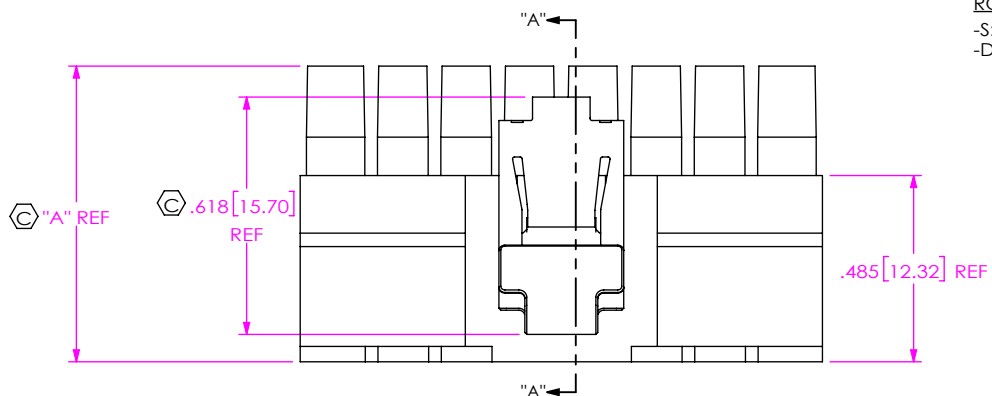

FIG 1
(IPBD-08-D-M SHOWN)

IPBD-XX-X-X-X

**No OF POSITIONS
-02 THRU -15 (PER ROW)

ROW SPECIFICATION

-S: SINGLE
-D: DOUBLE

LATCH OPTION
-M: METAL LATCH (SEE FIG 1)
(LEAVE BLANK FOR PLASTIC LATCH, SEE FIG 4, SHT 2)

OPTION
*-K: KEYED POLARIZATION
(SEE FIG 3, SHT 2)

*(LEAVE BLANK FOR NO POLARIZATION. SAMTEC WILL ONLY SUPPORT EXISTING BUSINESS AS OF REV C)

(** = -11 THRU -15 POSITIONS AVAILABLE ON -D ONLY)

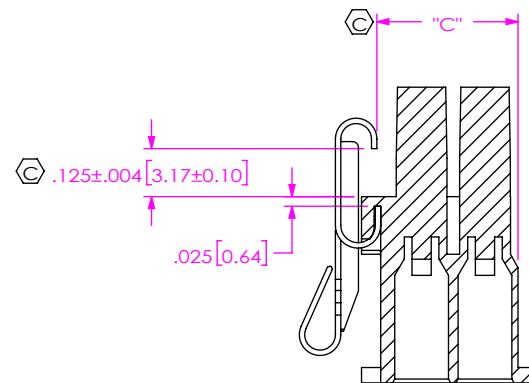
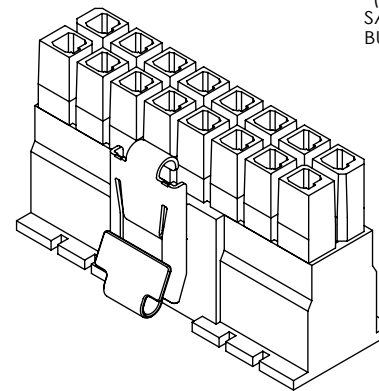

SECTION "A"- "A"

TABLE 1

ROW SPECS	"A"	"B"	"C"	"D"	"E"
-S	.770 [19.56]	.313 [7.95]	$.223^{+.012}_{-.008} [5.66^{+.030}_{-.020}]$.223 [5.66]	.413 [10.49]
-D	.773 [19.63]	.478 [12.14]	$.368 \pm .008 [9.35 \pm .020]$.362 [9.19]	.578 [14.68]

UNLESS OTHERWISE SPECIFIED, DIMENSIONS ARE IN INCHES.

TOLERANCES ARE:

DECIMALS ANGLES
.XX: $\pm .01 [0.3]$ 2°
.XXX: $\pm .005 [0.13]$
.XXXX: $\pm .0020 [0.051]$

PROPRIETARY NOTE
THIS DOCUMENT CONTAINS CONFIDENTIAL AND PROPRIETARY INFORMATION AND ALL DESIGN, MANUFACTURING, REPRODUCTION, USE, PATENT RIGHTS AND SALES RIGHTS ARE EXPRESSLY RESERVED BY SAMTEC, INC. THIS DOCUMENT SHALL NOT BE DISCLOSED, IN WHOLE OR PART, TO ANY UNAUTHORIZED PERSON OR ENTITY NOR REPRODUCED, TRANSFERRED OR INCORPORATED IN ANY OTHER PROJECT IN ANY MANNER WITHOUT THE EXPRESS WRITTEN CONSENT OF SAMTEC, INC.



520 PARK EAST BLVD, NEW ALBANY, IN 47150
PHONE: 812-944-6733 FAX: 812-948-5047
e-Mail: info@SAMTEC.com code: 55322

MATERIAL: DO NOT SCALE DRAWING
INSULATOR: NYLON 103 FHS UL 94 V2
LATCH: NICKEL-PLATED BeCu

SHEET SCALE: 2:1

DESCRIPTION:
.165[4.19] DISCRETE WIRE INSULATOR & LATCH ASM
DWG. NO.

IPBD-XX-X-X-X

BY: T NEWTON 03/20/2008 SHEET 1 OF 2

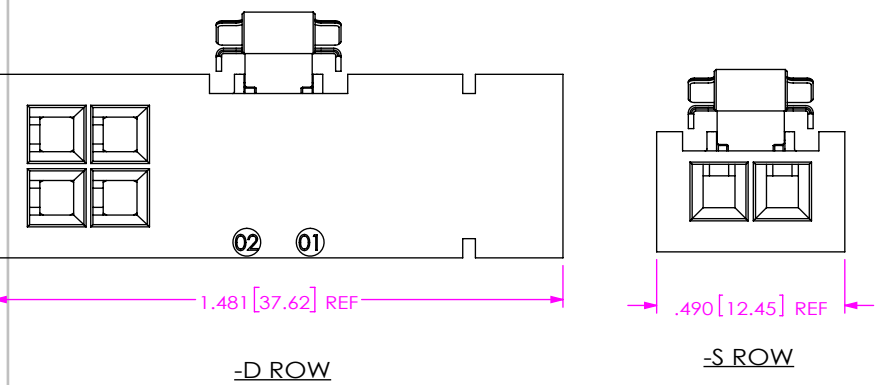

FIG 2
(IPBD-02-X-M SHOWN)
(SAME AS FIG 1, DIFFERENT AS SHOWN)

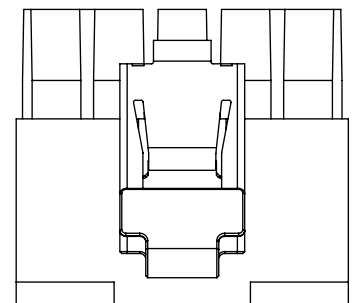
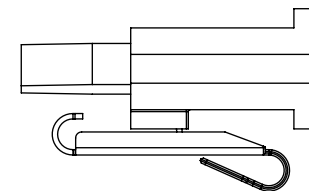
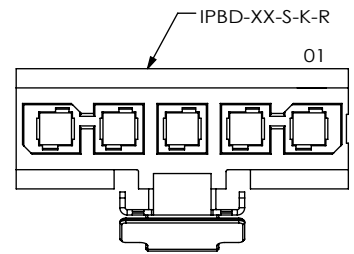

FIG 3
(IPBD-05-S-K-M SHOWN)
(SAME AS FIG 1, DIFFERENT AS SHOWN)

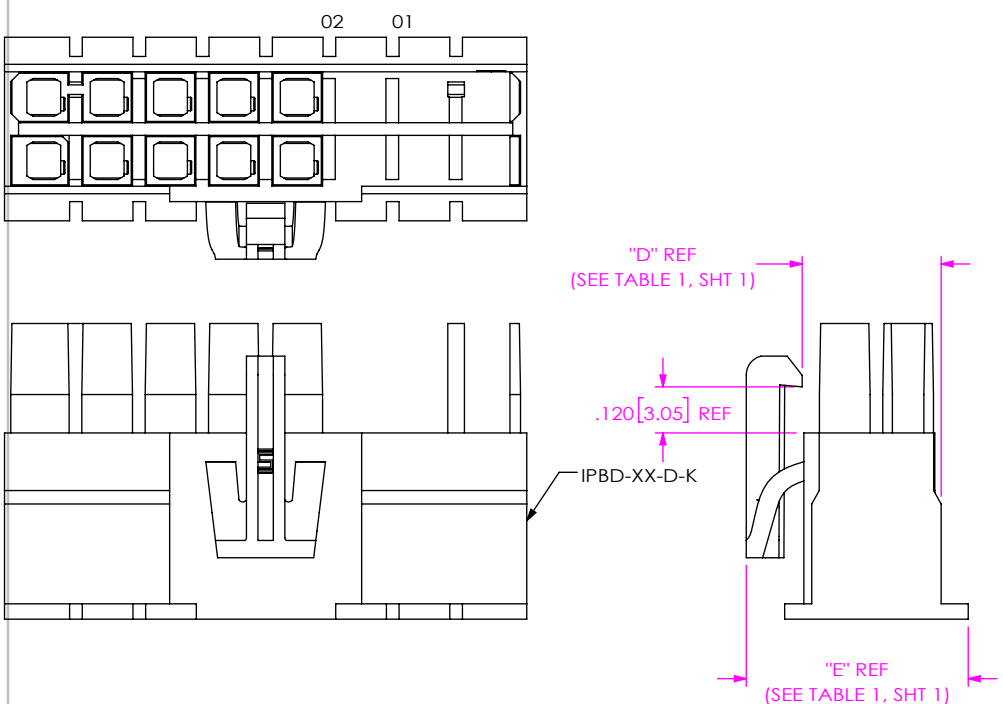
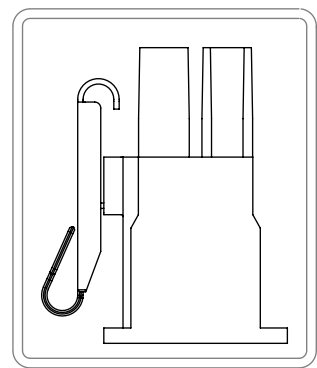
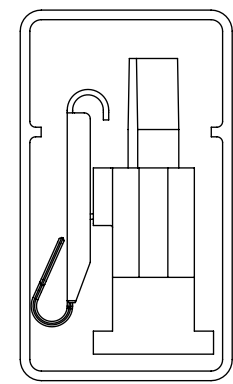

FIG 4
(IPBD-05-D-K SHOWN)
(SAME AS FIG 1, DIFFERENT AS SHOWN)



-D ROW
TUBE: PT-1-24-03-56
PLUG: TP-04



-S ROW
TUBE: PT-1-24-02-74
PLUG: TP-25

PACKAGING VIEW
(SEE NOTE 4)

PROPRIETARY NOTE
THIS DOCUMENT CONTAINS CONFIDENTIAL AND PROPRIETARY INFORMATION AND ALL DESIGN, MANUFACTURING, REPRODUCTION, USE, PATENT RIGHTS AND SALES RIGHTS ARE EXPRESSLY RESERVED BY SAMTEC, INC. THIS DOCUMENT SHALL NOT BE DISCLOSED, IN WHOLE OR PART, TO ANY UNAUTHORIZED PERSON OR ENTITY NOR REPRODUCED, TRANSFERRED OR INCORPORATED IN ANY OTHER PROJECT IN ANY MANNER WITHOUT THE EXPRESS WRITTEN CONSENT OF SAMTEC, INC.

DO NOT SCALE DRAWING

SHEET SCALE: 2:1



520 PARK EAST BLVD, NEW ALBANY, IN 47150
PHONE: 812-944-6733 FAX: 812-948-5047
e-Mail: info@SAMTEC.com code: 55322

DESCRIPTION:
.165[4.19] DISCRETE WIRE INSULATOR & LATCH ASM

DWG. NO.

IPBD-XX-X-X-X

BY: T NEWTON 03/20/2008 SHEET 2 OF 2