

Material and Finish

Insulator: PBT Thermoplastic with Glass-fiber Reinforcement, UL 94V-0 Rated, Color: Black

Shell: Steel, Nickel Plated

Contact Material: Plug - Brass

Contact Plating Options:

Standard: Gold Flash on Mating End, Tin on Termination End, Nickel Underplate on Entire Contact

15 Option: 15u" Gold on Mating End, Tin on Termination End, Nickel Underplate on Entire Contact

30 Option: 30u" Gold on Mating End, Tin on Termination End, Nickel Underplate on Entire Contact

Electrical Specifications

Rated Current: 2A
 Rated Voltage: 30V RMS
 Insulation Resistance: 1000 Megohms Min. at 500V DC
 Contact Resistance: 13 milliohms Max.
 Dielectric Withstanding Voltage: 1000V for 1 Minute

Mechanical Specifications

Operating Temperature: -55°C to +105°C

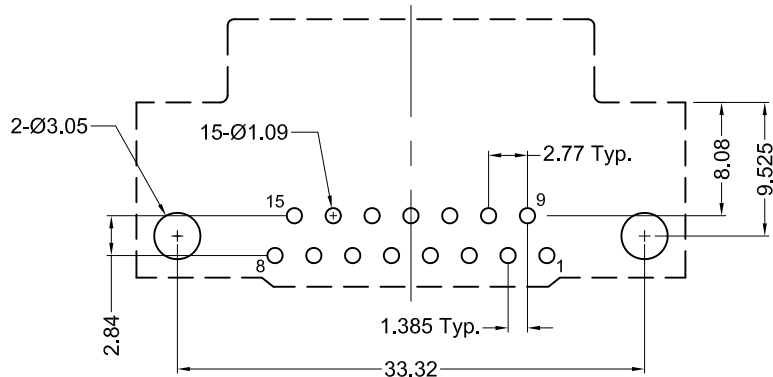
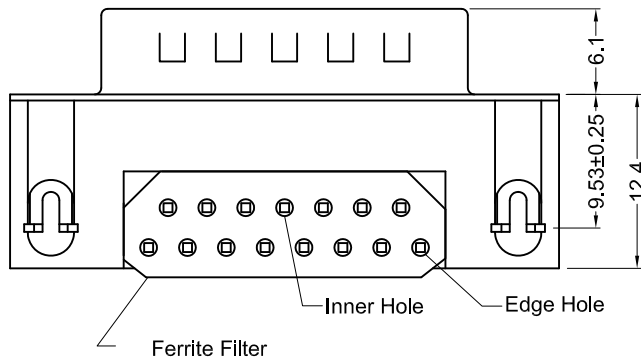

Recommended PCB Layout (Top View)

| Ferrite Specifications | | |
|------------------------|------------|------------|
| Test Frequency | Edge Hole | Inner Hole |
| 30 Mhz | 17-27 Ohms | 22-30 Ohms |
| 50 Mhz | 22-30 Ohms | 29-37 Ohms |
| 100 Mhz | 29-34 Ohms | 35-40 Ohms |

| Part Number | Contact Area Plating Finish |
|----------------|-----------------------------|
| KF22X-A15P-N | Gold Flash (Standard) |
| KF22X-A15P-N15 | 15u" Gold (15 Option) |
| KF22X-A15P-N30 | 30u" Gold (30 Option) |



| Tolerances |
|-------------------------|
| X.X ± 0.25 |
| X.XX ± 0.15 |
| Unless Stated Otherwise |

| REV. | DATE | DESCRIPTION | REV. BY | CHK. BY | DRAWN BY | DATE |
|------|----------|-------------|------------|-------------|------------|----------|
| A1 | 02/10/06 | New Drawing | R. Aguirre | H. MA | R. Aguirre | 10/07/05 |
| A2 | 02/21/08 | ECO #07-049 | S. Vien | H. MA | | |
| A3 | 08/07/13 | ECO #12-018 | S. Vien | P. DalCanto | | |
| A4 | 12/31/17 | ECO #17-027 | J. Elbanna | C. Furumasa | | |

KF22X-A15P-N

Right Angle, Ferrite D-Sub, RoHS Compliant

15 Position, Male, 0.318" Footprint

