



905 MHz Ceramic Bandpass Filter

Part Number: AM905B1549

ANATECH ELECTRONICS INC
RF & Microwave Filters & Products



Electrical specifications

- Center Frequency:** 905 MHz
- 1dB Bandwidth:** 110 MHz
- VSWR:** 1.5 : 1
- Insertion Loss (F0):** 1.5 dB max
- Ripple:** 1.0 dB max
- Input / Output Impedance:** 50 Ohms
- Rejection:** 30dB min at 500MHz
- Rejection 2:** 20dB min at 1040MHz ~ 2000MHz
- Power Handling:** 20 dBm

Mechanical

- Mounting Method:** SMT
- Dimensions:** 14 x 13 x 4.5 mm

Environmental

- Operating Temperature:** -40 to +70 deg. C
- Storage Temperature:** -55 to +85 deg. C

This product is RoHs compliant.

Outline Drawing:

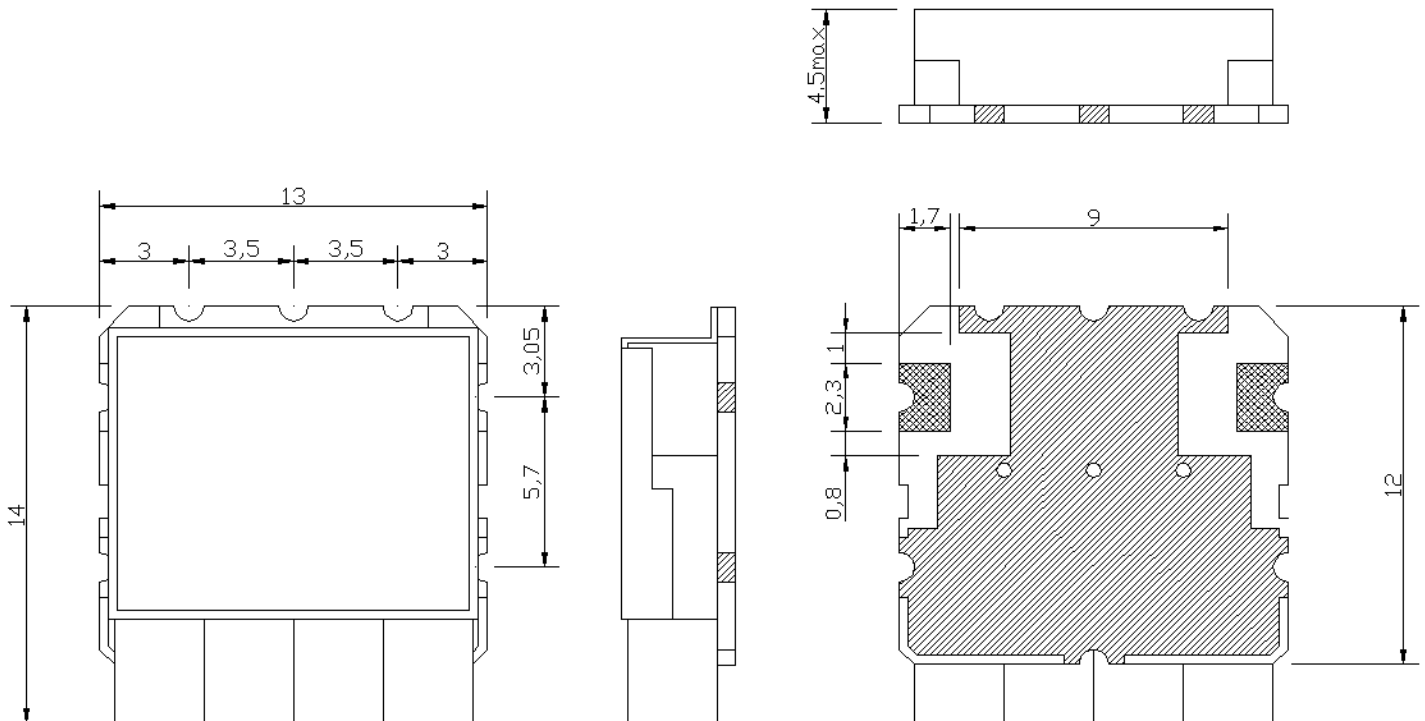

Unit:mm
Tolerance:±0.3