

- 1
- 2
- 3
- 4
- 5
- 6
- 7
- 8
- 9
- 10
- 11
- 12
- 13
- 14
- 15
- 16
- 17
- 18

COVERING

Injected polyurethane, hardness 55 Shore D.

WHEEL CENTRE BODY

Polyamide based (PA) technopolymer.

ROLLING ACTION

Hub with pass-through hole.

APPLICATIONS

Castors for the general public, excellent rolling resistance and elasticity features, high wear and tearing resistance.

For selection parameters see Technical data (on page 1295).

RE.C6 wheels are also supplied with steel sheet bracket RE.C6-C (see page 1273).

ENVIRONMENTAL CONDITIONS

Suitable for use in industrial and institutional environments, even in the presence of moisture and chemical agents.

The good resistance to frequent cleaning cycles makes it suitable for environments where it is necessary to ensure hygiene.

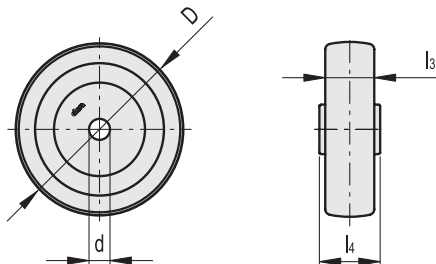

Conversion Table	
1 mm = 0.039 inch	
D	
mm	inch
40	1.56
50	1.95
60	2.34

METRIC

Code	Description	D	d	l3	l4	Dynamic carrying capacity# [N]	⚖️
452376	RE.C6-040-RBL	40	8	18	21	400	20
452381	RE.C6-050-RBL	50	8	18	22	550	20
452386	RE.C6-060-RBL	60	8	25	28	700	60