

REV.	SPECIFICATION	ECN NO.	APPD.

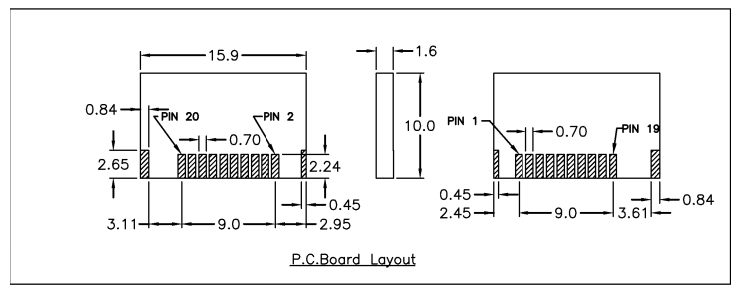
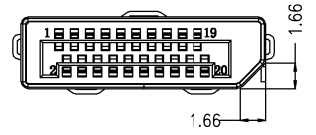
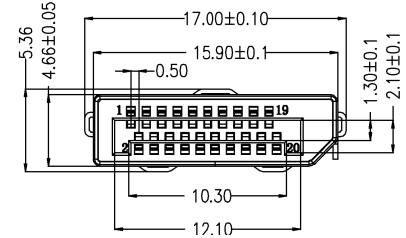
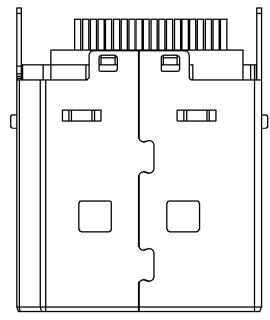
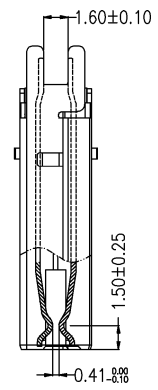
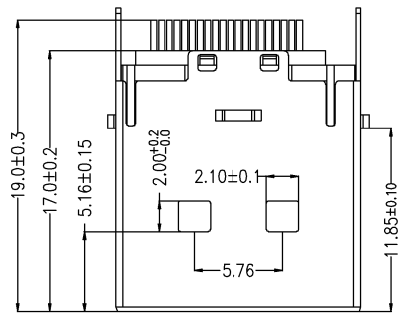
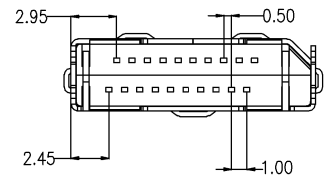

**Material:**

Housing: LCP, UL94V-0, Black.  
 Contacts: Brass, Gold Plated on Contact Area and Tin Plated on Solder tail over 50u" Nickel.  
 Shell: SPCC, 80u" Cu Plated over 100u" Nickel Plated.

**CONTACT INSERTION AND WITHDRAW FORCE**

Insertion Force: 44.1N max.  
 Withdrawal Force: 9.8N min/39.2N max.

**Electrical Characteristics:**

Current Rating: 0.5 AMP.  
 Voltage Rating: 40V.  
 Dielectric Withstanding Voltage: AC 500V.  
 Insulation Resistance: 100MΩ min.  
 Contact Resistance: 60mΩ max.  
 Operating Temperature: -25°C~+85°C.

**\*RoHS Compliant**

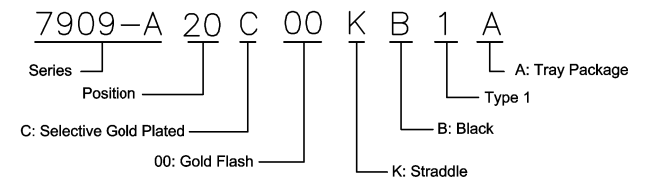

Tolerances	Drawn No.	7909D02010		Title:	7909-A Series
x. = ±0.35	Projection	⊕ ⊖			Displayport Plug 20P
.x = ±0.30	Unit	mm	Scale	1:N	Straddle Mount
.xx = ±0.25	Drawn By	Emma 09/21'20		⊙677	
.xxx = ±0.20					

<b>OUPIN</b>			
OUPIN ELECTRONIC(KUNSHAN) CO., LTD.			
P/N: 7909-A20C00KB1A			
SHEET	1/1	Ver.No.	A1