

NOTES:
 MATERIAL: CONTACTS: PHOSPHOR BRONZE
 INSULATOR: PBT+30% GLASS UL 94V-0
 ELECTRICAL:
 CONTACT CURRENT PATING: 1A
 DIELECTRIC WITHSTANDING VOLTAGE: 1000V AC
 CONTACT RESISTANCE: 20 milliohms max
 INSULATION RESISTANCE: 1000 MEGOHMS
 CAPACITANCE: 0.5 PICO-FARAD MAXIMUM
 TEMPERATURE RANGE: -40°C+105°C
 MECHANICAL:
 ENGAGING FORCE: 340g/A CONTACT MAX.
 SEPARATING FORCE: 20g/A CONTACT MIN.
 DURABILITY: 50 CYCLES
 NO. OF CONTACT: 6-48
 FINISH:
 CONTACT PLATING: TIN PLATED 6C.03U"-88.35U"

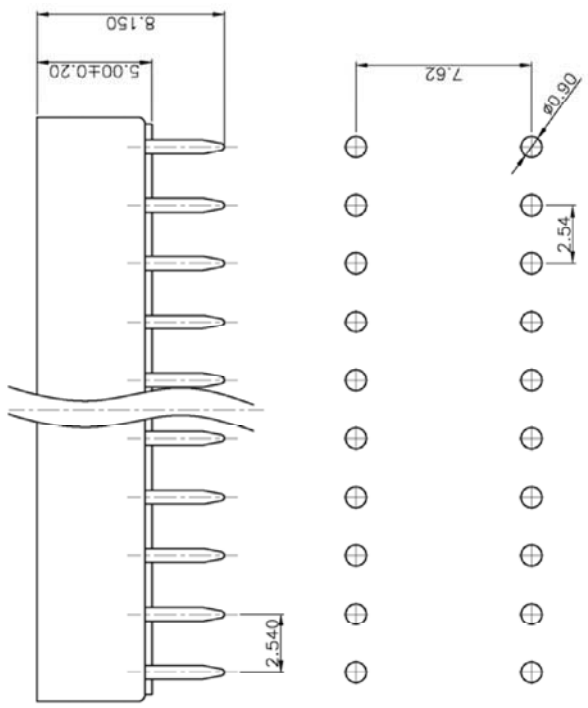
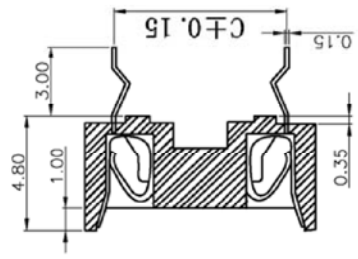
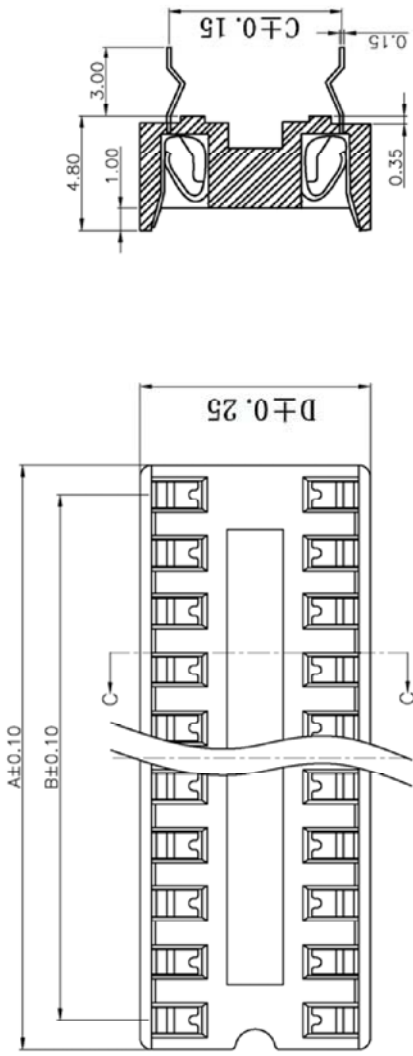

PCB LAYOUT

| PIN NO. | DIM A | DIM B | DIM C | DIM D |
|---------|-------|-------|-------|-------|
| 8 | 10.16 | 7.62 | 7.62 | 10.16 |
| 14 | 17.78 | 15.24 | 7.62 | 10.16 |
| 16 | 20.32 | 17.76 | 7.62 | 10.16 |
| 18 | 22.86 | 20.32 | 7.62 | 10.16 |
| 20 | 25.4 | 22.86 | 7.62 | 10.16 |
| 22 | 27.95 | 25.4 | 7.62 | 10.16 |

| DATE | DR. BY | ECN. NO. | DESCRIPTION | MARK | VER. |
|--|--------|----------|--|--------|------|
| 2011/06/21 | XIE | | NEW DWG | | A0 |
| -TOLERANCES- UNLESS OTHERWISE SPECIFIED | | | | | |
| X.X | ±0.30 | X.X | ±3.00 | APPD: | |
| X.XX | ±0.25 | X.XX | ±1.00 | CHECK: | |
| X.XXX | ±0.100 | X.XXX | ±0.500 | DRAW: | |
| | | | CnC Tech, LLC Industrial Cable and Connector Technology | | |
| | | | | | |
| | | | TITLE: Low Cost Version IC Socket, Retentive Leg, 7.62MM Pitch | | |
| | | | PRODUCT NO: 245-XX-1-03 | | |
| X.X | SCALE | UNIT | TYPE | PAGE | |
| X.XXX | 1:1 | mm | Z | 1/1 | |