

## 7.5A, 35V - 150V Schottky Barrier Rectifier

### FEATURES

- AEC-Q101 qualified available
- Low power loss, high efficiency
- Guard ring for over-voltage protection
- High surge current capability
- UL Recognized File # E-326243
- RoHS Compliant
- Halogen-free according to IEC 61249-2-21

### APPLICATIONS

- Switching mode power supply (SMPS)
- Adapters
- DC to DC converter

### MECHANICAL DATA

- Case: ITO-220AC
- Molding compound meets UL 94V-0 flammability rating
- Terminal: Matte tin plated leads, solderable per J-STD-002
- Mounting torque: 0.56 N·m maximum
- Meet JESD 201 class 2 whisker test
- Polarity: As marked
- Weight: 1.70g (approximately)

KEY PARAMETERS		
PARAMETER	VALUE	UNIT
$I_F$	7.5	A
$V_{RRM}$	35 - 150	V
$I_{FSM}$	150	A
$T_{JMAX}$	150	°C
Package	ITO-220AC	
Configuration	Single die	

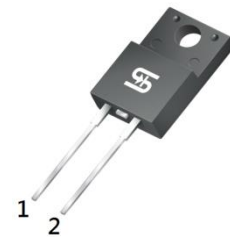
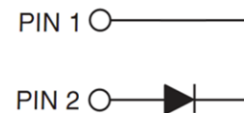
**ITO-220AC**

ABSOLUTE MAXIMUM RATINGS ( $T_A = 25^\circ\text{C}$ unless otherwise noted)									
PARAMETER	SYMBOL	MBRF 735	MBRF 745	MBRF 750	MBRF 760	MBRF 790	MBRF 7100	MBRF 7150	UNIT
Marking code on the device		MBRF 735	MBRF 745	MBRF 750	MBRF 760	MBRF 790	MBRF 7100	MBRF 7150	
Repetitive peak revers voltage	$V_{RRM}$	35	45	50	60	90	100	150	V
Reverse voltage total rms value	$V_{R(RMS)}$	24	31	35	42	63	70	105	V
Forward current	$I_F$	7.5							A
Surge peak forward current, 8.3ms single half sine wave superimposed on rated load	$I_{FSM}$	150							A
Peak repetitive reverse surge current <sup>(1)</sup>	$I_{RRM}$	1.0			0.5				A
Peak repetitive forward current (Rated $V_R$ , Square wave, 20KHz)	$I_{FRM}$	15							A
Critical rate of rise of off-state voltage	dv/dt	10,000							V/ $\mu\text{s}$
Junction temperature	$T_J$	-55 to +150							°C
Storage temperature	$T_{STG}$	-55 to +175							°C

#### Notes:

1.  $t_p = 2.0\mu\text{s}$ , 1.0KHz

<b>THERMAL PERFORMANCE</b>			
<b>PARAMETER</b>	<b>SYMBOL</b>	<b>TYP</b>	<b>UNIT</b>
Junction-to-case resistance	$R_{\theta JC}$	7	°C/W

<b>ELECTRICAL SPECIFICATIONS</b> ( $T_A = 25^\circ\text{C}$ unless otherwise noted)								
<b>PARAMETER</b>		<b>CONDITIONS</b>	<b>SYMBOL</b>	<b>TYP</b>	<b>MAX</b>	<b>UNIT</b>		
Forward voltage <sup>(1)</sup>	MBRF735 MBRF745	$I_F = 7.5\text{A}, T_J = 25^\circ\text{C}$	$V_F$	-	-	V		
	MBRF750 MBRF760			-	0.75	V		
	MBRF790 MBRF7100			-	0.92	V		
	MBRF7150			-	1.02	V		
	MBRF735 MBRF745	$I_F = 15\text{A}, T_J = 25^\circ\text{C}$		-	0.84	V		
	MBRF750 MBRF760			-	-	V		
	MBRF790 MBRF7100			-	-	V		
	MBRF7150			-	-	V		
	MBRF735 MBRF745	$I_F = 7.5\text{A}, T_J = 125^\circ\text{C}$		-	0.57	V		
	MBRF750 MBRF760			-	0.65	V		
	MBRF790 MBRF7100			-	0.82	V		
	MBRF7150			-	0.92	V		
	MBRF735 MBRF745	$I_F = 15\text{A}, T_J = 125^\circ\text{C}$		-	0.72	V		
	MBRF750 MBRF760			-	-	V		
	MBRF790 MBRF7100			-	-	V		
	MBRF7150			-	-	V		
	Reverse current @ rated $V_R$ <sup>(2)</sup>	MBRF735 MBRF745 MBRF750 MBRF760 MBRF790 MBRF7100 MBRF7150		$T_J = 25^\circ\text{C}$	$I_R$	-	100	$\mu\text{A}$
		MBRF735 MBRF745		$T_J = 125^\circ\text{C}$		-	15	mA
MBRF750 MBRF760		-	10			mA		
MBRF790 MBRF7100 MBRF7150		-	5			mA		

**Notes:**

1. Pulse test with  $PW = 0.3\text{ms}$
2. Pulse test with  $PW = 30\text{ms}$

**ORDERING INFORMATION**

<b>ORDERING CODE<sup>(1)(2)</sup></b>	<b>PACKAGE</b>	<b>PACKING</b>
MBRF7x	ITO-220AC	50 / Tube
MBRF7xH	ITO-220AC	50 / Tube

**Notes:**

1. “x” defines voltage from 35V(MBRF735) to 150V(MBRF7150)
2. “H” means AEC-Q101 qualified

**CHARACTERISTICS CURVES**

( $T_A = 25^\circ\text{C}$  unless otherwise noted)

**Fig.1 Forward Current Derating Curve**

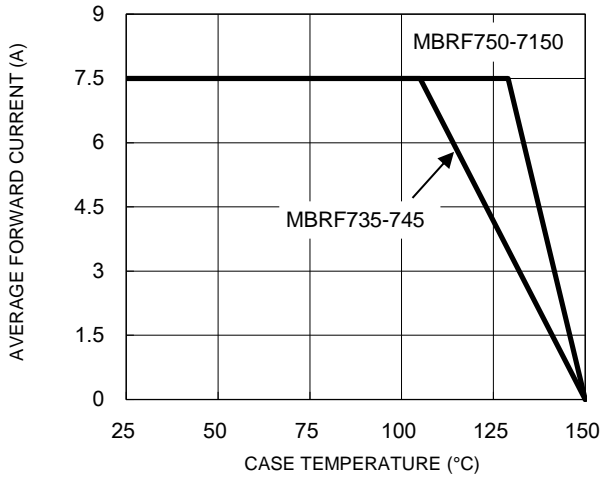

**Fig.2 Typical Junction Capacitance**

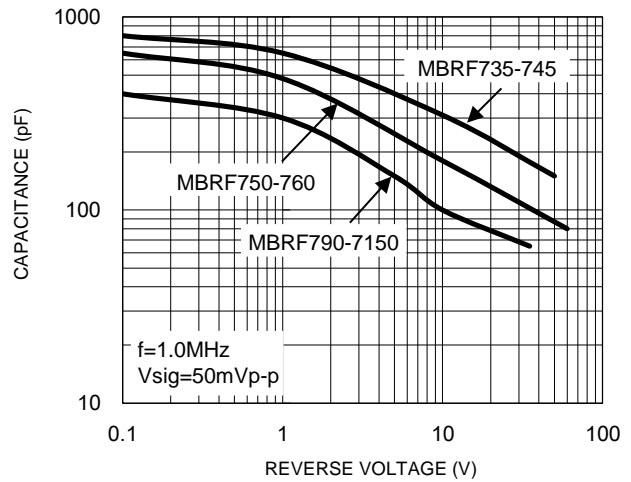

**Fig.3 Typical Reverse Characteristics**

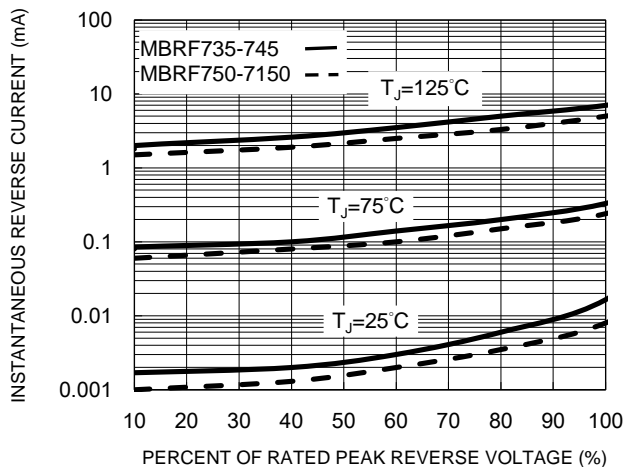

**Fig.4 Typical Forward Characteristics**

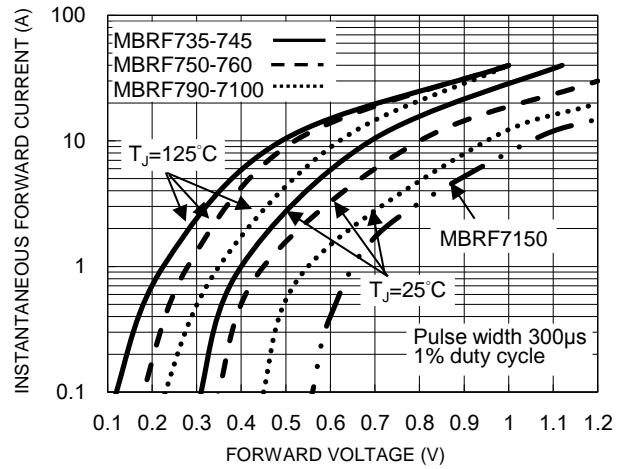

**Fig.5 Maximum Non-Repetitive Forward Surge Current**

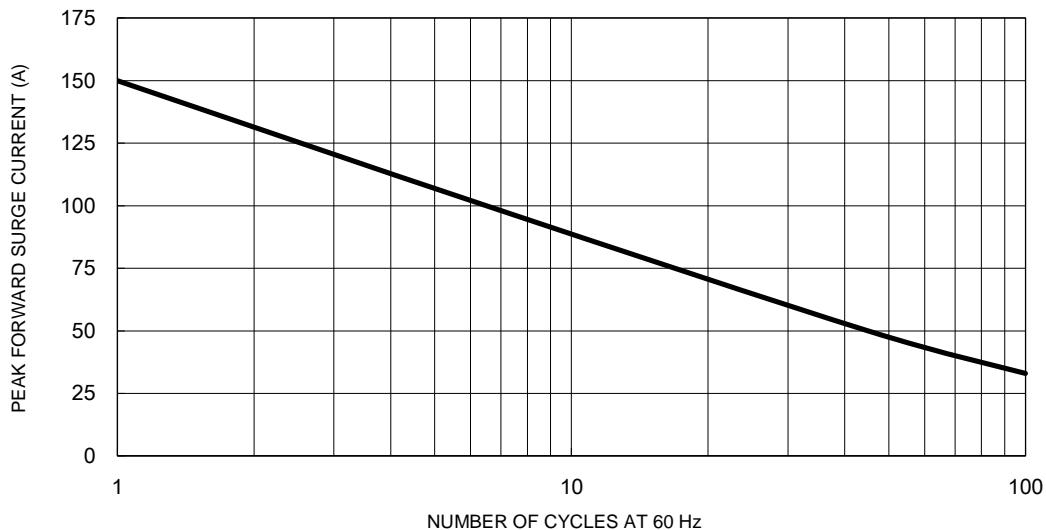

**CHARACTERISTICS CURVES**

( $T_A = 25^\circ\text{C}$  unless otherwise noted)

**Fig.6 Typical Transient Thermal Characteristics**

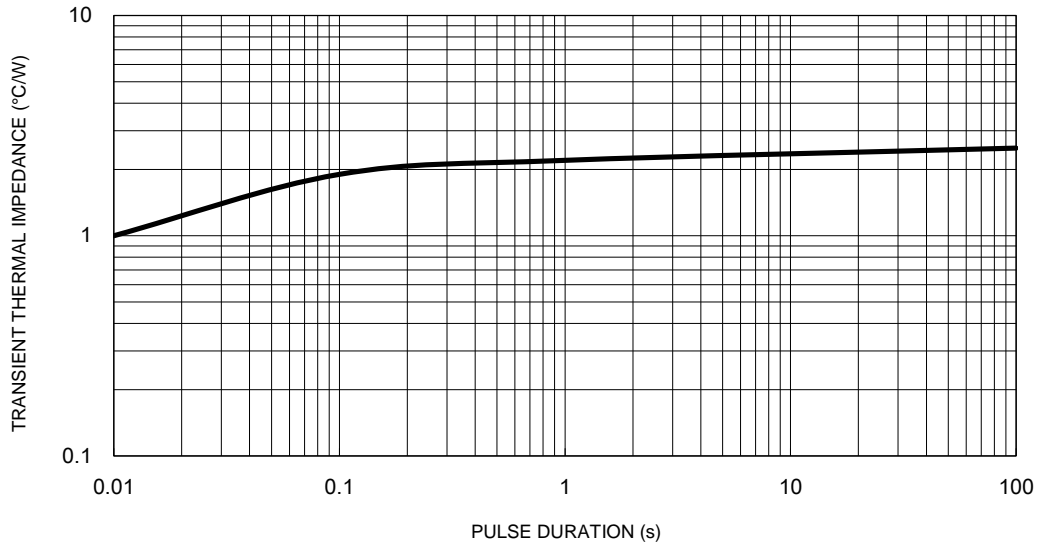

**PACKAGE OUTLINE DIMENSIONS**

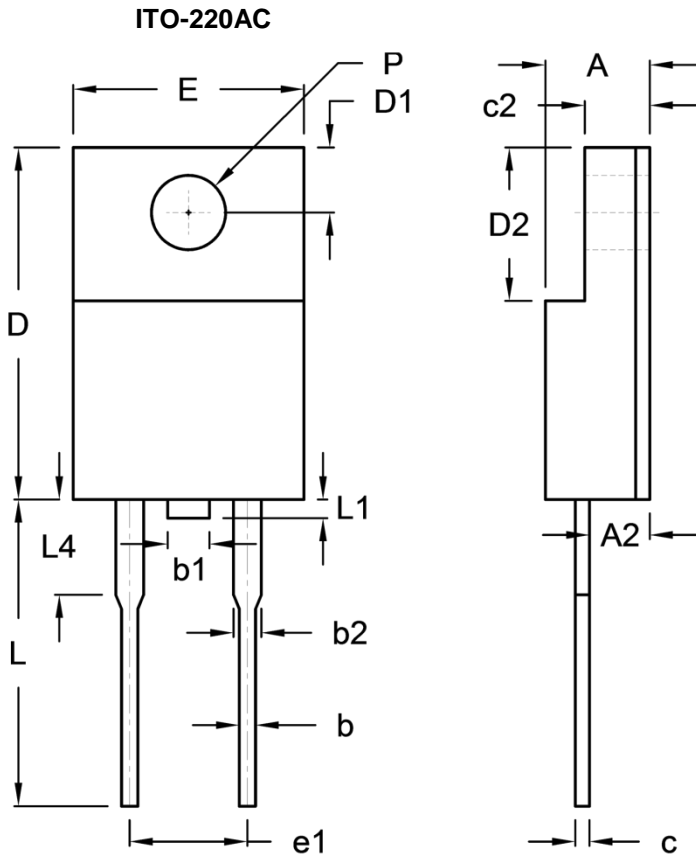

DIM.	Unit (mm)		Unit (inch)	
	Min.	Max.	Min.	Max.
A	4.30	4.70	0.169	0.185
A2	2.30	2.90	0.091	0.114
b	0.50	0.90	0.020	0.035
b1	-	1.80	-	0.071
b2	0.95	1.45	0.037	0.057
c	0.46	0.76	0.018	0.030
c2	2.50	3.10	0.098	0.114
D	14.80	15.50	0.583	0.610
D1	2.40	3.20	0.094	0.126
D2	6.30	6.90	0.248	0.272
E	9.60	10.30	0.378	0.406
e1	4.95	5.20	0.195	0.205
L	12.60	13.80	0.496	0.543
L1	0.00	1.60	0.000	0.063
L4	-	4.10	-	0.161
P	3.00	3.40	0.118	0.134

**MARKING DIAGRAM**



- P/N = Marking Code
- G = Green Compound
- YWW = Date Code
- F = Factory Code

## **Notice**

Specifications of the products displayed herein are subject to change without notice. TSC or anyone on its behalf assumes no responsibility or liability for any errors or inaccuracies.

Purchasers are solely responsible for the choice, selection, and use of TSC products and TSC assumes no liability for application assistance or the design of Purchasers' products.

Information contained herein is intended to provide a product description only. No license, express or implied, to any intellectual property rights is granted by this document. Except as provided in TSC's terms and conditions of sale for such products, TSC assumes no liability whatsoever, and disclaims any express or implied warranty, relating to sale and/or use of TSC products including liability or warranties relating to fitness for a particular purpose, merchantability, or infringement of any patent, copyright, or other intellectual property right.

The products shown herein are not designed for use in medical, life-saving, or life-sustaining applications. Customers using or selling these products for use in such applications do so at their own risk and agree to fully indemnify TSC for any damages resulting from such improper use or sale.