

Hexagonal locknut

2xx PAzzzz

Hexagonal locknut	Polyamide PA6 GF30
Internal thread	Pg as per DIN 40430

Properties

Temperature range	<ul style="list-style-type: none">• for secure tightening of cable glands and accessories <p>-40 °C +100 °C</p>
-------------------	---

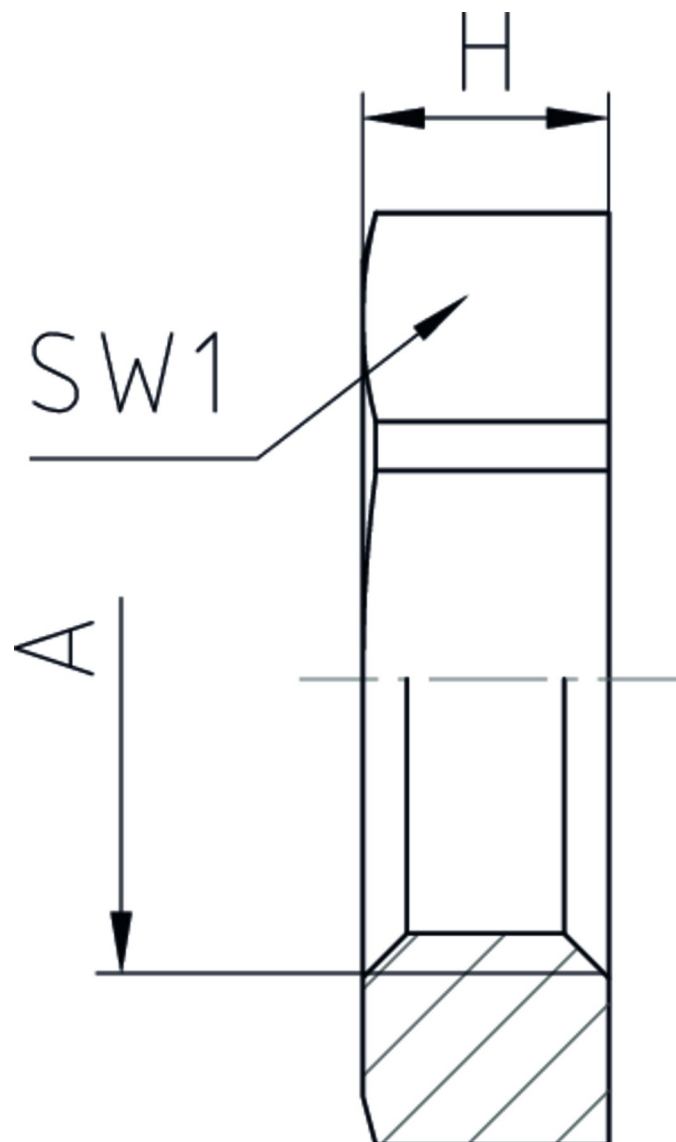

Features



RAL 9005

A	SW1	H	 VPE	Part No.
Pg 7	19	5	100	207 PA/SW
Pg 9	22	5	100	209 PA/SW
Pg 11	24	5	100	211 PA/SW
Pg 13,5	27	6	100	213 PA/SW
Pg 16	30	6	100	216 PA/SW
Pg 21	36	7	100	s221 PA/SW
Pg 29	46	7	100	229 PA/SW
Pg 36	60	8	50	236 PA/SW
Pg 42	65	8	50	242 PA/SW
Pg 48	70	8	50	248 PA/SW



RAL 7035

A	SW1	H	 VPE	Part No.
Pg 7	19	5	100	207 PA
Pg 9	22	5	100	209 PA
Pg 11	24	5	100	211 PA
Pg 13,5	27	6	100	213 PA
Pg 16	30	6	100	216 PA
Pg 21	36	7	100	221 PA
Pg 29	46	7	100	229 PA
Pg 36	60	8	50	236 PA
Pg 42	65	8	50	242 PA
Pg 48	70	8	50	248 PA