

PERFECT cable gland

K345-1xxx-zz

Dome nut	Polyamide PA6 V-2
Sealing ring	NBR/SBR, slotted
Gland body	Polyamide PA6 V-2
Connecting thread	metric, as per EN 60423



Properties

	<ul style="list-style-type: none"> the slotted sealing ring enables cables and leads with fixed connectors (e.g. RJ-45, USB, etc.) to be installed simply and securely suitable for circular connectors with diameter up to 17mm and connectors with rectangular cross-section and diagonal up to 16,5mm integrated anchorage wide sealing and clamping range easy-to-install
Temperature range	-20 °C / +70 °C (dynamic) -40 °C (static, short term)
Protection grade	IP65

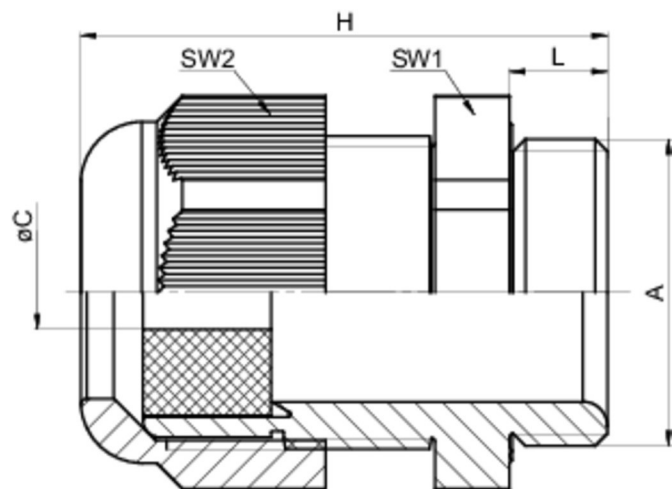

Features

 RAL 9005

Connecting thread standard length

A	ØC	L	SW1	SW2	H	 VPE	Part No.
M25x1,5	3 - 8	8	29	29	43	50	K345-1025-02

 RAL 7035

Connecting thread standard length

A	ØC	L	SW1	SW2	H	 VPE	Part No.
---	----	---	-----	-----	---	---	----------

M25x1,5	3 - 8	8	29	29	43	50	K345-1025-00
---------	-------	---	----	----	----	----	--------------

 RAL 7001

Connecting thread standard length

A	ØC	L	SW1	SW2	H	 VPE	Part No.
---	----	---	-----	-----	---	---	----------

M25x1,5	3 - 8	8	29	29	43	50	K345-1025-01
---------	-------	---	----	----	----	----	--------------

PERFECT cable glands made of brass and stainless steel also available with slotted sealing insert.