

DETAIL A
SCALE 4:1

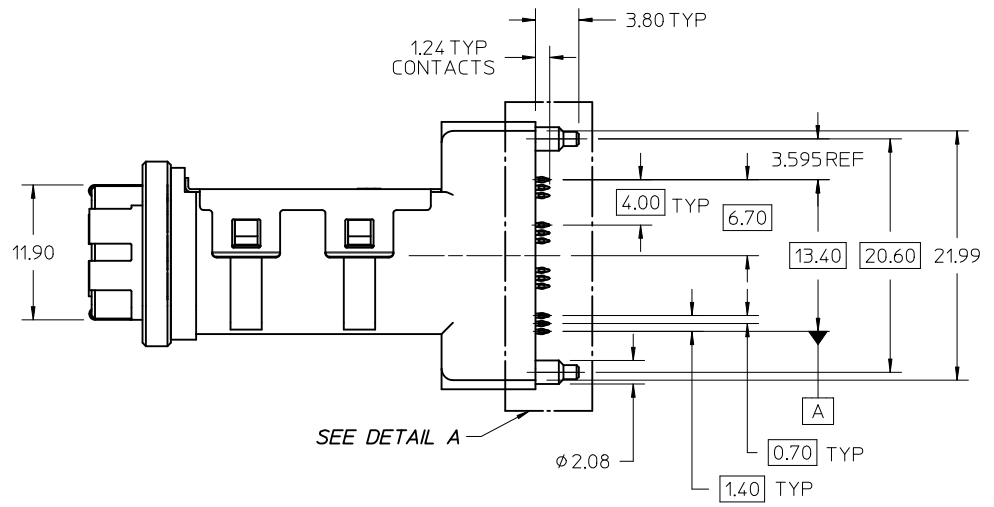
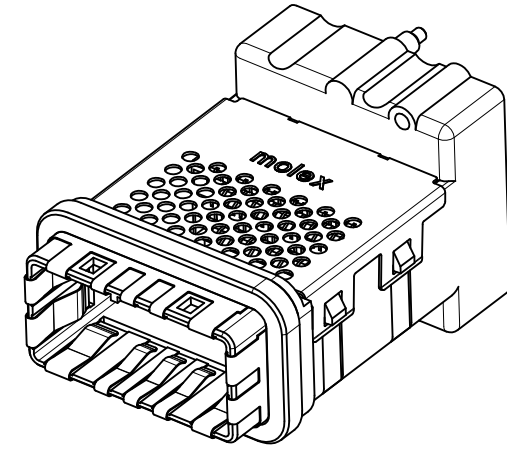

- NOTES:**
- MATERIALS:**
CONNECTOR HOUSING: HIGH TEMPERATURE THERMOPLASTIC, GLASS-FILLED, UL 94V-0
EMI HOUSING: NICKEL PLATED DIE CAST ALLOY
COVER: STAINLESS STEEL
HEATSINK BASE: ALUMINUM
EMI GASKET: CONDUCTIVE POLYMER
TERMINALS: COPPER ALLOY
 - PLATING:**
769970042 - CONTACT AREA: 0.764mm MIN. GOLD OVER 2.544mm MIN. NICKEL
TIN TAIL AREA: 0.764mm - 1.524mm TIN OVER 2.544mm MIN NICKEL
 - THIS CONNECTOR IS DESIGNED TO MATE WITH MOLEX IPASS CABLES.
 - PACKAGING SPECIFICATION: TRAY PACK PER PK-76997-001.
 - PRODUCT SPECIFICATION: PS-76997-001.
 - APPLICATION SPECIFICATION: AS-76997-001 AND AS-76997-002.

769970042	TIN
MATERIAL NUMBER	TAIL PLATING

REVISED NOTE: SHT2 EC NO: UCP2011-0869 DRWN: LONG CHKD: APPR: MBANAKIS 2010/09/27 2010/10/12	QUALITY SYMBOLS 	GENERAL TOLERANCES (UNLESS SPECIFIED)		DIMENSION STYLE MM ONLY		SCALE 3:1	DESIGN UNITS METRIC	THIRD ANGLE PROJECTION			
		4 PLACES ± --- ± ---	3 PLACES ± --- ± ---	DRAWN BY JLONG	DATE 2010/02/12	TITLE VERTICAL CXP ASSEMBLY HIGH SPEED CHANNEL 0.8MM I/O					
		2 PLACES ± 0.25 ± ---	1 PLACE ± --- ± ---	CHECKED BY JLONG	DATE 2010/02/12	MOLEX INCORPORATED					
		ANGULAR ± 1/2°		APPROVED BY MBANAKIS	DATE 2010/02/22	MATERIAL NO. SEE CHART		DOCUMENT NO. SD-76997-005	SHEET NO. 1 OF 3		
DRAFT WHERE APPLICABLE MUST REMAIN WITHIN DIMENSIONS		SIZE C		THIS DRAWING CONTAINS INFORMATION THAT IS PROPRIETARY TO MOLEX INCORPORATED AND SHOULD NOT BE USED WITHOUT WRITTEN PERMISSION							

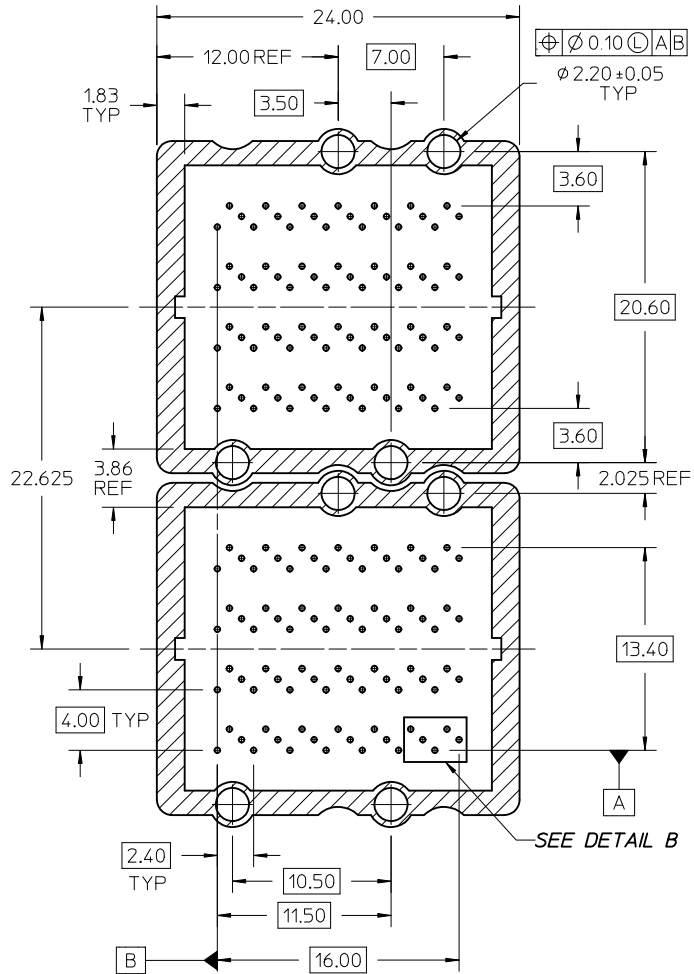

RECOMMENDED PCB LAYOUT
COMPONENT SIDE SHOWN
MULTIPLE APPLICATION SHOWN
ON MINIMUM PITCH
PCB THICKNESS: 1.57mm MIN.

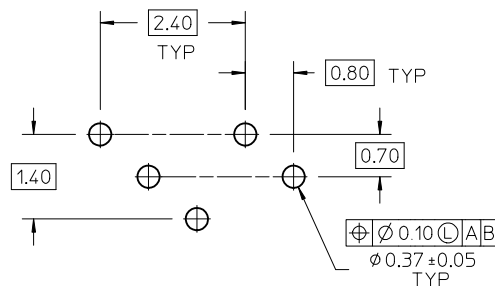

DETAIL B
SCALE 16:1

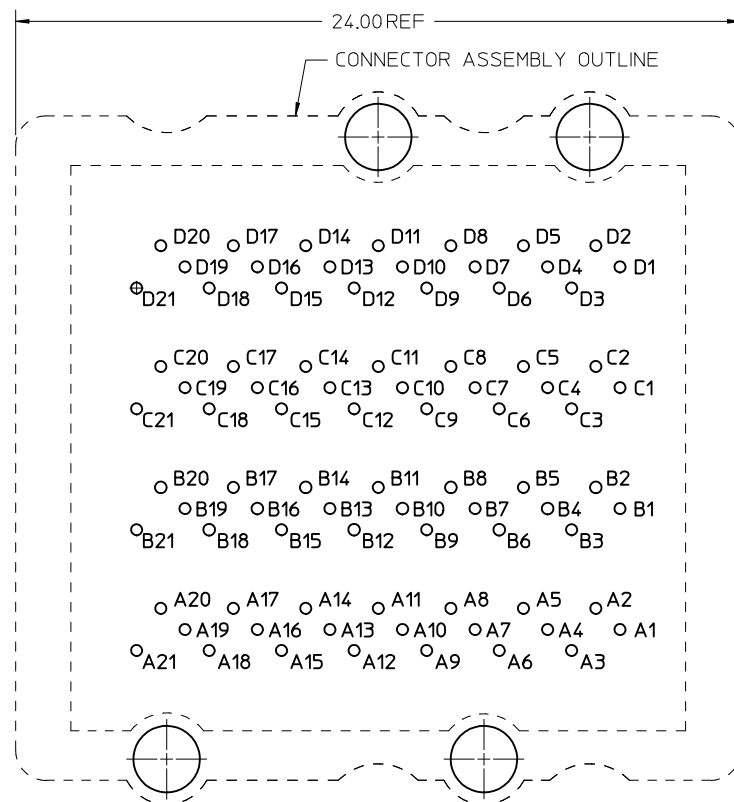

RECOMMENDED PCB LAYOUT
COMPONENT SIDE SHOWN

NOTES:

- CROSS-HATCHED AREA TO BE CONDUCTIVE ON THE PCB.
- CROSS-HATCHED AREA MUST BE INCORPORATED IN THE FLAT ROCK PRESS-FIT TOOLING.
- REFER TO THE PLATING DETAIL OF THE COMPLIANT PIN HOLES IN THE APPLICATION SPEC AS-76997-002 FOR THE DRILL SIZE AND ANNULAR RING FOR THE 0.37 ϕ FINISHED HOLE.

SEE SHEET 1 EC NO: UCP2011-0869 DRWN: JLONG CHKD: MBANAKIS APPR: MBANAKIS	2010/09/27 2010/10/12	QUALITY SYMBOLS	GENERAL TOLERANCES (UNLESS SPECIFIED)	DIMENSION STYLE MM ONLY	SCALE 4:1	DESIGN UNITS METRIC	THIRD ANGLE PROJECTION																												
		$\nabla = 0$ $\nabla = 0$ $\nabla = 0$	<table border="1"> <thead> <tr> <th></th> <th>mm</th> <th>INCH</th> </tr> </thead> <tbody> <tr> <td>4 PLACES</td> <td>\pm ---</td> <td>\pm ---</td> </tr> <tr> <td>3 PLACES</td> <td>\pm ---</td> <td>\pm ---</td> </tr> <tr> <td>2 PLACES</td> <td>± 0.25</td> <td>\pm ---</td> </tr> <tr> <td>1 PLACE</td> <td>\pm ---</td> <td>\pm ---</td> </tr> </tbody> </table>		mm	INCH	4 PLACES	\pm ---	\pm ---	3 PLACES	\pm ---	\pm ---	2 PLACES	± 0.25	\pm ---	1 PLACE	\pm ---	\pm ---	<table border="1"> <thead> <tr> <th>DRAWN BY</th> <th>DATE</th> </tr> </thead> <tbody> <tr> <td>JLONG</td> <td>2010/02/12</td> </tr> <tr> <th>CHECKED BY</th> <th>DATE</th> </tr> <tr> <td>JLONG</td> <td>2010/02/12</td> </tr> <tr> <th>APPROVED BY</th> <th>DATE</th> </tr> <tr> <td>MBANAKIS</td> <td>2010/02/22</td> </tr> </tbody> </table>	DRAWN BY	DATE	JLONG	2010/02/12	CHECKED BY	DATE	JLONG	2010/02/12	APPROVED BY	DATE	MBANAKIS	2010/02/22	TITLE VERTICAL CXP ASSEMBLY HIGH SPEED CHANNEL 0.8MM I/O	MATERIAL NO.	DOCUMENT NO.	SHEET NO. 2 OF 3
			mm	INCH																															
		4 PLACES	\pm ---	\pm ---																															
3 PLACES	\pm ---	\pm ---																																	
2 PLACES	± 0.25	\pm ---																																	
1 PLACE	\pm ---	\pm ---																																	
DRAWN BY	DATE																																		
JLONG	2010/02/12																																		
CHECKED BY	DATE																																		
JLONG	2010/02/12																																		
APPROVED BY	DATE																																		
MBANAKIS	2010/02/22																																		
ANGULAR $\pm 1/2^\circ$	DRAFT WHERE APPLICABLE MUST REMAIN WITHIN DIMENSIONS	SEE CHART	MOLEX INCORPORATED	SD-76997-005																															
REV A1		SIZE C	THIS DRAWING CONTAINS INFORMATION THAT IS PROPRIETARY TO MOLEX INCORPORATED AND SHOULD NOT BE USED WITHOUT WRITTEN PERMISSION																																

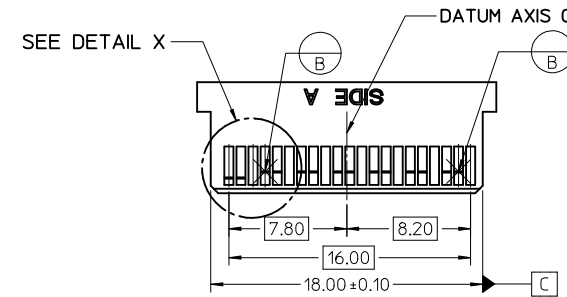
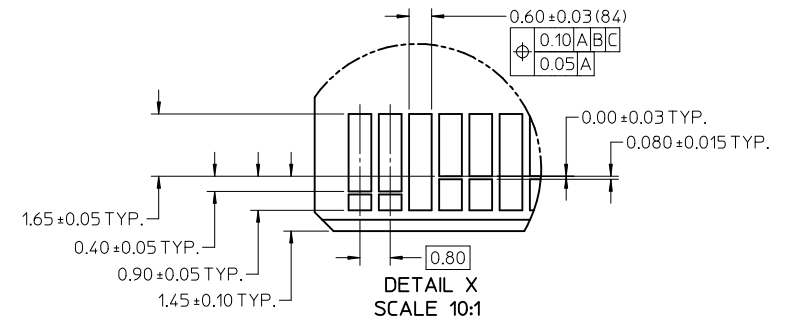
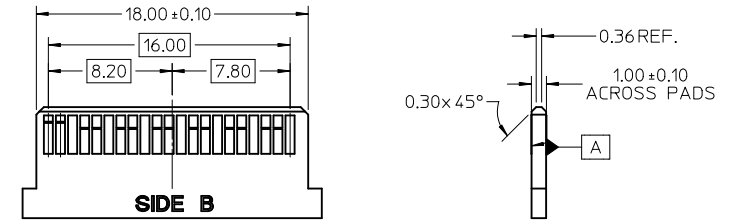
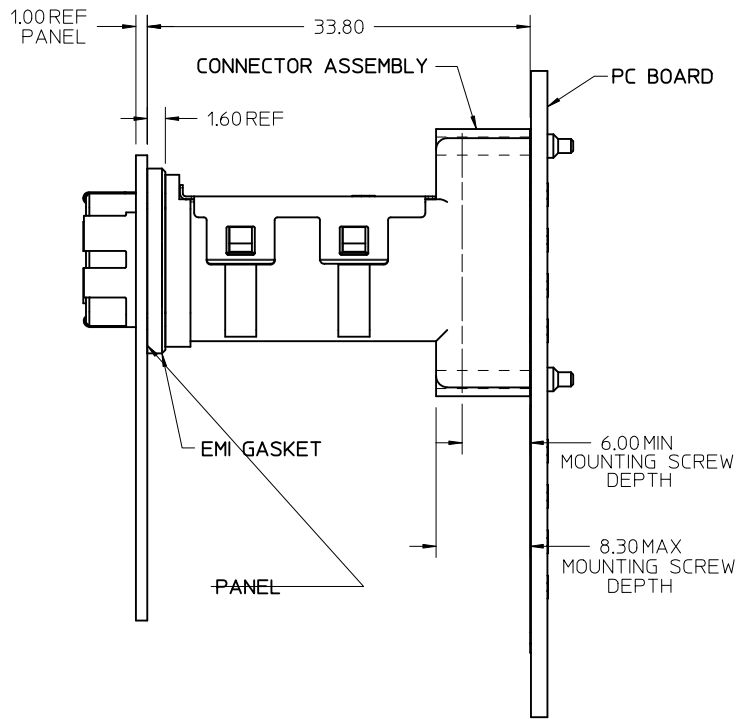

- NOTES:
- 0.03 MINIMUM KEEP OUT FOR SOLDER MASK AROUND ALL PADS
 - DATUM B TARGETS ARE DEFINED BY THE RESPECTIVE PAD CENTER LINES AND THE LEADING EDGE OF THE TARGET PADS

RECOMMENDED PADDLE CARD LAYOUT

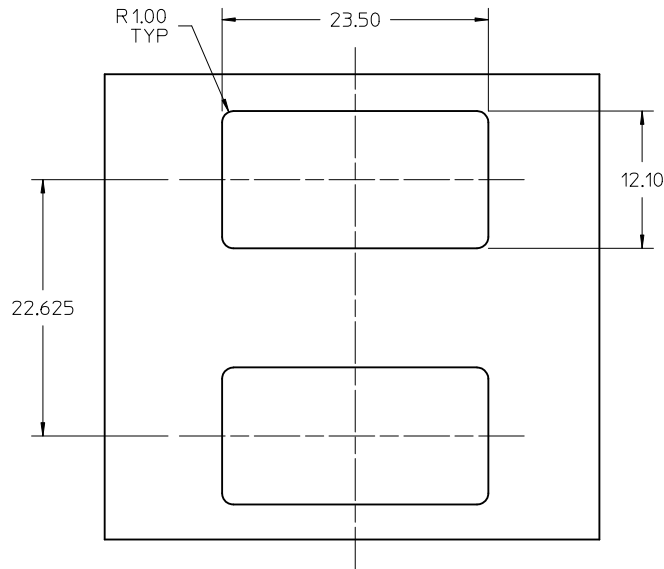

I/O PANEL CUT-OUT

SEE SHEET 1 EC NO: UCP2011-0869 DRWN: JLONG CHKD: MBANAK I S APPR: MBANAK I S	QUALITY SYMBOLS ▽=0 ▽=0 ▽=0	GENERAL TOLERANCES (UNLESS SPECIFIED)		DIMENSION STYLE MM ONLY		SCALE 3:1	DESIGN UNITS METRIC	THIRD ANGLE PROJECTION		
		4 PLACES ± --- ± ---	3 PLACES ± --- ± ---	2 PLACES ± 0.25 ± ---	1 PLACE ± --- ± ---	DRAWN BY JLONG	DATE 2010/02/12	TITLE VERTICAL CXP ASSEMBLY HIGH SPEED CHANNEL 0.8MM I/O		
		ANGULAR ± 1/2°		DRAFT WHERE APPLICABLE MUST REMAIN WITHIN DIMENSIONS		CHECKED BY JLONG	DATE 2010/02/12	APPROVED BY MBANAK I S		
		MATERIAL NO. SEE CHART		DOCUMENT NO. SD-76997-005		SHEET NO. 3 OF 3		Molex MOLEX INCORPORATED		
A1	REV	THIS DRAWING CONTAINS INFORMATION THAT IS PROPRIETARY TO MOLEX INCORPORATED AND SHOULD NOT BE USED WITHOUT WRITTEN PERMISSION								

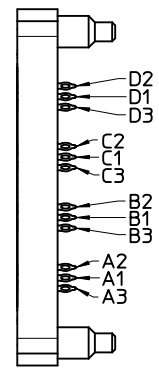
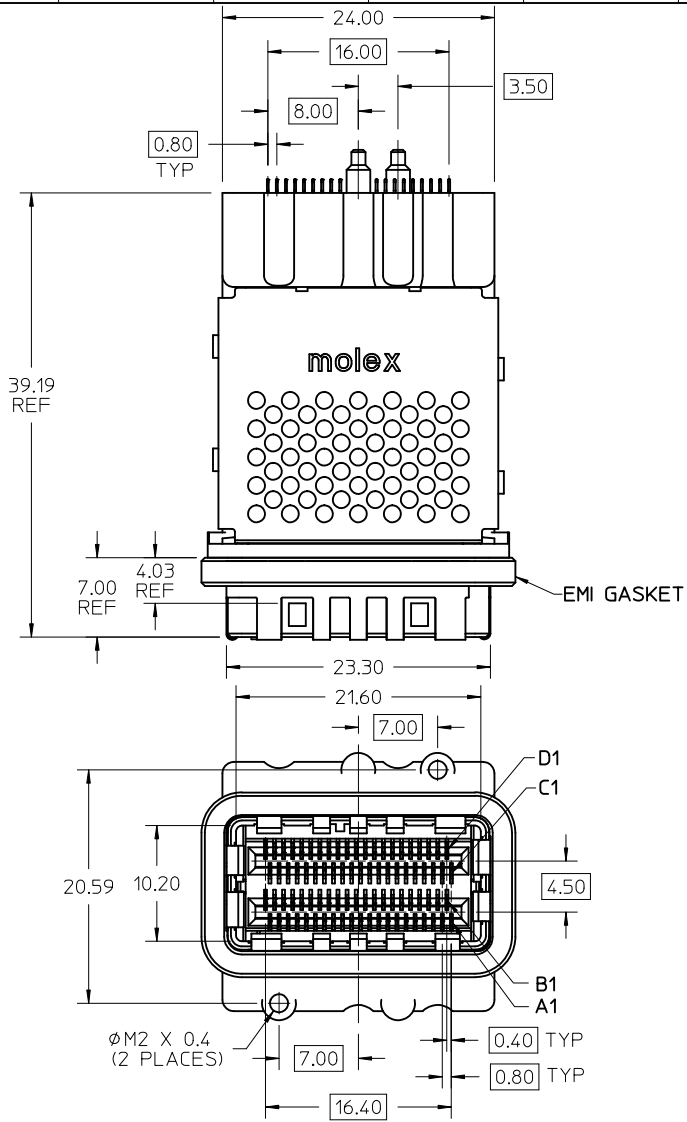

DETAIL A
SCALE 4:1

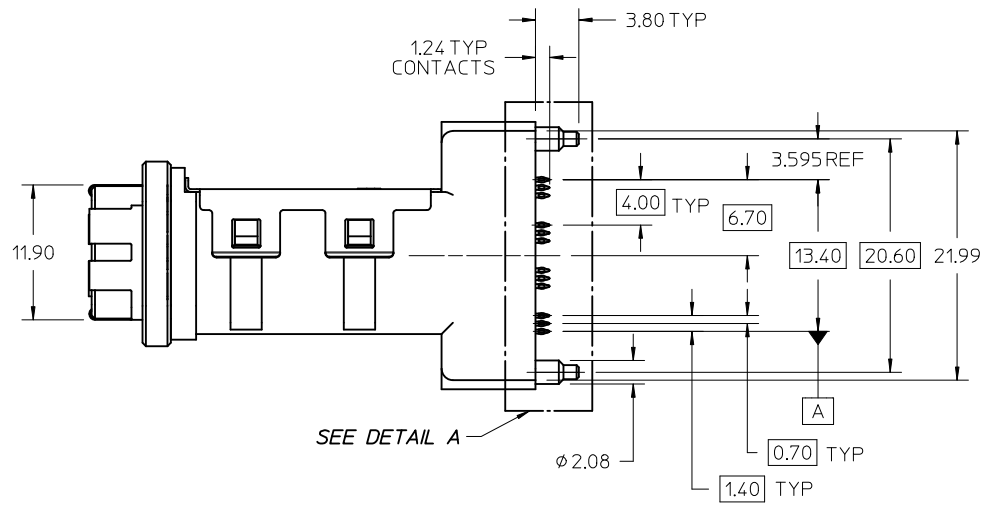
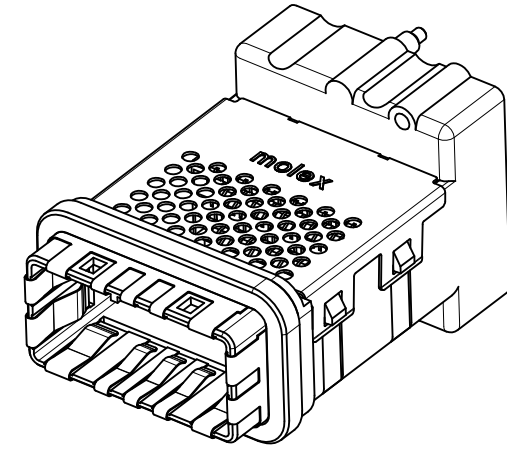

- NOTES:**
- MATERIALS:**
CONNECTOR HOUSING: HIGH TEMPERATURE THERMOPLASTIC, GLASS-FILLED, UL 94V-0
EMI HOUSING: NICKEL PLATED DIE CAST ALLOY
COVER: STAINLESS STEEL
HEATSINK BASE: ALUMINUM
EMI GASKET: CONDUCTIVE POLYMER
TERMINALS: COPPER ALLOY
 - PLATING:**
769970042 - CONTACT AREA: 0.764mm MIN. GOLD OVER 2.544mm MIN. NICKEL
TIN TAIL AREA: 0.764mm - 1.524mm TIN OVER 2.544mm MIN NICKEL
 - THIS CONNECTOR IS DESIGNED TO MATE WITH MOLEX IPASS CABLES.
 - PACKAGING SPECIFICATION: TRAY PACK PER PK-76997-001.
 - PRODUCT SPECIFICATION: PS-76997-001.
 - APPLICATION SPECIFICATION: AS-76997-001 AND AS-76997-002.

769970042	TIN
MATERIAL NUMBER	TAIL PLATING

REVISED NOTE: SHT2 EC NO: UCP2011-0869 DRWN: LONG CHKD: APPR: MBANAKIS 2010/09/27 2010/10/12	QUALITY SYMBOLS 	GENERAL TOLERANCES (UNLESS SPECIFIED)		DIMENSION STYLE MM ONLY		SCALE 3:1	DESIGN UNITS METRIC	THIRD ANGLE PROJECTION			
		4 PLACES ± --- ± --- 3 PLACES ± --- ± --- 2 PLACES ± 0.25 ± --- 1 PLACE ± --- ± ---	mm INCH ± --- ± --- ± 0.25 ± --- ± --- ± ---	DRAWN BY JLONG	DATE 2010/02/12	CHECKED BY JLONG	DATE 2010/02/12	VERTICAL CXP ASSEMBLY HIGH SPEED CHANNEL 0.8MM I/O			
		ANGULAR ± 1/2°		APPROVED BY MBANAKIS	DATE 2010/02/22	MOLEX INCORPORATED					
		DRAFT WHERE APPLICABLE MUST REMAIN WITHIN DIMENSIONS		SEE CHART				MATERIAL NO. SD-76997-005	DOCUMENT NO.	SHEET NO. 1 OF 3	

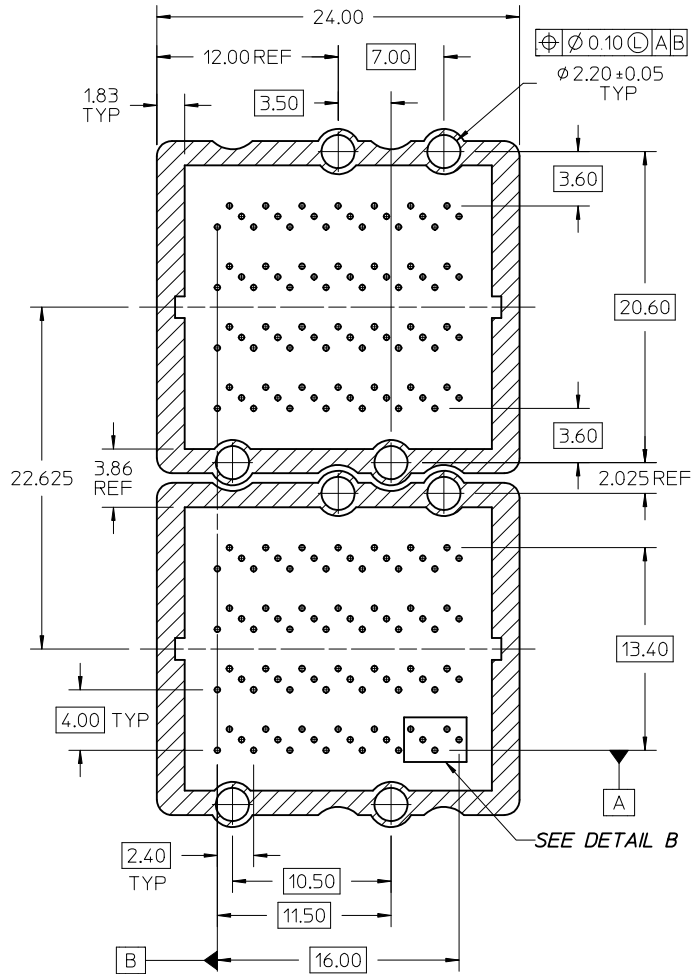

RECOMMENDED PCB LAYOUT
COMPONENT SIDE SHOWN
MULTIPLE APPLICATION SHOWN
ON MINIMUM PITCH
PCB THICKNESS: 1.57mm MIN.

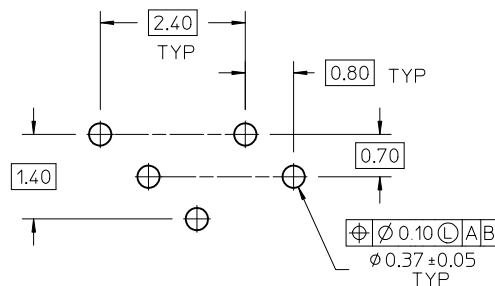

DETAIL B
SCALE 16:1

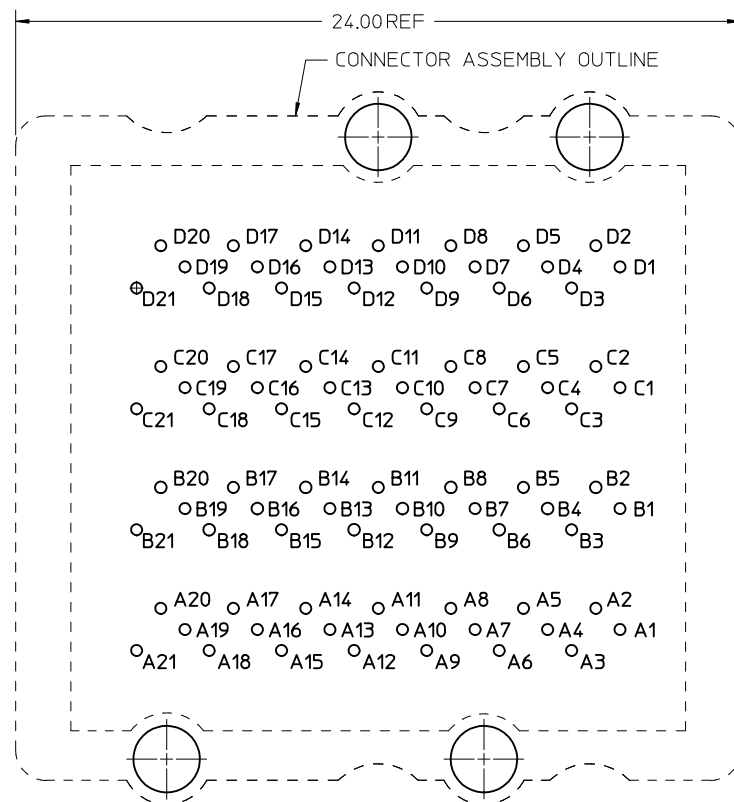

RECOMMENDED PCB LAYOUT
COMPONENT SIDE SHOWN

NOTES:

- CROSS-HATCHED AREA TO BE CONDUCTIVE ON THE PCB.
- CROSS-HATCHED AREA MUST BE INCORPORATED IN THE FLAT ROCK PRESS-FIT TOOLING.
- REFER TO THE PLATING DETAIL OF THE COMPLIANT PIN HOLES IN THE APPLICATION SPEC AS-76997-002 FOR THE DRILL SIZE AND ANNULAR RING FOR THE 0.37 ϕ FINISHED HOLE.

SEE SHEET 1 EC NO: UCP2011-0869 DRWN: JLONG CHKD: MBANAKIS APPR: MBANAKIS 2010/09/27 2010/10/12	QUALITY SYMBOLS ▽=0 ▽=0 ▽=0	GENERAL TOLERANCES (UNLESS SPECIFIED)		DIMENSION STYLE MM ONLY		SCALE 4:1	DESIGN UNITS METRIC	THIRD ANGLE PROJECTION				
		4 PLACES ± --- ± ---	3 PLACES ± --- ± ---	2 PLACES ± 0.25 ± ---	1 PLACE ± --- ± ---	DRAWN BY JLONG	DATE 2010/02/12	TITLE VERTICAL CXP ASSEMBLY HIGH SPEED CHANNEL 0.8MM I/O				
		ANGULAR ± 1/2°				CHECKED BY JLONG	DATE 2010/02/12	APPROVED BY MBANAKIS				DATE 2010/02/22
		DRAFT WHERE APPLICABLE MUST REMAIN WITHIN DIMENSIONS				MATERIAL NO. SEE CHART		DOCUMENT NO. SD-76997-005		SHEET NO. 2 OF 3		

THIS DRAWING CONTAINS INFORMATION THAT IS PROPRIETARY TO MOLEX INCORPORATED AND SHOULD NOT BE USED WITHOUT WRITTEN PERMISSION

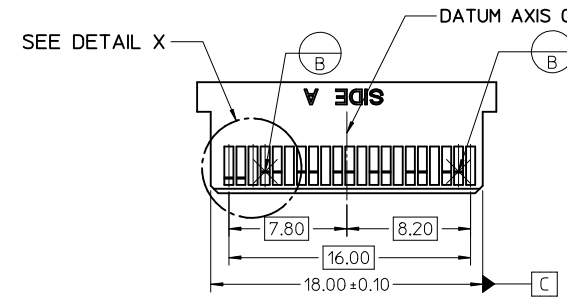
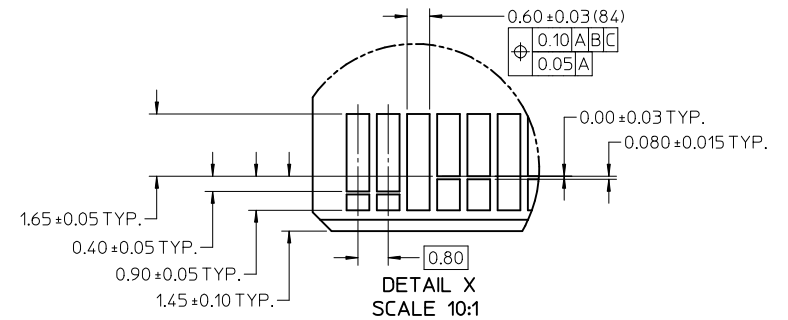
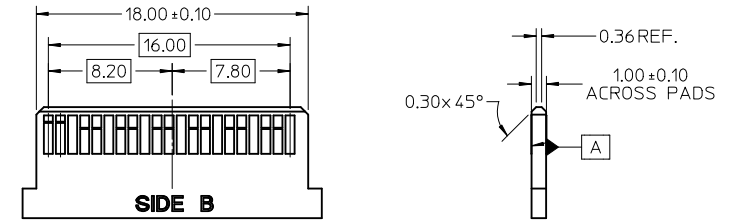
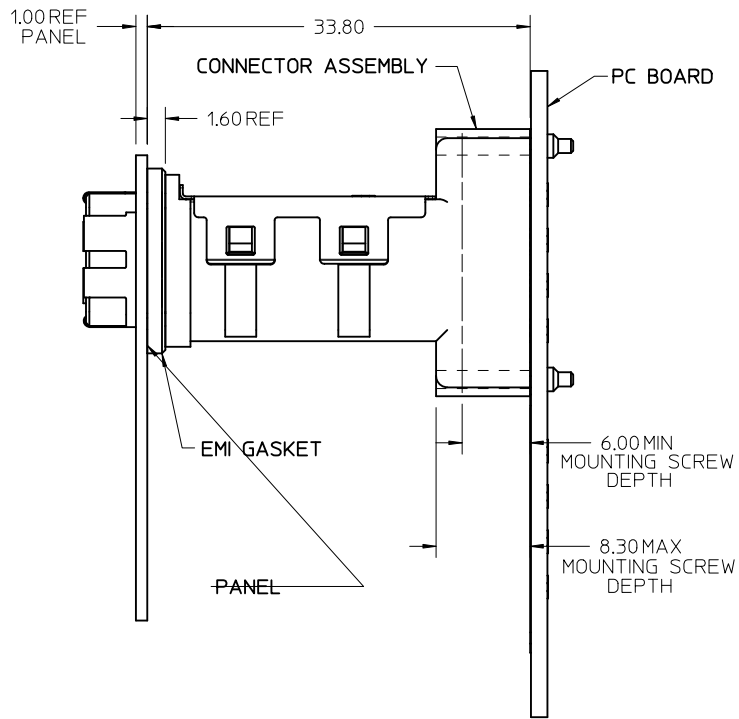

- NOTES:
- 0.03 MINIMUM KEEP OUT FOR SOLDER MASK AROUND ALL PADS
 - DATUM B TARGETS ARE DEFINED BY THE RESPECTIVE PAD CENTER LINES AND THE LEADING EDGE OF THE TARGET PADS

RECOMMENDED PADDLE CARD LAYOUT

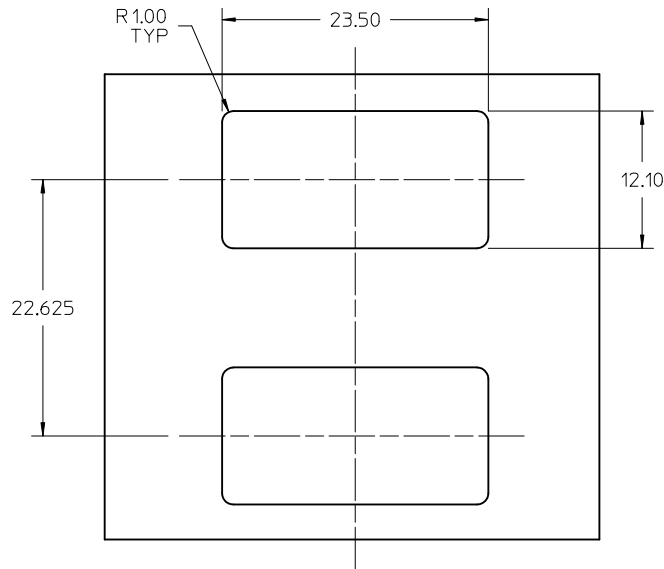

I/O PANEL CUT-OUT

SEE SHEET 1 EC NO: UCP2011-0869 DRWN: JLONG CHKD: MBANAK I S APPR: MBANAK I S	QUALITY SYMBOLS ∇=0 ∇=0 ∇=0	GENERAL TOLERANCES (UNLESS SPECIFIED)		DIMENSION STYLE MM ONLY		SCALE 3:1	DESIGN UNITS METRIC	THIRD ANGLE PROJECTION	
		4 PLACES ± --- ± ---	3 PLACES ± --- ± ---	2 PLACES ± 0.25 ± ---	1 PLACE ± --- ± ---	DRAWN BY JLONG	DATE 2010/02/12	TITLE VERTICAL CXP ASSEMBLY HIGH SPEED CHANNEL 0.8MM I/O	
		ANGULAR ± 1/2°		DRAFT WHERE APPLICABLE MUST REMAIN WITHIN DIMENSIONS		CHECKED BY JLONG	DATE 2010/02/12	APPROVED BY MBANAK I S	
		MATERIAL NO. SEE CHART		DOCUMENT NO. SD-76997-005		SHEET NO. 3 OF 3		MATERIAL NO. SD-76997-005	

THIS DRAWING CONTAINS INFORMATION THAT IS PROPRIETARY TO MOLEX INCORPORATED AND SHOULD NOT BE USED WITHOUT WRITTEN PERMISSION