

DO NOT SCALE FROM THIS PRINT

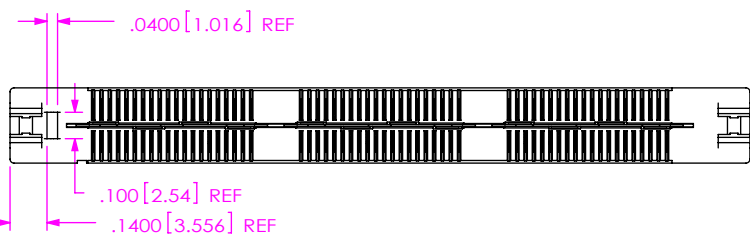

QSE-XXX-01-X-D-EMX-XX

- NO OF POSITIONS**  
 -020, -040, -060  
 \*\*-.080, \*\*-.100 (PER ROW)
- LEAD STYLE**  
 -01: .1380 [3.505]
- PLATING SPECIFICATION**  
 PLATING THICKNESSES ARE FOR SIGNAL PINS ONLY. FOR GROUND PLANE THICKNESSES, SEE PP-T-1G13-XX-X.  
 -F: 3μ" FLASH SELECTIVE GOLD IN CONTACT AREA MATTE TIN ON TAIL (SEE NOTE 6) (USE C-162-XX-F & T-1G13-01-F)  
 -L: 10μ" LIGHT SELECTIVE GOLD IN CONTACT AREA WITH MATTE TIN ON TAIL (USE C-162-XX-L & T-1G13-01-L)  
 -H: 30μ" HEAVY GOLD IN CONTACT AREA 3μ" FLASH GOLD ON TAILS (USE C-162-XX-H & T-1G13-01-G)  
 -TL: TIN/LEAD (90/10±5%) CONTACT AND TAIL  
 -S: 30μ" SELECTIVE GOLD IN CONTACT AREA, MATTE TIN ON TAIL (USE C-162-XX-S & T-1G13-01-L)
- OPTION**  
 \* -GP: GUIDE POST (60 POS MAX) (SEE FIG 2, SEE SHEET 2)  
 -TY: TRAY PACKAGING  
 \* EM3-GP = NOT TOOLED
- EDGE MOUNT THICKNESS**  
 -EM2: .062[1.57] +/- .004 PCB (USE QSE-20-01-D-EM2-XX & C-162-01-X)  
 -EM3: .092[2.34] +/- .004 PCB (USE QSE-20-01-D-EM3-XX & C-162-02-X) (SEE NOTE 10)
- ROW SPECIFICATION**  
 -D: DOUBLE (USE QSE-20-01-D-EMX-XX)
- No OF BANKS  
 \* = SEE NOTE 10  
 \*\* = SEE NOTE 13

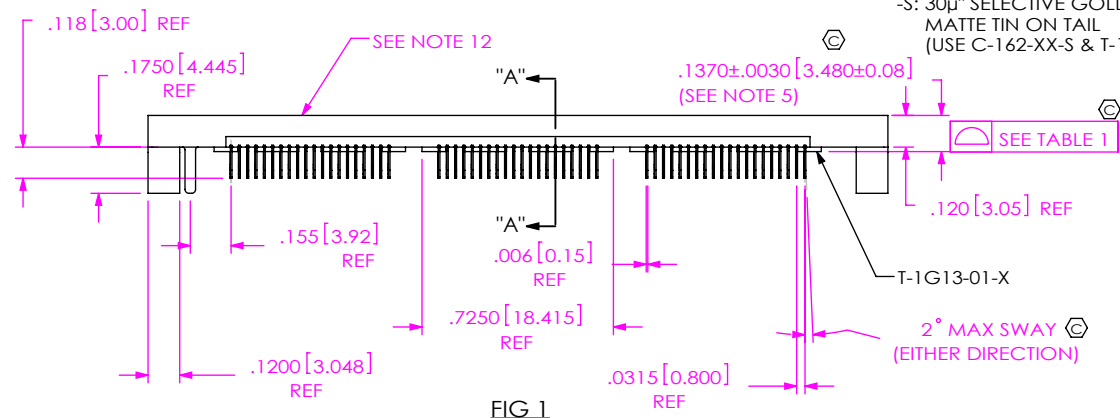
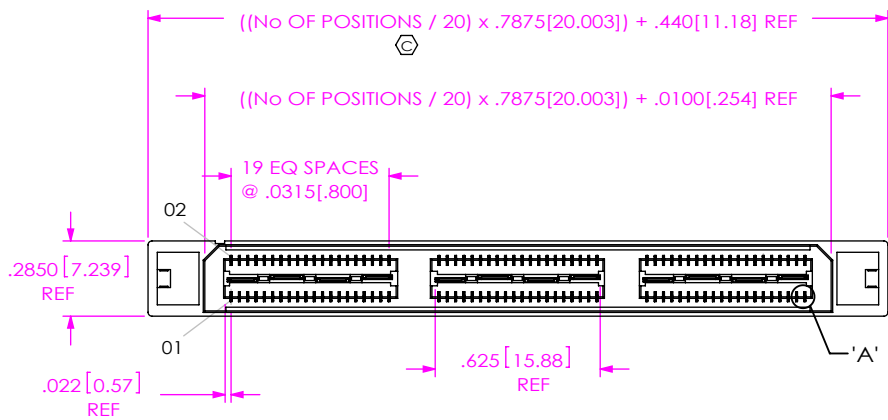
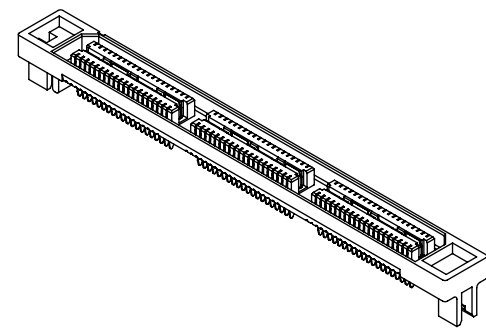

**TABLE 1**

No OF POSITIONS	GND PLANE COPLANARITY	ASSEMBLY BOW
-020 THRU -060	.004 [0.10]	.004 [0.10]
**-.080 THRU **-.100	.005[1.27]	.006[0.15]

\*\* = SEE NOTE 13

- NOTES:
1.  $\text{Ⓞ}$  REPRESENTS A CRITICAL DIMENSION.
  2. MINIMUM CONTACT RETENTION: 6 OZ
  3. MINIMUM GROUND PLANE RETENTION: 8 OZ
  4. PARTS ARE MOLD TO POSITION.
  5. MAXIMUM VARIANCE OF .002[0.05]
  6. -L PLATING CAN BE SUBSTITUTED FOR -F PLATING.
  7. NOTE DELETED.
  8. BOARD THICKNESS TO BE MEASURED FROM SOLDER PAD TO SOLDER PAD.
  9. SEE [HTTP://SUDDEDOC.SAMTEC.COM/PROCESSING/EDGE-MOUNT-PROCESSING.PDF](http://SUDDEDOC.SAMTEC.COM/PROCESSING/EDGE-MOUNT-PROCESSING.PDF) FOR INFORMATION ON PROCESSING EDGEMOUNT PARTS TO BOARDS.
  10. -EM3 IS NOT A STANDARD OFFERING; AVAILABLE AS AN ASP ONLY.
  11. NOTE DELETED.
  12. SIDE WALLS ARE RIBBED AS NECESSARY TO CONTROL BOW.
  13. AVAILABLE FOR EXISTING CUSTOMERS ONLY.
  14. ORDERS WILL BE PACKAGED ACCORDING TO THE SAMTEC PACKAGING EFFICIENCY STANDARDS (SPES) FOUND ON [WWW.SAMTEC.COM](http://WWW.SAMTEC.COM).

UNLESS OTHERWISE SPECIFIED, DIMENSIONS ARE IN INCHES. TOLERANCES ARE:  
 DECIMALS ANGLES  
 .XX: ±.01[.3] 2°  
 .XXX: ±.005[.13]  
 .XXXX: ±.0020[.051]

**PROPRIETARY NOTE**  
 THIS DOCUMENT CONTAINS CONFIDENTIAL AND PROPRIETARY INFORMATION AND ALL DESIGN, MANUFACTURING, REPRODUCTION, USE, PATENT RIGHTS AND SALES RIGHTS ARE EXPRESSLY RESERVED BY SAMTEC, INC. THIS DOCUMENT SHALL NOT BE DISCLOSED, IN WHOLE OR PART, TO ANY UNAUTHORIZED PERSON OR ENTITY NOR REPRODUCED, TRANSFERRED OR INCORPORATED IN ANY OTHER PROJECT IN ANY MANNER WITHOUT THE EXPRESS WRITTEN CONSENT OF SAMTEC, INC.

**MATERIAL:** DO NOT SCALE DRAWING SHEET SCALE: 1.375:1  
 INSULATOR: LCP, UL 94V0  
 -EM2 COLOR: BLACK  
 -EM3 COLOR: NATURAL  
 CONTACT & GROUND PLANE: PHOS BRONZE  
 F:\DWG\MISC\MKTG\QSE-XXX-01-X-D-EMX-XX-MKT.SLDDRW

**DESCRIPTION:**  
 .8mm EDGE MOUNT HS SOCKET ASSEMBLY  
 DWG. NO. QSE-XXX-01-X-D-EMX-XX  
 BY: DEAN P 5/24/2000 SHEET 1 OF 3

**PHONE:** 812-944-6733 **FAX:** 812-948-5047  
**e-Mail:** info@SAMTEC.com code 55322

FIG 2

-GP: GUIDE POST  
 (DIFFERENT AS SHOWN, OTHERWISE SAME AS FIG 1)  
 (60 POSITION MAX)  
 (ONLY AVAILABLE WITH -EM2 OPTION)

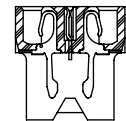
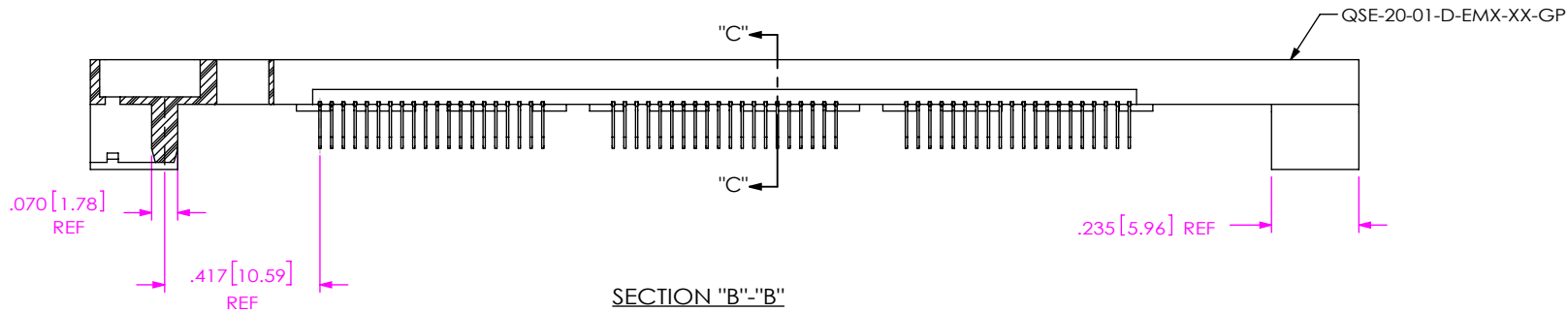
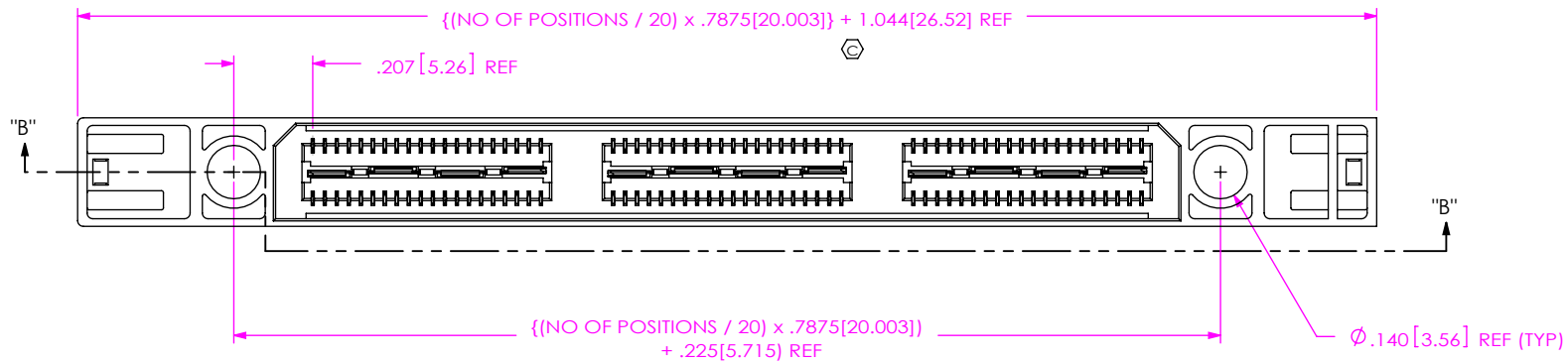

SECTION "C"- "C"

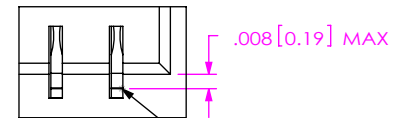

DETAIL "A"  
SCALE 10:1

LINE WHERE ROUNDED TOP OF CONTACT TRANSITIONS TO STRAIGHT BEAM

CRITICAL DIMENSION INSPECTION INSTRUCTION TABLE	
ASSEMBLY OPERATION	IN-PROCESS INSPECTION
FILL C-162-XX-X	C1, C2, C5*, C7, C8
FILL T-1G13-01-X	C6
WHERE APPLICABLE *	
CPCs INTENTIONALLY DELETED: C4*	

**PROPRIETARY NOTE**  
 THIS DOCUMENT CONTAINS CONFIDENTIAL AND PROPRIETARY INFORMATION AND ALL DESIGN, MANUFACTURING, REPRODUCTION, USE, PATENT RIGHTS AND SALES RIGHTS ARE EXPRESSLY RESERVED BY SAMTEC, INC. THIS DOCUMENT SHALL NOT BE DISCLOSED, IN WHOLE OR PART, TO ANY UNAUTHORIZED PERSON OR ENTITY NOR REPRODUCED, TRANSFERRED OR INCORPORATED IN ANY OTHER PROJECT IN ANY MANNER WITHOUT THE EXPRESS WRITTEN CONSENT OF SAMTEC, INC.

DO NOT SCALE DRAWING

SHEET SCALE: 2:1



520 PARK EAST BLVD, NEW ALBANY, IN 47150  
 PHONE: 812-944-6733 FAX: 812-948-5047  
 e-Mail info@SAMTEC.com code 55322

DESCRIPTION:  
 .8mm EDGE MOUNT HS SOCKET ASSEMBLY

DWG. NO.  
 QSE-XXX-01-X-D-EMX-XX

BY: DEAN P 5/24/2000 SHEET 2 OF 3

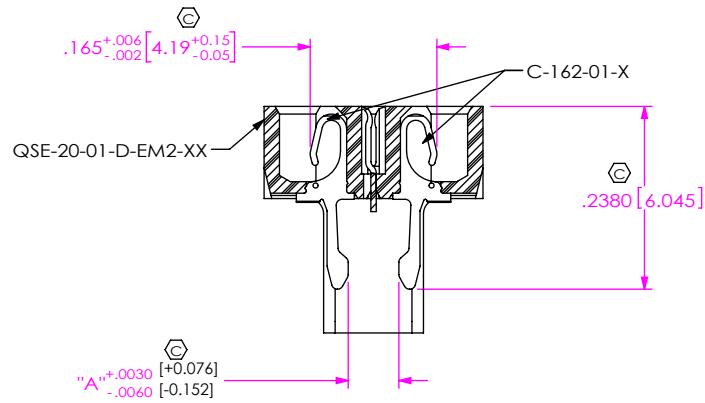

SECTION "A"- "A"  
 .062[1.57] +/- .004 PCB

TABLE 2	
EDGE MOUNT THICKNESS	"A"
-EM2	.0660 [1.676]
-EM3	.0920 [2.338]

**PROPRIETARY NOTE**  
 THIS DOCUMENT CONTAINS CONFIDENTIAL AND PROPRIETARY INFORMATION AND ALL DESIGN, MANUFACTURING, REPRODUCTION, USE, PATENT RIGHTS AND SALES RIGHTS ARE EXPRESSLY RESERVED BY SAMTEC, INC. THIS DOCUMENT SHALL NOT BE DISCLOSED, IN WHOLE OR PART, TO ANY UNAUTHORIZED PERSON OR ENTITY NOR REPRODUCED, TRANSFERRED OR INCORPORATED IN ANY OTHER PROJECT IN ANY MANNER WITHOUT THE EXPRESS WRITTEN CONSENT OF SAMTEC, INC.



520 PARK EAST BLVD, NEW ALBANY, IN 47150  
 PHONE: 812-944-6733 FAX: 812-948-5047  
 e-Mail info@SAMTEC.com code 55322

DO NOT SCALE DRAWING

SHEET SCALE: 2:1

DESCRIPTION:  
 .8mm EDGE MOUNT HS SOCKET ASSEMBLY

DWG. NO.  
**QSE-XXX-01-X-D-EMX-XX**

BY: DEAN P 5/24/2000 SHEET 3 OF 3