

PRODUCT NUMBER	PITCH
V7xxA2x000J0G	7.50 mm

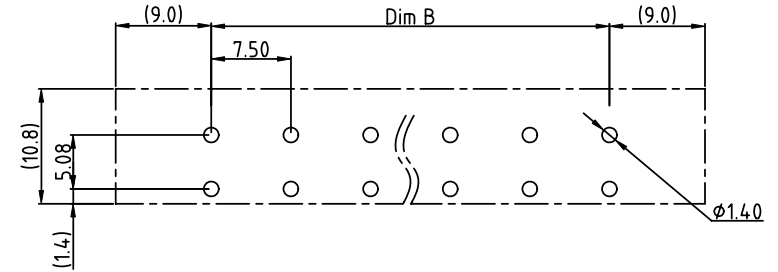

RECOMMENDED P.C.B LAYOUT
TOP VIEW

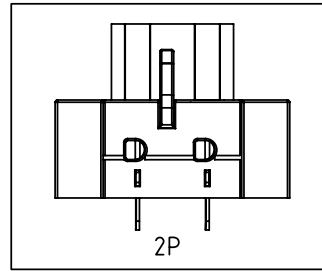
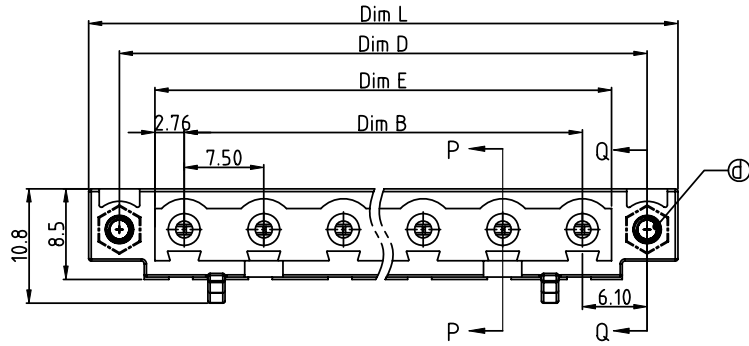
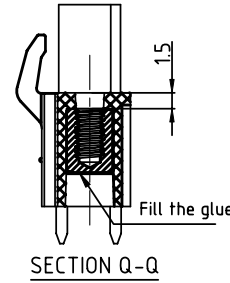
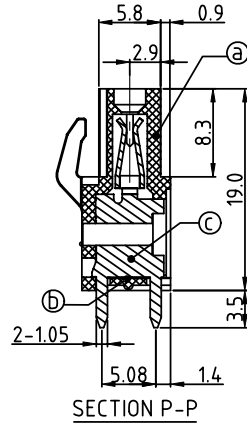
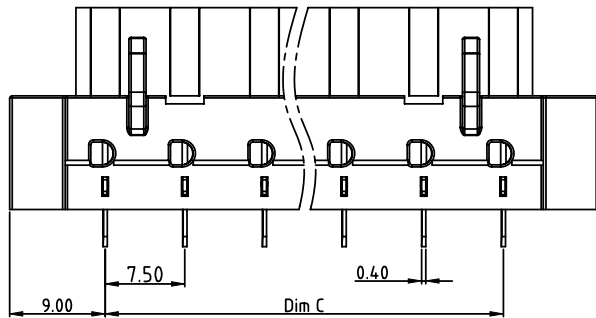

Material:

- Item ① Terminal body: Thermoplastic (UL94V-0)
- Item ② Terminal Cover: Thermoplastic (UL94V-0)
- Item ③ Female contact: PhBz(CuSn), Tin plated
- Item ④ With flange Nut: Brass M 2.5

Electrical cULus

- Voltage rating: 300VAC
- Current rating: 10A
- Withstanding Voltage: 1.6kv
- Operating temperature: -40°C to +115°C
- Soldering temperature: 260°C±5°C/5 Sec
- Safety Approval:

N=Number of poles
 Dim L=(N-1)×7.5+18
 Dim B=(N-1)×7.50
 Dim C=(N-1)×7.50
 Dim D=(N-1)×7.5+12.2
 Dim E=(N-1)×7.5+5.52

poles	Tolerance
2-5p	±0.15
6-10p	±0.25
11-16p	±0.35

PART NO.: V7 xx A 2 x 0 00J0 G

Solid block	0	Black (RAL9005)	RoHS compliant (lead<4%) In copper Alloy
No. of poles	2	Red (RAL3001/D)	
02	2poles	3	Orange(RAL2011/P)
03	3poles	4	Yellow(RAL1018/A)
...	...	5	Green(RAL6018/T)
16	16poles	6	Blue (RAL5015/A)
		8	Grey(RAL7035/D)
		9	White(RAL1102)
		C	Green(RAL6018/U)

mat'l. code		surface ASME Y14.5	tolerance ASME Y14.5	projection 	product family TERMINAL BLOCK
ltr	ecn no	dr	date	tolerances unless otherwise specified	title TERMINAL BLOCK
				angles X±0.5	PLUGGABLE PCB PLUG, WITH FLANGE, VERTICAL
				flatness X.X±0.3	scale MM
				total run out X.XX±0.1	dwg no V7xxA2x000J0G
		dr	EVIN ZHONG	043014	sheet 1 of 1 size A4
		enr	EVIN ZHONG	043014	FCI type CUSTOMER Drawing
		chr	HANKE FENG	043014	
		appd	SHI JUN	043014	
sheet index	revision	A			
	sheet	1			