

PT Series

- Large size for PCB board mounting hole type
- Load life 4,000 hours at 105°C



◆ SPECIFICATIONS

Item	Performance Characteristics			
Category Temperature Range	-25 ~ +105°C			
Working Voltage Range	200 ~ 400Vdc			
Capacitance Range	68 ~ 1,000μF			
Capacitance Tolerance	±20% (at 25°C and 120Hz)			
Dissipation Factor (tanδ) (at 25°C, 120Hz)	Rated Voltage (V)	200	250	400
	tanδ(Max)	0.15	0.15	0.20
Leakage Current	I=0.02CV or 3000μA, whichever is smaller I : Leakage current (μA) C : Rated capacitance (μF) V : Rated voltage (V) Impress the rated voltage for 5 minutes			
Low Temperature Characteristics Impedance Ratio(MAX)	Rated voltage (V)	200~250	400	(at 120Hz)
	Z(-25°C)/Z(+20°C)	4	4	
Endurance	The following specifications shall be satisfied when the capacitors are restored to 25°C after subjected to DC voltage with the rated ripple current is applied for 4,000 hours at 105°C.			
	Capacitance change	≅ ±20% of the initial value		
	Dissipation factor(tanδ)	≅ 200% of the specified value		
	Leakage current	≅ specified value		
Shelf Life	The following requirements shall be satisfied when the capacitor are restored to 25°C after exposing them for 1,000 hours at 105°C without voltage applied.			
	Capacitance change	≅ ±20% of the initial value		
	Dissipation factor(tanδ)	≅ 200% of the specified value		
	Leakage current	≅ 200% of the specified value		
Others	Conforms to JIS-C-5101-4 (1998), characteristic W			

◆ DIMENSIONS (mm)

Terminal Code : ND : Standard

Terminal Code :K6 (ø35)

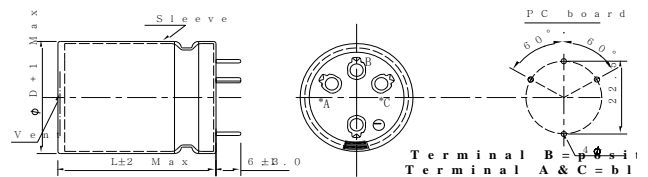
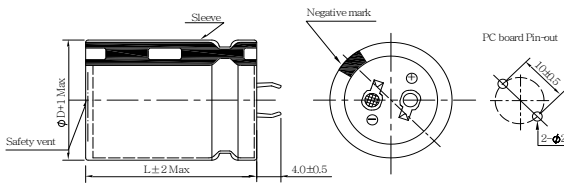

◆ PART NUMBER SYSTEM(Example : 250V 330μF)

P T 2 E 3 3 1 M N D 2 2 4 5

Special Request

Size code(2245 : 22×45)

Terminal length code

Lead forming Type code

Capacitance tolerance code(M: ±20%)

Capacitance code (330μF)

Voltage code (250V)

Series code (PT)

Aluminum Electrolytic Capacitor

Customer	Digi-Key	SERIES	PT	NO.:	PUBLISH DATE	2022-03-25
-----------------	-----------------	---------------	-----------	-------------	---------------------	-------------------

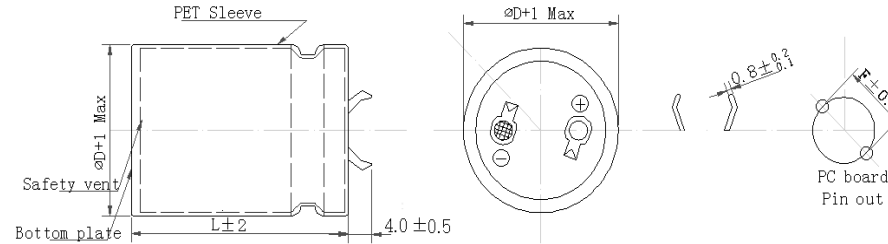

No.	CHINSAN Part No.	Customer Part No.	Capacitance (uF)	Tolerance On rated Capacitance (%)	Working Voltage (Vdc)	Surge Voltage (Vdc)	Category Temp Range (°C)	Tan δ @ 25°C (120Hz) (Max)	Leakage Current (uA) (2 min.)	Rated Ripple Current (mA rms) @ 105°C 120Hz	Rated Ripple Current (mA rms) @ 105°C 100kHz	ESR @ 25°C (m Ω max/ 120Hz)	Impedance @ 20°C (m Ω max/ 100kHz)	Endurance @ 105°C (Hours)	Dimensions (mm)					Appearance Drawing No
															D Φ	L	a	d	F	
1	PT2G561MND3545	/	560 μ F	$\pm 20\%$	400 V	/	-25~+105	/	/	1400	/	/	/	4000	35	45	/	/	10	---

※ Test leakage current before testing dissipation factor and capacitance during the electric characteristic test.

REMARKS:	APPROVED BY	CHECKED BY	PREPARED BY
Sleeve Color: Black.	张洪斌	曾爱娥	梁慧妍