

## Base strip - PC 4/ 6-G-7,62 - 1804836

Please be informed that the data shown in this PDF Document is generated from our Online Catalog. Please find the complete data in the user's documentation. Our General Terms of Use for Downloads are valid (<http://download.phoenixcontact.com>)



Header, Nominal current: 20 A, Rated voltage (III/2): 630 V, Number of positions: 6, Pitch: 7.62 mm, Color: green, Contact surface: Tin, Assembly: Soldering, Mounting flange: Accessory Order No. 1827570

The figure shows a 5-pos. version of the product

### Why buy this product

- PCB-SHIELD shroud for a professional EMC shield connection
- Vibration-resistant connection by means of separate BF-PC 4 mounting flanges (also for screw connection in the device)
- PC 4 headers for use in combination with all PC 4 plugs
- CP-PC RD keying profiles as protection against mismatching



### Key commercial data

|                        |   |
|------------------------|---|
| Packing unit           | 1   |
| Minimum order quantity | 50  |
| Catalog page           | Page 422 (CC-2011)  |
| GTIN                   | <br>4 017918 046279 |
| Custom tariff number   | 85366990  |
| Country of origin      | GERMANY   |

### Technical data

#### Dimensions / positions

|                     |            |
|---------------------|------------|
| Length              | 29 mm      |
| Pitch               | 7.62 mm    |
| Dimension a         | 38.1 mm    |
| Number of positions | 6          |
| Pin dimensions      | 1 x 0,8 mm |
| Hole diameter       | 1.3 mm     |

#### Technical data

|                             |           |
|-----------------------------|-----------|
| Range of articles           | PC 4/..-G |
| Insulating material group   | I         |
| Rated surge voltage (III/3) | 6 kV      |

## Base strip - PC 4/ 6-G-7,62 - 1804836

### Technical data

#### Technical data

|   |        |
|---|--------|
| Rated surge voltage (III/2)             | 6 kV   |
| Rated surge voltage (II/2)              | 6 kV   |
| Rated voltage (III/2)                   | 630 V  |
| Rated voltage (II/2)                    | 630 V  |
| Connection in acc. with standard        | EN-VDE |
| Nominal current I <sub>N</sub>          | 20 A   |
| Nominal voltage U <sub>N</sub>          | 400 V  |
| Maximum load current                    | 20 A   |
| Insulating material                     | PA     |
| Inflammability class according to UL 94 | V0     |
| Color                                   | green  |
| Nominal voltage, UL/CUL Use Group B     | 300 V  |
| Nominal current, UL/CUL Use Group B     | 20 A   |
| Nominal voltage, UL/CUL Use Group C     | 300 V  |
| Nominal current, UL/CUL Use Group C     | 20 A   |

### Classifications

#### ETIM

|          |          |
|----------|----------|
| ETIM 3.0 | EC001121 |
| ETIM 4.0 | EC002637 |
| ETIM 5.0 | EC002637 |

#### UNSPSC

|               |          |
|---------------|----------|
| UNSPSC 11     | 39121409 |
| UNSPSC 12.01  | 39121409 |
| UNSPSC 13.2   | 39121409 |
| UNSPSC 6.01   | 30211810 |
| UNSPSC 7.0901 | 39121409 |

#### eCl@ss

|            |          |
|------------|----------|
| eCl@ss 4.0 | 272607xx |
| eCl@ss 4.1 | 27260701 |
| eCl@ss 5.0 | 27260701 |
| eCl@ss 5.1 | 27260701 |
| eCl@ss 6.0 | 27260704 |
| eCl@ss 7.0 | 27440402 |

### Approvals

#### Approvals

# Base strip - PC 4/ 6-G-7,62 - 1804836

## Approvals

Approvals

CSA / UL Recognized / cUL Recognized / GOST / LR / GL / BV / DNV / RS / GOST / cULus Recognized

Ex Approvals

Approvals submitted

## Approval details

|   |       |       |
|---|-------|-------|
| CSA  |       |       |
|   | B     | C     |
| Nominal current IN  | 20 A  | 20 A  |
| Nominal voltage UN  | 300 V | 300 V |

|   |       |       |
|---|-------|-------|
| UL Recognized  |       |       |
|   | B     | C     |
| Nominal current IN  | 20 A  | 20 A  |
| Nominal voltage UN  | 300 V | 300 V |

|  |       |       |
|--|-------|-------|
| cUL Recognized  |       |       |
|  | B     | C     |
| Nominal current IN   | 20 A  | 20 A  |
| Nominal voltage UN   | 300 V | 300 V |

|  |  |  |
|--|--|--|
| GOST  |  |  |
|--|--|--|

|                    |       |
|--------------------|-------|
| LR                 |       |
|                    |       |
| Nominal current IN | 20 A  |
| Nominal voltage UN | 400 V |

# Base strip - PC 4/ 6-G-7,62 - 1804836

## Approvals

|                                |       |
|--------------------------------|-------|
| GL                             |       |
|                                |       |
| Nominal current I <sub>N</sub> | 20 A  |
| Nominal voltage U <sub>N</sub> | 400 V |

BV

DNV

RS

GOST

cULus Recognized

## Accessories

Accessories

Assembly

Accessories - BF-PC 4 - 1827570



Mounting flange, is snapped onto the left and right of the headers, for screw connection with PC 4/...-STF-7.62

## Marking

Marker cards - SK 7,62/3,8:FORTL.ZAHLEN - 0804549



Marker cards, Card, white, labeled, Horizontal: Consecutive numbers 1 - 10, 11 - 20, etc. up to 91 - 100, Mounting type: Adhesive, For terminal block width: 7.62 mm

## Base strip - PC 4/ 6-G-7,62 - 1804836

### Accessories

Marker cards - SK U/3,8 WH:UNBEDRUCKT - 0803906



Marker cards, Sheet, white, Unlabeled, Can be labeled with: Plotter, Office-Drucksysteme, Mounting type: Adhesive

Marker pen - B-STIFT - 1051993



Marker pen, for manual labeling of unprinted Zack strips, smear-proof and waterproof, line thickness 0.5 mm

### Plug/Adapter

Coding profile - CP-HCC 4 - 1600027



Coding profile, Color: red

### Additional products

Printed-circuit board connector - PC 4 HV/ 6-STF-7,62 - 1880119



Plug component, Nominal current: 20 A, Rated voltage (III/2): 1000 V, Number of positions: 6, Pitch: 7.62 mm, Connection method: Screw connection, Color: green, Contact surface: Tin

Printed-circuit board connector - PC 4/ 6-STF-7,62 - 1828281



Plug component, Nominal current: 20 A, Rated voltage (III/2): 630 V, Number of positions: 6, Pitch: 7.62 mm, Connection method: Screw connection, Color: green, Contact surface: Tin

# Base strip - PC 4/ 6-G-7,62 - 1804836

## Accessories

### Printed-circuit board connector - PCC 4/ 6-ST-7,62 - 1840159



Plug component, Nominal current: 20 A, Rated voltage (III/2): 1000 V, Number of positions: 6, Pitch: 7.62 mm, Connection method: Crimp connection, Color: green, Corresponding female crimp contacts with current [A] and conductor cross section range [mm<sup>2</sup>] data: 13,5A/STG-MTN 0,5-1,0 (3190438); 13,5A/STG-MTN 0,5-1,0 BA (3190629); 20A/STG-MTN 1,5-2,5 (3190506); 20A/STG-MTN 1,5-2,5 BA (3190632). BA = Taped contacts

### Printed-circuit board connector - PC 4/ 6-ST-7,62 - 1804946



Plug component, Nominal current: 20 A, Rated voltage (III/2): 630 V, Number of positions: 6, Pitch: 7.62 mm, Connection method: Screw connection, Color: green, Contact surface: Tin

## Drawings

### Drilling diagram

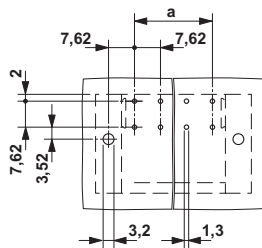

### Dimensioned drawing

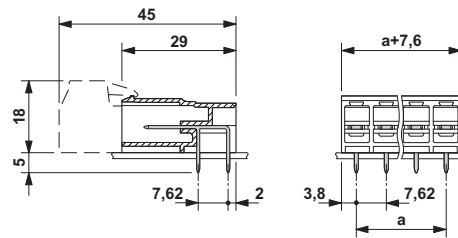

## Base strip - PC 4/ 6-G-7,62 - 1804836

Diagram

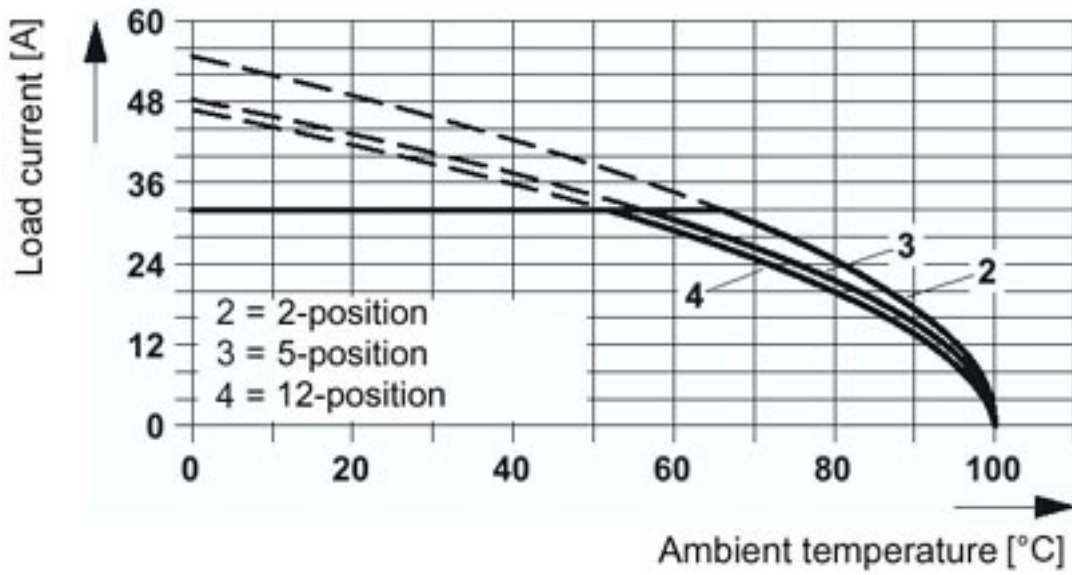

The illustration shows the derating curve for plugs PC 5/...-ST-7,62 in combination with header PC 4/...-G-7,62.