

# Push Buttons and Operator Interface Specifier's Guide

## Type XB2B 22 mm Diecast Chrome Plated

File 9001



### CONTENTS

Description .....	Page
General Characteristics .....	314
Non-Illuminated Operators .....	315
Mushroom Operators and Yellow Contrast Plates .....	317
Two Button Operators .....	319
Specialty Operators .....	320
Reset Operators .....	321
Contact Blocks .....	322
Pilot Lights and Light Modules .....	323
Illuminated Operators .....	324
Light Module Assemblies .....	328
Specialty Light Modules .....	330
Accessories and Replacement Parts .....	331
Legend Plates .....	333
Dimensions .....	334
XB2B 22 mm Mounting Instructions .....	336
Declaration of Conformity .....	350



*Schneider Electric Brands*



**SQUARE D**  
Schneider Electric

# Push Buttons and Operator Interface Specifiers Guide

## XB2B 22 mm General Characteristics



### Environment

Conformity to standards	XB2B, XD2P: UL 508, IEC 60947-5-1, EN60947-5-1, IEC 60337-1, IEC 60337-2, NF C 63-140, ASE 0119, ASE1003, BS 4794, VDE 0660-200, CSA C 22-2 No. 14, CSA C 22-2 No. 66
Approvals	<b>UL:</b> push buttons and selector switches NEMA / UL Type A600-Q600; pilot lights and illuminated push buttons direct supply (120 V max.); pilot lights and illuminated push buttons with transformer (600 V) <b>CSA:</b> push buttons and selector switches NEMA / UL Type A600-Q600. pilot lights and illuminated push buttons direct supply (120 V max.); pilot lights and illuminated push buttons with transformer (600 V). ASE, DEMKO, NEMKO, SEMKO, BUREAU VERITAS, SAHKOTARKASTUSKESKUS, GL, DNV, LROS <b>XD2P</b> , standard version: CSA A600-Q600, LROS.
Protective treatment	Standard version: TC "All climates"
Ambient temperature	Operating: -25 °C to +70 °C (-13 °F to +158 °F) Storage: -40 °C to +70 °C (-40 °F to +158 °F)
Resistance to vibration	60 mm diameter mushroom head: 8 g. Other push buttons: 15 g. Small joystick controllers: 5 g (from 40 to 50 Hz) Conforming to IEC 60068-2-6.
Resistance to shock	Push buttons: 70 g. Mushroom head push-buttons: 15 g. Selector switches: 200 g. Conforming to IEC 60068-2-27.
Protection against electric shock	<b>XB2B, XD2P:</b> Class 1, conforming to IEC 60536 and NF C 20-030.
Degree of protection conforming to IEC 60529 and NF C 20-010	NEMA / UL ratings XB2B: 1, 2, 3, 4, 4X, 12K, 13, XB2B, XD2P: IP 65: flush and protecting, illuminated and non-illuminated push buttons (mounted). IP 66: booted and mushroom head push buttons, selector switches, pilot lights and small joystick controllers (mounted). IP 40: double-headed push buttons (IP 65 on request).
Mechanical life	Push buttons—3 million operations (Latching mushroom head push buttons: 300,000 operations. Illuminated selector switches: 100,000 operations). The product life expressed is based on average usage and normal operating conditions. Actual operating life will vary with conditions. The above statements are not intended to nor shall they create any express or implied warranties as to product operation or life. For information on the limited warranty offered on this product, please refer to Square D terms and conditions of sale found in the Square D Digest.

### Contact block characteristics

Nominal thermal current	10 A conforming to IEC 60947-5-1, NF C 63-140, UL 508, CSA 22-2 No. 14, VDE 0660 part 2, NEMA / UL Type A600-Q600.
Nominal insulation voltage	500 V conforming to NF C 20-040, VDE 0110, IEC 60158-1, 600 V conforming to UL 508, 600 V conforming to CSA 22-2 No. 14.
Insulation category	Group C conforming to NF C 20-040 and VDE 0110.
Contact operation	Slow-make N.O. or slow-break N.C. with direct opening operation conforming to EN60947-5-1 section 3.
Contact resistance	0.25 mΩ conforming to: NF C 93-050 method A or IEC 60225-7 category 3.
Operating force	Flush or projecting push buttons - with 1 NO contact: 2.25 lb - with 1 NC contact: 1.8 lb Additional contacts - N.O.: add 1 lb - N.C.: add 0.7 lb.
Terminal referencing	Conforming to CENELEC EN 50013.
Short circuit protection	10 A cartridge fuses, GI or N conforming to IEC 60269-1 and VDE 0660-200.

Rated power conforming to IEC 60947-5-1 Appendix C duty categories AC11-DC11  
Operating frequency: 3,600 ops/hour  
Load factor: 0.5  
AC supply (50-60 Hz)

### DC supply

Power broken in watts for 1 million operations

Voltage	24 V	48 V	120 V
Inductive load	65 W	48 W	40 W



File E164353  
CCN NKCR



File LR 44087  
Class 3211 03



Marking

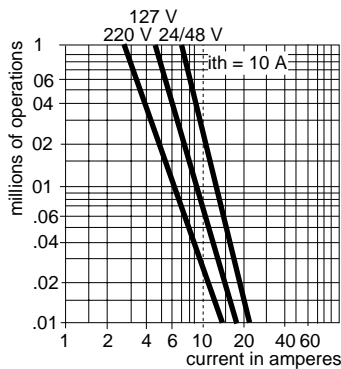

### AC Ratings, Inductive - NEMA / UL A600

Volts	Make Amperes	35% Power factor		Continuous carrying Amperes	Resistive 75% Power factor Make, Break and continuous Amperes
		VA	Break Amperes		
120	60	7200	6	720	10
240	30	7200	3	720	10
480	15	7200	1.5	720	10
600	12	7200	1.2	720	10

### DC Ratings, NEMA / UL Type Q600

Inductive and resistive		
Volts	Make and break	Continuous
125	0.55	2.5
250	0.27	2.5
600	0.10	2.5

Cabling	<b>XB2B, XD2P:</b> Screw and captive clamp terminals. Recommended torque 15.62 lb-in. Capacity: minimum 1 x 0.5 mm <sup>2</sup> (20 AWG) solid or stranded, maximum with or without cable end: 2 x 1.5 mm <sup>2</sup> (16 AWG) or 1 x 2.5 mm <sup>2</sup> (14 AWG) or by quick connector conforming to NF C 20-120 (on request).
---------	---



**Operator**

**Flush head  
ZB2BA•**

Type	Color	Catalog Number
Flush head	White	ZB2BA1
	Black	ZB2BA2
	Green	ZB2BA3
	Red	ZB2BA4
	Yellow	ZB2BA5
	Blue	ZB2BA6
	Grey	ZB2BA8

**Metallic flush head  
ZB2BA•9**

Flush head premarked	White "I"	ZB2BA131
	Black "START"	ZB2BA230
	Black "O"	ZB2BA232
	Green "I"	ZB2BA331
	Red "O"	ZB2BA432
	Green "START"	ZB2BA333
	Green "ON"	ZB2BA341

**Transparent flush head  
ZB2BA•8**

Metallic flush head (metal pusher)	Red "STOP"	ZB2BA434
	Red "OFF"	ZB2BA435
	Black	ZB2BA29

**Guarded head  
ZB2BA•6**

Transparent flush head Use with mylar circular legend (ZB2BY1●●●) See page 333	Green	ZB2BA39
	Red	ZB2BA49
	Yellow	ZB2BA59
	Green	ZB2BA38
	Red	ZB2BA48
	Amber	ZB2BA58
	Blue	ZB2BA68
	Clear	ZB2BA78
	White	ZB2BA16
	Black	ZB2BA26

Guarded head	Green	ZB2BA36
	Red	ZB2BA46
	Yellow	ZB2BA56
	Blue	ZB2BA66
	White	ZB2BA16

**Operating heads with black metal bezel**

To order, add suffix 7 to the above references (except ZB2BP2 TO ZB2BP6).  
Example: ZB2BA2 becomes ZB2BA27.

Contact Block Assemblies .....	Page 322
Specialty Contacts .....	Page 329
Application Information .....	Page 314
Legend Plates .....	Page 333
Accessories .....	Page 331
Replacement Parts .....	Page 332
Dimensions .....	Pages 334-335

# Push Buttons and Operator Interface Specifiers Guide

## XB2B 22 mm Non-Illuminated Operators



### Operator



Extended head  
ZB2BL•



Extended head  
marked stop  
ZB2BL434



Silicon booted head  
ZB2BP•

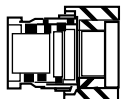

Flush with reinforced  
protection  
ZB2BA•5

Type	Color	Catalog Number	
Extended head	White	ZB2BL1	
	Black	ZB2BL2	
	Green	ZB2BL3	
	Red	ZB2BL4	
	Yellow	ZB2BL5	
	Blue	ZB2BL6	
Extended head premarked	Red "O"	ZB2BL432	
	Red "STOP"	ZB2BL434	
	Red "OFF"	ZB2BL435	
Silicon booted head	Black	ZB2BP2	
	Green	ZB2BP3	
	Red	ZB2BP4	
	Yellow	ZB2BP5	
	Blue	ZB2BP6	
	Neoprene booted head	Black	ZB2BP02
Green		ZB2BP03	
Red		ZB2BP04	
Yellow		ZB2BP05	
Blue		ZB2BP06	
White		ZB2BA15	
Black		ZB2BA25	
Green		ZB2BA35	
Red		ZB2BA45	
Yellow		ZB2BA55	
Flush with reinforced dust, damp, and cutting oil protection	Blue	ZB2BA65	
	Green	ZB2BP38	
	Red	ZB2BP48	
	Yellow	ZB2BP58	
	Blue	ZB2BP68	
	Clear	ZB2BP78	
	Transparent silicon booted push button Use with mylar circular legend (ZB2BY1●●●) See page 333.	Green	ZB2BP38
		Red	ZB2BP48

### Operating heads with black metal bezel

To order, add suffix 7 to the above references (except ZB2BP2 TO ZB2BP6 and ZB2BP02 TO ZB2BP06).  
Example: ZB2BL2 becomes ZB2BL27.

Contact Block Assemblies . . . . .	Page 322
Specialty Contacts . . . . .	Page 329
Application Information . . . . .	Page 314
Legend Plates . . . . .	Page 333
Accessories . . . . .	Page 331
Replacement Parts . . . . .	Page 332
Dimensions . . . . .	Pages 334-335



**Mushroom head 40mm  
ZB2BC**



**Mushroom head 60mm  
ZB2BR**



**Mushroom head  
key release  
ZB2BS4**



**Mushroom head  
turn to release  
ZB2BS54**



**Mushroom head  
with trigger action  
turn to release  
ZB2BS844**



**ZB2BY8330**

**Operator**

Type	Size	Color	Catalog Number
Mushroom head Momentary	30mm	Black	ZB2BC24
		Green	ZB2BC34
		Red	ZB2BC44
		Yellow	ZB2BC54
		Blue	ZB2BC64
	40mm	Black	ZB2BC2
		Green	ZB2BC3
		Red	ZB2BC4
		Yellow	ZB2BC5
		Blue	ZB2BC6
	60mm	Black	ZB2BR2
		Green	ZB2BR3
Red		ZB2BR4	
Yellow		ZB2BR5	
Mushroom head Key release★	40mm	Red	ZB2BS14
	60mm	Red	ZB2BS24
Mushroom head push button with trigger action◆ Key release★	40mm	Red	ZB2BS944
Mushroom head turn to release	40mm	Red	ZB2BS54
Premarked "EMO"	40mm	Red	ZB2BS5430
Mushroom head push button with trigger action◆ Turn to release	40mm	Red	ZB2BS844
Mushroom head turn to release	60mm	Red	ZB2BS64
Mushroom head push-pull	40mm	Black	ZB2BT2
Premarked "EMERGENCY STOP"	40mm	Red	ZB2BT4
	40mm	Red	ZB2BT43
Mushroom head push-pull	60mm	Black	ZB2BX2
	60mm	Red	ZB2BX4

★ Key release operators come with Ronis #455 keys (quantity 2) as standard. For replacement keys see page 332. For other key numbers contact local field office.

◆ Trigger action mushroom heads are "tamper proof" whereby a change of contact state is not possible by "teasing" or floating the operator.

**Guards / Locks**

Type	Size	Color	Catalog Number
Metal	40 mm with finger cutout and 7 mm holes for padlocking	Red	ZB2BZ1804
Plastic	60 mm (for 40 mm turn to release)	Yellow	ZB2BZ1905

**Yellow Contrast Plates**

**PVC Yellow Legend Plates 60 mm diameter**

Text	Language	Catalog Number
Blank	N/A	ZB2BY9101
Emergency Stop	English	ZB2BY9330
Arret d'Urgence	French	ZB2BY9130
Not Aus	German	ZB2BY9230
Parada de Emergencia	Spanish	ZB2BY9430
Arresto Emergenza	Italian	ZB2BY9630

**PVC Yellow Legend Plates 90 mm diameter**

Text	Language	Catalog Number
Blank	N/A	ZB2BY8101
Emergency Stop	English	ZB2BY8330
Arret d'Urgence	French	ZB2BY8130
Not Aus	German	ZB2BY8230
Parada de Emergencia	Spanish	ZB2BY8430
Arresto Emergenza	Italian	ZB2BY8630

Contact Block Assemblies . . . . . Page 322  
 Specialty Contacts . . . . . Page 329  
 Application Information . . . . . Page 314  
 Legend Plates . . . . . Page 333  
 Accessories . . . . . Page 331  
 Replacement Parts . . . . . Page 332  
 Dimensions . . . . . Pages 334-335



# Push Buttons and Operator Interface Specifiers Guide

## XB2B 22 mm Lever and Key Operators



Standard lever  
ZB2BD\*\*\*



Extended lever ★  
ZB2BJ\*\*\*

### Lever Operators

Type	Number of positions, actions	Lever Color	Catalog Number
Standard or Extended lever ★	2-maintained	Black	ZB2BD2
		White	ZB2BD201
		Red	ZB2BD204
	2-spring return from right to left	Black	ZB2BD4
		White	ZB2BD401
		Red	ZB2BD404
	3-maintained	Black	ZB2BD3
		White	ZB2BD301
		Red	ZB2BD304
	3-spring return to center from left and right	Black	ZB2BD5
		White	ZB2BD501
		Red	ZB2BD504
	3-spring return from right to center	Black	ZB2BD8
		White	ZB2BD801
		Red	ZB2BD804
	3-spring return from left to center	Black	ZB2BD7
		White	ZB2BD701
		Red	ZB2BD704

### Key Operators

Type	Number of positions, actions, key removal	Catalog Number
Key switch ♦	2-maintained key removal from left	ZB2BG2
	2-maintained key removal from left or right	ZB2BG4
	2-spring return from right to left, key removal from left	ZB2BG6
	3-maintained key removal from center	ZB2BG3
	3-maintained key removal from left and right	ZB2BG5
	3-maintained key removal from left	ZB2BG9
	3-maintained key removal from all positions	ZB2BG0
	3-spring return left or right to center, key removal from center	ZB2BG7
	3-spring return left to center key removal right	ZB2BG1
	3-spring return right to center key removal center	ZB2BG8
	3-spring return right to center key removal left	ZB2BG08



Key switch  
ZB2BG\*\*

### Selector Switch Sequences (using contact block assemblies, page 322)

2 Position selector switch			Contact block guide
↖	↗		1 N.O. (left or right)
O	X		1 N.C. (left or right)
O	X		1 N.O. and 1 N.C.
X	O		

Note: View from front of panel

3 Position selector switch			Contact block guide
↖	↑	↗	1 N.O. (left)
X	O	O	2 NC wired in series (side-by-side)
O	X	O	1 N.O. (right)
X	X	O	1 N.C. (right)
O	X	X	1 N.C. (left)
X	O	X	2 NO wired in parallel (side-by-side)

### Operating heads with black metal bezel

To order, add suffix 7 to the above references.  
Example: ZB2BD3 becomes ZB2BD37.

- ★ When ordering extended lever substitute J for D. Example: ZB2BD2 becomes ZB2BJ2.
- ♦ Key selector switches come with Ronis #455 keys (quantity 2) as standard. For replacement keys see page 332. For switches keyed with different keys, add the suffixes shown in the table below (no change in price). For other key numbers contact local field office.

Key Number	Suffix
421	12
458A	10
520	14
3131A	20

Contact Block Assemblies	Page 322
Specialty Contacts	Page 329
Application Information	Page 314
Legend Plates	Page 333
Accessories	Page 331
Replacement Parts	Page 332
Dimensions	Pages 334-335



**Momentary operators**



**Two flush  
ZB2BA9\*\***



**One flush, one extended  
ZB2BL94\*\***

Type	Marked ♦	Color	Catalog Number
Two flush		Black/Red	ZB2BA9124
		Green/Red	ZB2BA9134
	I,O	Black/Red	ZB2BA9224
		Green/Red	ZB2BA9234
		Black/Red	ZB2BA9724
One flush, one extended		Black/Red	ZB2BL9324
		Green/Red	ZB2BL9334
	I,O	Black/Red	ZB2BL9424
		Green/Red	ZB2BL9434
		Black/Red	ZB2BL9824
	Green/Red	ZB2BL9834	

♦ Additional markings available on special order. Contact local field office for details.

**Operating heads with black metal bezel**

To order, add suffix **7** to the above references.  
Example: **ZB2BA9124** becomes **ZB2BA91247**.



**Start/stop  
ZB2BL98\*\***

**2 Button maintained operators**

Type	Number of contact(s)	Button 1	Button 2	Catalog Number
Flush interlocked push buttons (30 mm centers, maintained, mechanically interlocked) Units include contact block(s) as shown.	1	NO-Black	Black	XB2BF521
	1	NO-Black	Red	XB2BF551
	1	NO-Green	Red	XB2BF581
	2	NO-Black	NO-Black	XB2BF523
	2	NO-Black	NO-Red	XB2BF553
	2	NO-Green	NO-Red	XB2BF583
	2	NO-Black	NO-Black	XB2BF525
	2	NO-Black	NC-Red	XB2BF555
	2	NO-Green	NC-Red	XB2BF585

Type	Color	Catalog Number
Replacement push button operators only (with no spring return in head) for XB2BF	Black	ZB2BAW80424194002
	Green	ZB2BAW80424194003
	Red	ZB2BAW80424194004

**Operating heads with black metal bezel**

To order, add suffix **7** to the above references.  
Example: **ZB2BF521** becomes **ZB2BF5217**.

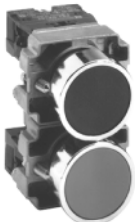

**Interlocked  
XB2BF5\*\***

Contact Block Assemblies ..... Page 322  
 Specialty Contacts ..... Page 329  
 Application Information ..... Page 314  
 Legend Plates ..... Page 333  
 Accessories ..... Page 331  
 Replacement Parts ..... Page 332  
 Dimensions ..... Pages 334-335



# Push Buttons and Operator Interface Specifiers Guide

## XB2B 22 mm Specialty Operators



Wobble sticks



Potentiometer operator



Joysticks

### Operators

Type	Color	Catalog Number
Wobble sticks	Black	ZB2BB2
	Red	ZB2BB4
Potentiometer operator ♦	Black	ZB2BD922
Joysticks* Contacts supplied	2-maintained	XD2PA12
	2-spring return	XD2PA22
	4-maintained	XD2PA14
	4-spring return	XD2PA24

- \* Units come with 1 N.O. contact in each direction. Screw terminals. Contact blocks cannot be added or removed from the above arrangements. For other requirements, contact local sales office.
- ♦ Customer to supply potentiometer, unit accepts 1/4" diameter, 1.625" (43-47 mm) length shaft potentiometer.

2 Position

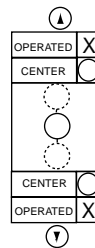

4 Position

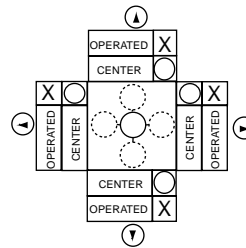

These 2 direction and 4 direction position charts are viewed from behind the panel, thereby reversing east and west positions. When lever is moved away from center, only one contact changes from N.O. to N.C. The other contact blocks in the switch are unaffected.

### Two step push buttons (contacts supplied)

Type	Contact 1st step	Contact 2nd step	Catalog Number
Flush head	N.O.	N.O.	XB2BA●41
	N.O.	N.C.	XB2BA●42
	N.O.+N.C.	N.O.	XB2BA●43
	N.O.+N.C.	N.O.+N.C.	XB2BA●44

- Replace ● with desired color head. (1-white, 2-black, 3-green, 4-red, 5-yellow, 6-blue).

### Two position toggle switch (maintained)

Type	Color	Catalog Number
Two position toggle switch NEMA Type 1 only	Black	ZB2BD28

### Operating heads with black metal bezel

To order, add suffix 7 to the above references.  
Example: **ZB2BD922** becomes **ZB2BD9227**.

Contact Block Assemblies .....	Page 322
Specialty Contacts .....	Page 329
Application Information .....	Page 314
Legend Plates .....	Page 333
Accessories .....	Page 331
Replacement Parts .....	Page 332
Dimensions .....	Pages 334-335





**Reset operators**



**XB2BA8**

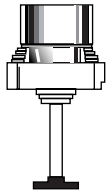

**XB2BA9**  
30 to 82 mm

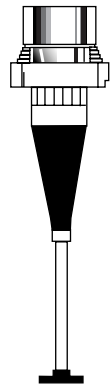

**XB2BA9**  
80 to 257 mm

Type	Description	Adjustable length of rod	Color	Catalog Number
Flush head	0.39" (10 mm) Travel Panel thickness: 0.04" - 0.12" (1-3 mm) Tightened by nut	0.24" - 0.63" (6 - 16 mm)	Black	XB2BA821
			Red	XB2BA841
			Blue	XB2BA861
		0.63" - 1.02" (16 - 26 mm)	Black	XB2BA822
			Red	XB2BA842
			Blue	XB2BA862
	0.55" (14 mm) Travel Panel thickness: 0.04" - 0.23" (1-6 mm) Tightened by 2 screw mounting base (supplied)	1.18" - 2.25" (30 - 57 mm)	Black	XB2BA921
			Red	XB2BA941
			Blue	XB2BA961
		2.16" - 3.23" (55 - 82 mm)	Black	XB2BA922
			Red	XB2BA942
			Blue	XB2BA962
	0.55" (14 mm) Travel Panel thickness: 0.04" - 0.23" (1-6 mm) Tightened by 2 screw mounting base (supplied)	3.15" - 4.2" (80 - 107 mm)	Black	XB2BA923
			Red	XB2BA943
			Blue	XB2BA963
		4.13" - 5.2" (105 - 132 mm)	Black	XB2BA924
			Red	XB2BA944
			Blue	XB2BA964
		5.12" - 6.18" (130 - 157 mm)	Black	XB2BA925
			Red	XB2BA945
			Blue	XB2BA965
		6.1" - 7.16" (155 - 182 mm)	Black	XB2BA926
			Red	XB2BA946
			Blue	XB2BA966
7.08" - 8.15" (180 - 207 mm)	Black	XB2BA927		
	Red	XB2BA947		
	Blue	XB2BA967		
8.07" - 9.13" (205 - 232 mm)	Black	XB2BA928		
	Red	XB2BA948		
	Blue	XB2BA968		
9.05" - 10.1" (230 - 257 mm)	Black	XB2BA929		
	Red	XB2BA949		
			Blue	XB2BA969

**Operating heads with black metal bezel**

To order, add suffix **7** to the above references.

Example: **ZB2BA944** becomes **ZB2BA9447**.

Limited Availability  
For replacement use only  
For new applications use page 37 - 72

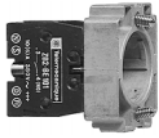

ZB2BZ101



ZB2BE10



ZB2BZ009

Mounting base with contact block(s) "Screw clamp connection"

Type	Contacts		N.O.	N.C.	Catalog Number
	N.O.	N.C.			
1 Contact Block	1	-			ZB2BZ101
	-	1			ZB2BZ102
2 Contact Blocks	2	-			ZB2BZ103
	-	2			ZB2BZ104
	1	1			ZB2BZ105
Additional contact blocks					
Type	Contacts		N.O.	N.C.	Catalog Number
	N.O.	N.C.			
For making up body assemblies with 3, 4, 5 or max. of 6 contact blocks or replacing 1st or 2nd contact block	1	-			ZB2BE101
	-	1			

Mounting base with contact block(s) "Quick connect" \*

Type	Contacts		N.O.	N.C.	Catalog Number
	N.O.	N.C.			
1 Contact Block	1	-			ZB2BZ1013
	-	1			ZB2BZ1023
2 Contact Blocks	2	-			ZB2BZ1033
	-	2			ZB2BZ1043
	1	1			ZB2BZ1053

Additional contact blocks "Quick Connect" \*

Type	Contacts		N.O.	N.C.	Catalog Number
	N.O.	N.C.			
For making up body assemblies with 3, 4, 5 or max. of 6 contact blocks or replacing 1st or 2nd contact block	1	-			ZB2BE1013
	-	1			

Spare parts

Description		Catalog Number
Mounting Base only	With fixing screws	ZB2BZ009
Quick Connect *	Fitting by customer	ZB2BZ003

- \* Quick connect contact blocks will accept commercially available female quick slide connector (1 x 0.25" or 2 x 0.11")
- ◆ Non-illuminated devices can be configured with 6 contacts maximum (3 decks of 2).
- N.C. contact is direct opening operation conforming to EN 60 947-5-1, Section 3.

Limited Availability  
 For replacement use only.  
 For new applications, use  
 XB4 (page 37 - 72)

Non-Illuminated Operators . . . . . Pages 315-317  
 Specialty Contacts . . . . . Page 329  
 Application Information . . . . . Page 314  
 Accessories . . . . . Page 331  
 Replacement Parts . . . . . Page 332  
 Dimensions . . . . . Pages 334-335

**Pilot light heads**



**Standard  
ZB2BV\*\***



**Special lens for neon and  
LED bulbs  
ZB2BV0\*\***



**Direct supply  
ZB2BV6**

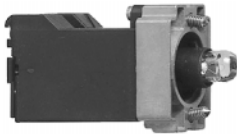

**Transformer type  
ZB2BV3**

Type	Color	Catalog Number
Standard	White	ZB2BV01
	Green	ZB2BV03
	Red	ZB2BV04
	Amber	ZB2BV05
	Blue	ZB2BV06
	Clear	ZB2BV07
	Special lens for neon and LED bulbs	Green
Red		ZB2BV043
Amber		ZB2BV053
Blue		ZB2BV063
Glass lens (NEMA Type 1 only)	Clear	ZB2BV073
	Green	ZB2BV032
	Red	ZB2BV042
	Amber	ZB2BV052
	Clear	ZB2BV072

**Pilot light modules ♦**

Type	Catalog Number
Direct supply (incandescent bulb included)* (AC/DC)	ZB2BV6*
Transformer type (1.2 VA/6 V bulb included) (AC only)	
24 V: 50-60 Hz	ZB2BV1
48 V: 50-60 Hz	ZB2BV2
110 V: 50 Hz    110-120 V: 60 Hz	ZB2BV3
127 V: 50 Hz	ZB2BV91
220 V: 50 Hz	ZB2BV4
240 V: 50 Hz    220-240 V: 60 Hz	ZB2BV94
380 V: 50 Hz	ZB2BV5
415 V: 50 Hz	ZB2BV9
440-480 V: 60 Hz	ZB2BV95
500 V: 50 Hz	ZB2BV8
550-660 V: 60 Hz	ZB2BV98
Resistor type (130 V bulb included).	
220/250 V (AC/DC)	ZB2BV7

\* Complete catalog number by adding one of the following voltages: 6, 12, 24, 48 or 120 V. If desired without bulb, omit voltage.  
 ♦ Light module assemblies are available with quick connectors. Add suffix "3" to end of part number.  
 Example: ZB2BV6 becomes ZB2BV63.

Replacement Bulbs . . . . . Page 332  
 Application Information . . . . . Page 314  
 Accessories . . . . . Page 331  
 Replacement Parts . . . . . Page 332  
 Dimensions . . . . . Pages 334-335

# Push Buttons and Operator Interface Specifiers Guide

## XB2B 22 mm Illuminated Operators



### Operator



Flush Head  
ZB2BW3



Flush Head for LED  
ZB2BW3



Extended Head  
ZB2BW1



Extended Head for LED  
ZB2BW1



Silicon Booted Flush Head  
ZB2BW5

Type	Color	Catalog Number
Flush head	White	ZB2BW31
	Green	ZB2BW33
	Red	ZB2BW34
	Amber	ZB2BW35
	Blue	ZB2BW36
	Clear	ZB2BW37
Flush head for neon and LED lamps	Green	ZB2BW333
	Red	ZB2BW343
	Amber	ZB2BW353
	Blue	ZB2BW363
Extended head	Clear	ZB2BW373
	White	ZB2BW11
	Green	ZB2BW13
	Red	ZB2BW14
	Amber	ZB2BW15
	Blue	ZB2BW16
Extended head for neon and LED lamps	Clear	ZB2BW17
	Green	ZB2BW133
	Red	ZB2BW143
	Amber	ZB2BW153
	Blue	ZB2BW163
	Clear	ZB2BW173
	Green	ZB2BW53
Silicon booted flush head Use with mylar circular legend (ZB2BY1) See page 333	Red	ZB2BW54
	Amber	ZB2BW55
	Blue	ZB2BW56
	Clear	ZB2BW57
	Green	ZB2BV031
	Red	ZB2BV041
Push to test	Amber	ZB2BV051
	Blue	ZB2BV061
	Clear	ZB2BV071

### Operating heads with black metal bezel

To order, add suffix 7 to the above references.  
Example: **ZB2BV071** becomes **ZB2BV0717**.

Limited Availability  
For replacement use only  
For new applications, use  
XB4 (page 37-2)

Light Module Assemblies . . . . .	Page 328
Specialty Light Modules . . . . .	Page 330
Application Information . . . . .	Page 314
Legend Plates . . . . .	Page 333
Accessories . . . . .	Page 331
Replacement Parts . . . . .	Page 332
Dimensions . . . . .	Pages 334-335



40 mm Mushroom head  
ZB2BW\*\*



Two Flush  
Amber Indicator  
ZB2BW8\*\*54

**Mushroom operator**

Type	Color	Catalog Number
40 mm Mushroom head 2 position momentary	Green	ZB2BW43
	Red	ZB2BW44
	Amber	ZB2BW45
	Blue	ZB2BW46
	Clear	ZB2BW47
40 mm Mushroom head 2 position maintained	Green	ZB2BW63
	Red	ZB2BW64
	Amber	ZB2BW65
	Blue	ZB2BW66
	Clear	ZB2BW67

**Two button with amber indicator\* NEMA Type 1 only\***

Type	Marked	Color	Catalog Number
Two Flush		Black/Red	ZB2BW81254
		Green/Red	ZB2BW81354
	I,O	Black/Red	ZB2BW82254
	I,O	Green/Red	ZB2BW82354
	START,STOP	Black/Red	ZB2BW87254
One flush, one extended	START,STOP	Green/Red	ZB2BW87354
		Black/Red	ZB2BW83254
		Green/Red	ZB2BW83354
	I,O	Black/Red	ZB2BW84254
	I,O	Green/Red	ZB2BW84354
	START,STOP	Black/Red	ZB2BW88254
	START,STOP	Green/Red	ZB2BW88354

- \* Additional color indicators available, contact local field office for details.
- ◆ To upgrade to NEMA Type 3, 4, 13 order clear silicon boot ZB2BW008.

**Operating heads with black metal bezel**

To order, add suffix 7 to the above references.  
Example: **ZB2BW64** becomes **ZB2BW647**.

Light Module Assemblies ..... Page 328  
 Specialty Light Modules ..... Page 330  
 Application Information ..... Page 314  
 Legend Plates ..... Page 333  
 Accessories ..... Page 331  
 Replacement Parts ..... Page 332  
 Dimensions ..... Pages 334-335





Selector switch  
 ZB2BK1

**Selector Switches**

Number of positions, action	Color	Catalog Number
2-maintained	Green	ZB2BK123
	Red	ZB2BK124
	Amber	ZB2BK125
	Blue	ZB2BK126
	Clear	ZB2BK127
2-spring return from right to left	Green	ZB2BK143
	Red	ZB2BK144
	Amber	ZB2BK145
	Blue	ZB2BK146
3-maintained	Green	ZB2BK133
	Red	ZB2BK134
	Amber	ZB2BK135
	Blue	ZB2BK136
	Clear	ZB2BK137
3-spring return to center from right and left	Green	ZB2BK153
	Red	ZB2BK154
	Amber	ZB2BK155
	Blue	ZB2BK156
	Clear	ZB2BK157
3-spring return from right to center	Green	ZB2BK183
	Red	ZB2BK184
	Amber	ZB2BK185
	Blue	ZB2BK186
	Clear	ZB2BK187
3-spring return from left to center	Green	ZB2BK173
	Red	ZB2BK174
	Amber	ZB2BK175
	Blue	ZB2BK176
	Clear	ZB2BK177

Limited Availability  
 For replacement use only  
 For new applications, use  
 XB4 (page 37 - 72)

**Selector Switch Sequences (using contact block assemblies, page 328)**

2 Position selector switch		
		Contact block guide
O	X	1 N.O. (left or right)
X	O	1 N.C. (left or right)
O	X	1 N.O. and
X	O	1 N.C.

Note: View from front of panel

3 Position selector switch			
			Contact block guide
X	O	O	1 N.O. (left)
O	X	O	2 NC wired in series (side-by-side)
O	O	X	1 N.O. (right)
X	X	O	1 N.C. (right)
O	X	X	1 N.C. (left)
X	O	X	2 NO wired in parallel (side-by-side)

**Operating heads with black metal bezel**

To order, add suffix 7 to the above references.  
 Example: **ZB2BK123** becomes **ZB2BK1237**.

Light Module Assemblies..... Page 328  
 Specialty Light Modules..... Page 330  
 Application Information..... Page 314  
 Legend Plates..... Page 333  
 Accessories..... Page 331  
 Dimensions..... Pages 334-335



**40 mm Mushroom head**



**Non-Illuminated  
XB2BN\*\*\***



**Illuminated  
(Direct Supply)  
XB2BN\*\*\*6**



**Illuminated  
(Transformer type)  
XB2BN\*\*\***

Type	Push position*	Color	Catalog Number 1N.O. - 1N.C..	Catalog Number 2N.O. - 2N.C.	
Non-illuminated M: Maintained SR: Spring Return	M	White	XB2BN111	XB2BN112	
	M	Green	XB2BN311	XB2BN312	
	M	Red	XB2BN411	XB2BN412	
	M	Amber	XB2BN511	XB2BN512	
	M	Blue	XB2BN611	XB2BN612	
	M	Clear	XB2BN711	XB2BN712	
	SR	White	XB2BN121	XB2BN122	
	SR	Green	XB2BN321	XB2BN322	
	SR	Red	XB2BN421	XB2BN422	
	SR	Amber	XB2BN521	XB2BN522	
	SR	Blue	XB2BN621	XB2BN622	
	SR	Clear	XB2BN721	XB2BN722	
	Illuminated Direct supply	M	White	XB2BN1161	XB2BN1162
		M	Green	XB2BN3161	XB2BN3162
		M	Red	XB2BN4161	XB2BN4162
M		Amber	XB2BN5161	XB2BN5162	
M		Blue	XB2BN6161	XB2BN6162	
M		Clear	XB2BN7161	XB2BN7162	
SR		White	XB2BN1261	XB2BN1262	
SR		Green	XB2BN3261	XB2BN3262	
SR		Red	XB2BN4261	XB2BN4262	
SR		Amber	XB2BN5261	XB2BN5262	
SR		Blue	XB2BN6261	XB2BN6262	
SR		Clear	XB2BN7261	XB2BN7262	
Illuminated Transformer Type 110/120 V (lamp included)		M	White	XB2BN1131	XB2BN1132
		M	Green	XB2BN3131	XB2BN3132
		M	Red	XB2BN4131	XB2BN4132
	M	Amber	XB2BN5131	XB2BN5132	
	M	Blue	XB2BN6131	XB2BN6132	
	M	Clear	XB2BN7131	XB2BN7132	
	SR	White	XB2BN1231	XB2BN1232	
	SR	Green	XB2BN3231	XB2BN3232	
	SR	Red	XB2BN4231	XB2BN4232	
	SR	Amber	XB2BN5231	XB2BN5232	
	SR	Blue	XB2BN6231	XB2BN6232	
	SR	Clear	XB2BN7231	XB2BN7232	
	Illuminated Transformer Type 220/240V (lamp included)	M	White	XB2BN1141	XB2BN1142
		M	Green	XB2BN3141	XB2BN3142
		M	Red	XB2BN4141	XB2BN4142
M		Amber	XB2BN5141	XB2BN5142	
M		Blue	XB2BN6141	XB2BN6142	
M		Clear	XB2BN7141	XB2BN7142	
SR		White	XB2BN1241	XB2BN1242	
SR		Green	XB2BN3241	XB2BN3242	
SR		Red	XB2BN4241	XB2BN4242	
SR		Amber	XB2BN5241	XB2BN5242	
SR		Blue	XB2BN6241	XB2BN6242	
SR		Clear	XB2BN7241	XB2BN7242	
Mushroom lens only			White	W40429264001	
			Green	W40429264003	
			Red	W40429264004	
		Amber	W40429264005		
		Blue	W40429264006		
	Clear	W40429264007			

\* Position status: Position 1 - Pull, Spring return, Position 2- Center, Maintained, Position 3 - Push, Maintained or spring return.  
 ♦ Contacts cannot be modified or interchanged; therefore operators are not sold separately.

**1 N.O./1 N.C.**

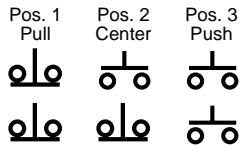

**2 N.O./2 N.C.**

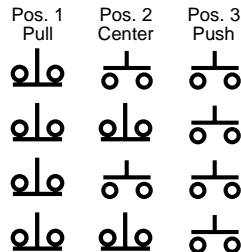

Application Information. . . . . Page 314  
 Legend Plates . . . . . Page 333  
 Accessories . . . . . Page 331  
 Replacement Parts. . . . . Page 332  
 Dimensions . . . . . Pages 334-335



**Push Buttons and Operator Interface Specifiers Guide**  
**XB2B 22 mm**  
**Light Module Assemblies**



**Light module assemblies with contact block(s) screw clamp connectors\***

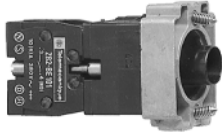

**Direct supply**  
**ZB2BW06**



**Transformer type**  
**ZB2BW03**



**Resistor type**  
**ZB2BW075**



**Additional contact block**  
**ZB2BE10**

Type	Contacts		Catalog Number
	N.O.	N.C.	
<b>Direct supply (incandescent bulb included) (AC/DC)</b>			
Without contacts♦	-	-	ZB2BW060+
1 Contact block	1	-	ZB2BW061+
	-	1	ZB2BW062+
2 Contact blocks	2	-	ZB2BW063+
	-	2	ZB2BW064+
	1	1	ZB2BW065+
<b>Transformer type (1.2 VA/6 V AC incandescent bulb included) (AC only)†</b>			
Without contacts♦	-	-	ZB2BW0*0
1 Contact block	1	-	ZB2BW0*1
	-	1	ZB2BW0*2
2 Contact blocks	2	-	ZB2BW0*3
	-	2	ZB2BW0*4
	1	1	ZB2BW0*5
<b>Resistor type (130 V incandescent bulb included) 220-250 V supply</b>			
2 Contact blocks	1	1	ZB2BW075

**Additional contact blocks ♦ ■**





Type	Contacts		Catalog Number
	N.O.	N.C.	
For making up body assemblies with 3 or maximum 4 contact blocks or replacing 1st or 2nd contact block	1	-	ZB2BE101
	-	1	■ ZB2BE102

- + Complete catalog number by adding one of the following voltages: 6, 12, 24, 48 or 120 V AC/DC.  
 Note: If desired without bulb, omit voltage.
- \* Select proper digit for voltage desired: **1** (24 V 50/60 Hz) **2**(48 V 50/60 Hz) **3** (110/120 V 50/60 Hz).  
**94** (220/240 V 60 Hz) **95** (440/480 V 60 Hz) **98** (550/600 V 60 Hz).
- ♦ Illuminated devices can be configured with a light module and 4 contacts maximum (2 decks of 2).
- † Additional primary voltages available, contact local field office for details.
- Contact blocks and light module assemblies are available with quick connectors. Add suffix "3" to end of part number.  
 Example: ZB2BW061 becomes ZB2BW0613.
- N.C. contact is direct opening operation conforming to EN 60 947-5-1, Section 3.

**Limited Availability**  
**For replacement use only.**  
**For new applications, use**  
**XB4 (page 37 - 72)**

Illuminated Operators ..... Pages 324-326  
 Specialty Light Modules. .... Page 330  
 Application Information ..... Page 314  
 Legend Plates ..... Page 333  
 Accessories ..... Page 331  
 Replacement Parts ..... Page 332  
 Dimensions ..... Pages 334-335



Specialty contact blocks		N.O. 	N.C. 
Type	Description	Number of contacts	Catalog Number
Low voltage / low current Gold flashed contacts 5-24 volt 0.1-100 mA	Contact block without mounting base	1-N.O.	ZB2BE1016
		1-N.C.	ZB2BE1026
		1-N.O.	ZB2BZ1016
		1-N.C.	ZB2BZ1026
Overlapping, sequencing & time delay contact blocks	Contact block w/o mounting base	1-N.O. Early closing	ZB2BE201
		1-N.C. Late opening	ZB2BE202
	Overlapping block w/mounting base	1-NO (early closing) & 1-NC (late opening)	ZB2BZ106
	Sequencing block w/mounting base	1-NO (early closing) & 1-N.O.	ZB2BZ107
	0.1-30 sec. time delay block w/mounting base (on delay)	1-N.O. & 1-N.C.	ZB2BZ91
	10-180 sec. time delay block w/mounting base (on delay)	1-N.O. & 1-N.C.	ZB2BZ92
Contact blocks for ring tongue lugs with widths smaller than 0.312" (8 mm)		1-N.O.	ZB2BE1019
		1-N.C.	ZB2BE1029

Limited Availability  
 For replacement use only.  
 For new applications, use  
 XB4 (page 37 - 72)

Application Information .....	Page 314
Accessories .....	Page 331
Replacement Parts .....	Page 332
Dimensions .....	Pages 334-335



Flashing pilot light base  
 ZB2BV184

**Specialty Light Modules**

Type	Description	Supply Voltage	Catalog Number
Flashing pilot light base	Light Module with incandescent bulb included	120 Vac	ZB2BV184
Flashing illuminated push button base	Light Module with incandescent bulb and 1 N.O./1 N.C. included	120 Vac	ZB2BW1845

**Typical Wiring Diagrams**

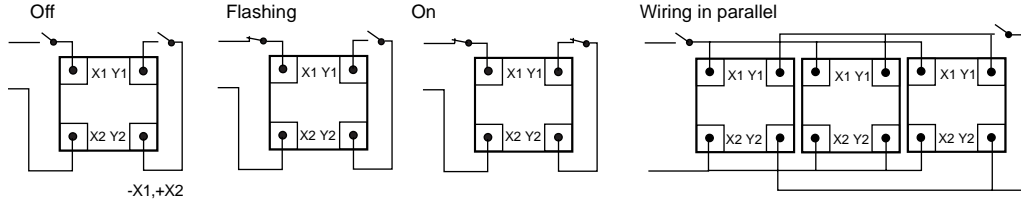

Remote test pilot light base  
 ZB2BV156

Type	Description	Supply Voltage	Catalog Number
Remote test pilot light base	Single Diode	<380 V ac or dc	ZB2BV156■

■ When ordering, specify voltage required (6-120 V) Example: ZB2BV156120V

**Typical Wiring Diagram – Single Diode**

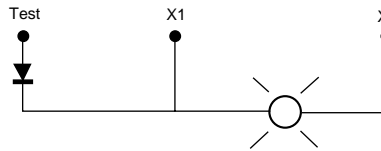

Type	Description	Supply Voltage	Catalog Number
Remote test pilot light base	Dual Diode	<380 V ac or dc	ZB2BV68

**Typical Wiring Diagram – Dual Diode**

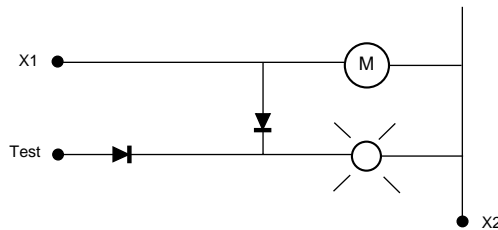

Limited Availability  
 For replacement use only.  
 For new applications, use  
 XB4 (page 37 - 72)

Illuminated Operators . . . . . Pages 324-326  
 Application Information . . . . . Page 314  
 Legend Plates . . . . . Page 333  
 Accessories . . . . . Page 331  
 Replacement Parts . . . . . Page 332  
 Dimensions . . . . . Pages 334-335

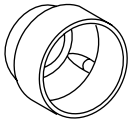
**XB2B Accessories**

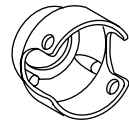
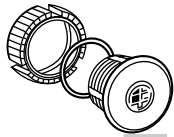
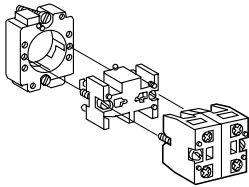
**ZB2BZ16**

**ZB2BZ17**

**ZB2BZ18**

**ZB2SZ3**

**ZB2BZ21**

Type	Description	Color	Catalog Number	
Boots	Silicon boot for rectangular push button w/indicator light		ZB2BW008	
	Silicon boot for rectangular push button w/o light		ZB2BA008	
Guards/Locks	40 mm for Momentary Mushrooms (metal)	Blue	ZB2BZ1601	
		Black	ZB2BZ1602	
		Red	ZB2BZ1604	
	40 mm with finger cut-out for push-pull (metal)	Yellow	ZB2BZ1605	
		Blue	ZB2BZ1701	
		Black	ZB2BZ1702	
	40 mm with finger cut-out and 7mm holes for padlocking (metal)	Red	ZB2BZ1704	
		Yellow	ZB2BZ1705	
		Blue	ZB2BZ1801	
	60 mm mushroom guard (black plastic) no padlocking provision	Black	ZB2BZ1802	
		Red	ZB2BZ1804	
		Yellow	ZB2BZ1805	
		60 mm guard for 40 mm T-T-R EMO button (yellow plastic)		ZB2BZ1905
		Padlock attachment (makes flush operator inaccessible)		ZB2BZ26
	Closing plates 22 mm	Black plastic		ZB2SZ3
Gray plastic			ZB2 SZ4	
Blue metallic			ZB2SZ2	
Miscellaneous accessories	Adapter for mounting into 1 3/16" (30 mm) hole and used with 30 mm P.B. nameplate		ZB2BZ41	
	Adapter for mounting into 30 mm hole and use with XB2B nameplate		ZB2BZ4	
	Base only-for mounting contact blocks		ZB2BZ009	
	Add on push-on/push-off mechanism		ZB2BZ21	
	Bulb extractor for use with BA9s		XBFX13	

Limited Availability  
 For replacement use only.  
 For new installations, use  
 XB4 (page 37 - 72)

# Push Buttons and Operator Interface Specifiers Guide

## XB2B 22 mm Accessories and Replacement Parts



### Lamps

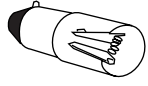

DL1CE...  
(incandescent)

Type	Voltage AC/DC	Watts	Catalog Number
Incandescent Replacement bulbs (Type BA9s)	6	1.5	DL1CB006
	12	2.0	DL1CE012
	24	2.0	DL1CE024
	48	2.4	DL1CE048
	130	2.6	DL1CE130
Neon (use with direct supply light module)	120	-	NE51HRT120V
	220	-	NE51HRT220V
	380	-	NE51HRT380V

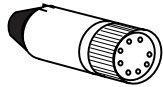

DL1CJUS...  
(LED)

Type	Color	Voltage	Part Number
LED, BA9s base for Direct Supply blocks	Green	6 Vac/dc	DL1CJUS0063
	Red	6 Vac/dc	DL1CJUS0064
	Amber	6 Vac/dc	DL1CJUS0065
	Green	12 Vac/dc	DL1CJUS0123
	Red	12 Vac/dc	DL1CJUS0124
	Amber	12 Vac/dc	DL1CJUS0125
	Green	24 Vac/dc	DL1CJUS0243
	Red	24 Vac/dc	DL1CJUS0244
	Amber	24 Vac/dc	DL1CJUS0245
	Green	120 Vac/dc	DL1CJUS1203
	Red	120 Vac/dc	DL1CJUS1204
	Amber	120 Vac/dc	DL1CJUS1205
LED, BA9s base for retrofitting into transformer Light Modules	Green	9 Vac only	DL1CJUS0093
	Red	9 Vac only	DL1CJUS0094
	Amber	9 Vac only	DL1CJUS0095

### Replacement Lenses, Boots and Keys



ZB2BV...



ZB2BW93...



ZB2BP012



Q99900901

Type	Description	Catalog Number
Replacement lenses	Lens - standard pilot light	ZB2BV01●
	Lens kit - standard pilot light (includes lens, diffuser & gasket)	ZB2BV02●
	Lens - pilot light (jeweled for LED & Neon)	ZB2BV01●3
	Lens - flush illuminated push buttons	ZB2BW91●
	Lens - flush illuminated push buttons (Jeweled for LED & Neon)	ZB2BW93●3
	Lens - extended push buttons	ZB2BW93●
	Lens - extended push buttons (jeweled for LED & Neon)	ZB2BW93●3
	Lens - push-to-test	ZB2BV01●1
	Lens - rectangle for ZB2BW80000 series (2 button with indicator)	ZB2BW90●
	Lens - 40 mm mushroom	W4042926400●
Replacement boots	Replacement silicon boot for ZB2BP series operators	ZB2BP01†
	Replacement neoprene boot for ZB2BP series operators	ZB2BP02†
Replacement keys	Replacement key for standard selector switches and key release mushroom operators. Qty. 1 - Ronis key #455	Q99900901
	Key # 421	Qty. 1 Q99900911
	Key # 458A	Qty. 1 Q99900910
	Key # 520	Qty. 1 Q99900912
	Key # 3131A	Qty. 1 Q99900915

- Complete lens part number by replacing with digit for desired color. (1- white, 3- green, 4-red, 5- amber, 6- blue, 7-clear). **Example ZB2BV013 green standard pilot lens. Note: Jeweled lens not available in white.**
- † Complete boot part number by replacing with digit for desired color. (2- black, 3- green, 4- red, 5- yellow, 6- blue, 7-clear). **Example ZB2BP013 green silicon boot.**



**PVC Standard legend plates 30 x 40 mm**



Text★	Catalog Number
Close	ZB2BY2314
Down	ZB2BY2308
Emergency Stop	ZB2BY2330
Fast	ZB2BY2328
Forward	ZB2BY2305
For Rev	ZB2BY2371
For-O-Rev	ZB2BY2384
Hand Off Auto	ZB2BY2387
High	ZB2BY2338
High Low	ZB2BY2369
In	ZB2BY2503
Inch	ZB2BY2321
Jog For	ZB2BY2381
Jog Rev	ZB2BY2380
Jog Run	ZB2BY2365
Left	ZB2BY2310
Low	ZB2BY2336
Lower	ZB2BY2337
Man-Auto	ZB2BY2372
Off	ZB2BY2312

Text★	Catalog Number
On	ZB2BY2311
Off On	ZB2BY2367
Open	ZB2BY2313
Open Close	ZB2BY2376
Open-O-Close	ZB2BY2388
Out	ZB2BY2339
Power On	ZB2BY2326
Raise	ZB2BY2335
Reset	ZB2BY2323
Reverse	ZB2BY2306
Right	ZB2BY2309
Run	ZB2BY2334
Slow	ZB2BY2327
Start	ZB2BY2303
Stop	ZB2BY2304
Stop Start	ZB2BY2366
Up	ZB2BY2307
Up Down	ZB2BY2370
Up-O-Down	ZB2BY2389

★ All nameplates are black w/white lettering except "Stop", "Emergency Stop" and "Reset" which are red w/white lettering. For black "Reset" change final digit of catalog number to 2.



ZB2BY8330

**PVC Yellow Legend Plates 60 mm diameter**

Text	Language	Catalog Number
Blank	N/A	ZB2BY9101
Emergency Stop	English	ZB2BY9330
Arret d'Urgence	French	ZB2BY9130
Not Aus	German	ZB2BY9230
Parada de Emergencia	Spanish	ZB2BY9430
Arresto Emergenza	Italian	ZB2BY9630

**PVC Yellow Legend Plates 90 mm diameter**

Text	Language	Catalog Number
Blank	N/A	ZB2BY8101
Emergency Stop	English	ZB2BY8330
Arret d'Urgence	French	ZB2BY8130
Not Aus	German	ZB2BY8230
Parada de Emergencia	Spanish	ZB2BY8430
Arresto Emergenza	Italian	ZB2BY8630

Type	Description	Catalog Number		
PVC blank legend	Blank	Black or red background-30 mm x 40 mm	ZB2BY2101	
	Blank	Yellow or white background-30 mm x 40 mm	ZB2BY4101	
	Blank	Red background-45 mm x 67.5 mm (For use w/mushroom head operators)	ZB2BY5101	
	Blank	Oversized legend-48 mm x 48 mm (For use with XB2 operators)	XBCY22011	
Metal legend plates	Blank	Black or red background- 30 mm x 48 mm (For use w/2 position joysticks)	ZD2GY2201	
	Silver	30 x 40 mm	ZB2BY2011	
		30 x 50 mm	ZB2BY6011	
		30 x 40 mm	ZB2BY2021	
30 x 50 mm		ZB2BY6021		
PVC custom engraved	Red	30 x 40 mm	ZB2BY2041	
		30 x 50 mm	ZB2BY6041	
		Special engraving†	Black background, white letters-30 mm x 40 mm	ZB2BY2002
		Special engraving†	Red background, white letters-30 mm x 40 mm	ZB2BY2004
PVC custom engraved	Special engraving†	White background, black letters-30 mm x 40 mm	ZB2BY4001	
		Yellow background, black letters-30 mm x 40 mm	ZB2BY4005	
		Red background, white letters-45 mm x 67.5 mm	ZB2BY5004	

† Please specify lettering when ordering. Two lines with 11 characters (including spaces) maximum on each line.

**Mylar Circular Legends**

Type	Description	Catalog Number
Mylar circular legends for use with transparent flush head operators See page 315, 324	No text	ZB2BY1101
	O	ZB2BY1146
	I	ZB2BY1147
	Auto	ZB2BY1115
	Hand	ZB2BY1316
	Off	ZB2BY1312
	On	ZB2BY1311
	Start	ZB2BY1303
	Stop	ZB2BY1304
	Forward	ZB2BY1305
	Reverse	ZB2BY1306

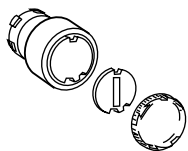

# Push Buttons and Operator Interface Specifiers Guide

## XB2B 22 mm



### Dimensions

ZB2BA•  
ZB2BA•8  
ZB2BA•9  
ZB2BW3•

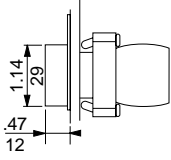

ZB2BA•6

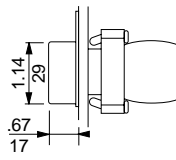

ZB2BL•  
ZB2BW1•

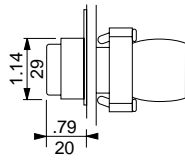

ZB2BH•

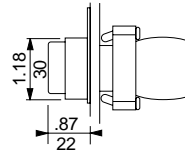

ZB2BP•  
ZB2BW5•

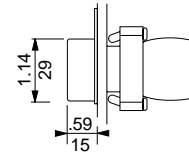

ZB2BC•  
ZB2BT•  
ZB2BS54  
ZB2BW4•

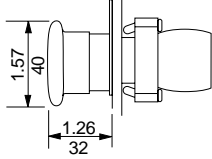

ZB2BR•  
ZB2BX•  
ZB2BS64

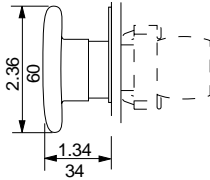

ZB2BS14

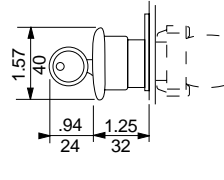

ZB2BS24

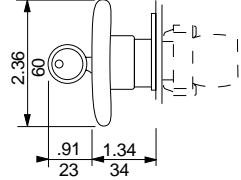

ZB2BS844

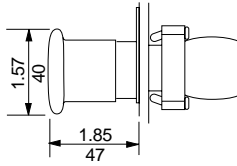

ZB2BS944

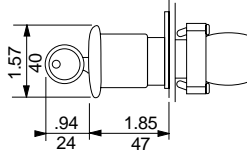

ZB2BD\*\*\*  
ZB2BK1\*\*\*

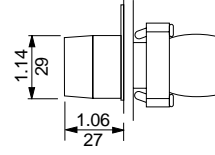

ZB2BJ\*\*\*

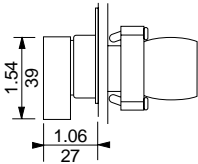

ZB2BG•

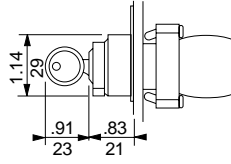

ZB2BVO•  
ZB2BVO•3

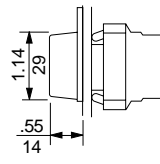

ZB2BVO•1

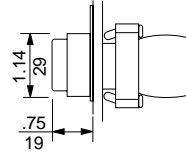

ZB2BVO•2

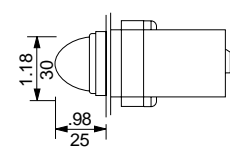

ZB2BD922

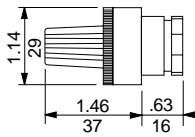

Dual Dimensions inches  
mm

ZB2BA91•4

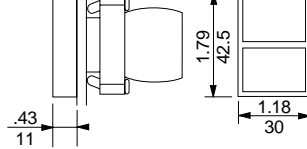

ZB2 BL93•4

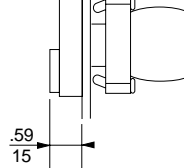

ZB2BW81\*\*\*

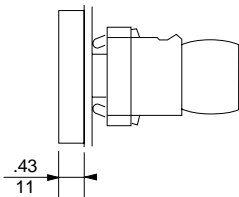

ZB2BW83\*\*\*

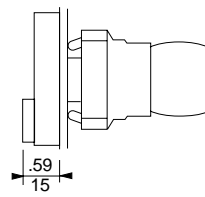

ZB2BB•

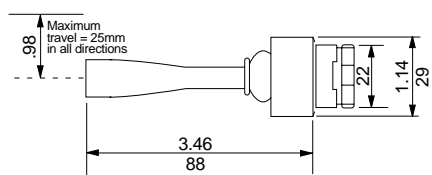

**Dimensions**

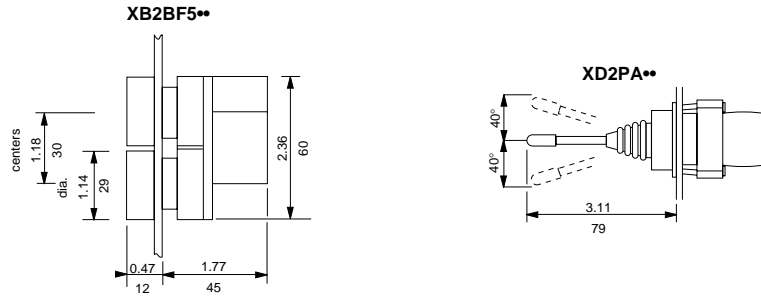

**Contact blocks and bases only**  
**ZB2BZ10•, ZB2BZ10\*\*,**  
**ZB2BE10•, ZB2BE10\*\*,**  
**ZB2BE20•**

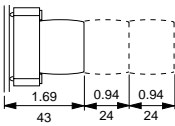

**ZB2BV6**

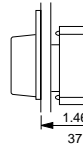

**ZB2BV7**

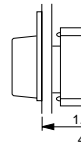

**ZB2BV1, ZB2BV2**  
**ZB2BV3, ZB2BV9•**

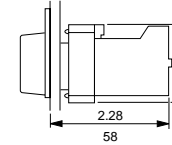

**ZB2 BW06•**

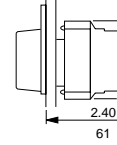

**ZB2BW075**

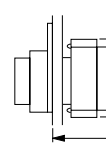

**ZB2BW0\*\***

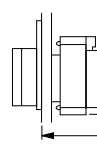

**ZB2BW184**  
**ZB2BW1845**  
**ZB2BV68**

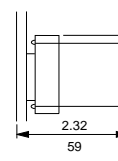

**ZB2BZ9•**

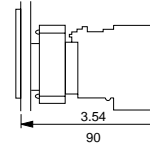

**MOUNTING DIMENSIONS (Minimum spacing)**  
**General mounting set-up**

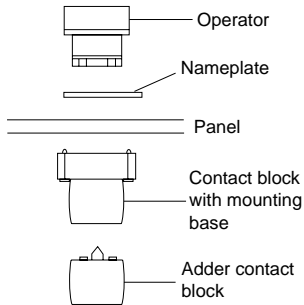

**Standard pushbuttons and pilot lights**

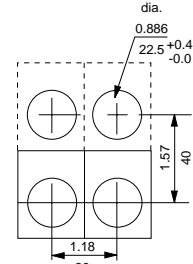

**2 Position Joysticks**

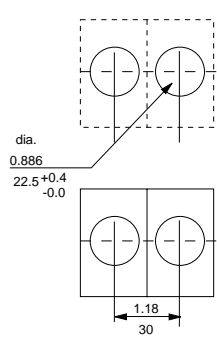

**4 Position Joysticks**

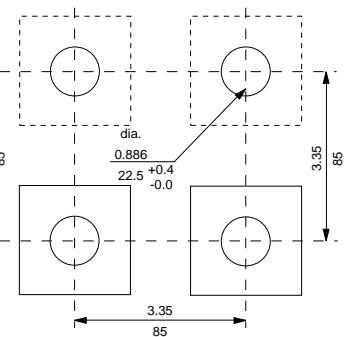

**Rectangular units w/o indicator**

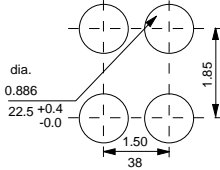

**Rectangular units w/ indicator**

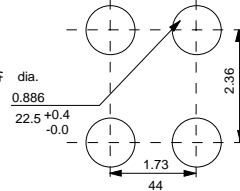

Dual Dimensions inches  
mm



**Push Buttons and Operator Interface Specifiers Guide**  
**XB2B 22 mm**  
**Mounting Instructions**

**Mounting Instructions for ZB2B**

1. The panel knockout must be 7/8" (22.3 mm) with a panel thickness of 1 to 6 mm (0.04 in to 0.23 in). No anti-rotation notch is required.
2. Insert the operator through the knockout.
3. Bayonet lock the operator into the diecast mounting base with a 1/8 clockwise turn.
4. Orient the angled fixing screws at 12 and 6 o'clock and alternately tighten the 2 screws.
5. The fixing screws will bite into the metal of the inside panel door and provide anti-rotation and a tamper proof installation.

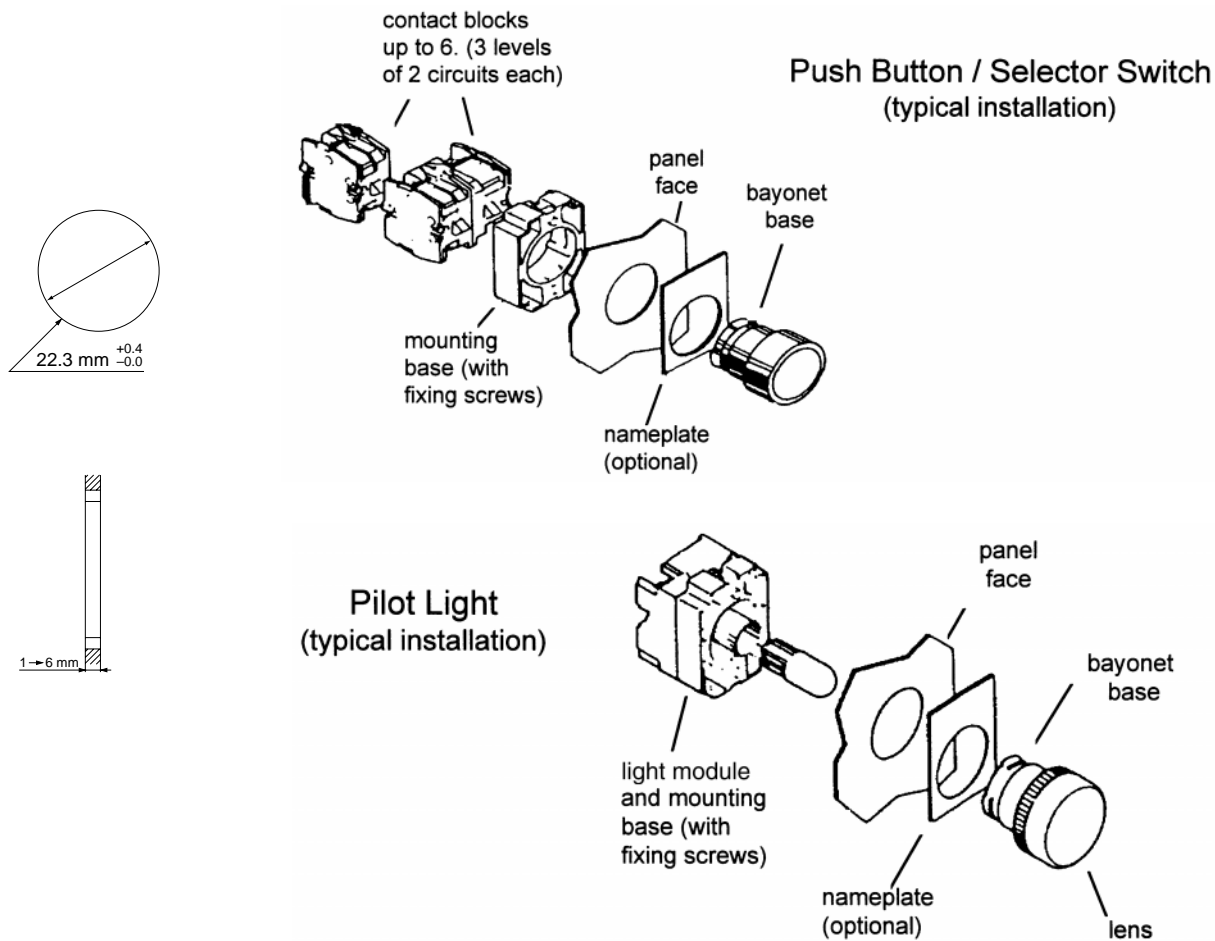

**Limited Availability**  
**For replacement use only.**  
**For new applications, use**  
**XB4 (page 37 - 72)**