

6

5

4

3

2

1

MALE INSERT  
FACE VIEW

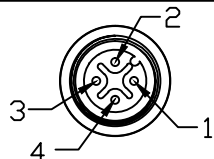

- 1 NO CONNECTION
- 2 RESISTOR
- 3 NO CONNECTION
- 4 RESISTOR

MALE INSERT  
BACK VIEW

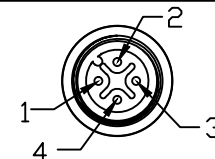

- 1 NO CONNECTION
- 2 RESISTOR
- 3 NO CONNECTION
- 4 RESISTOR

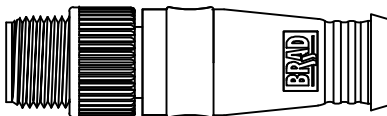

MOLD PER STD-439

WIRING SCHEMATIC

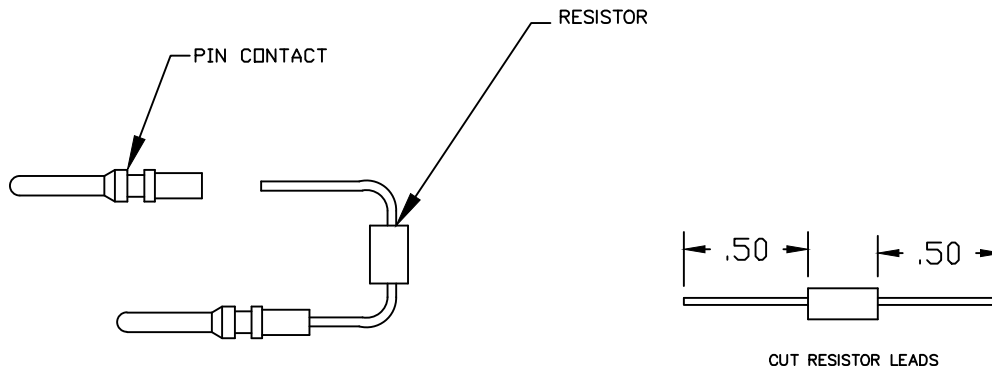
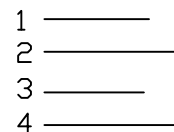

- 1 ALL LEADS OF RESISTOR MUST BE FULLY CRIMPED PER S-294 AND AND SOLDERED PER S-575
- 2 APPLY ADHESIVE PER S-136
- 3 PACKAGE FINISHED PRODUCT PER S-168

REVISE DRAWING EC NO: IPC2013-0297 DRWN: TWOLDEGE 11/12/12 CHKD: VOU APPR: JFMURPHY	DESCRIPTION QUALITY SYMBOLS =0 =0	GENERAL TOLERANCES (UNLESS SPECIFIED)		DIMENSION STYLE INCH		SCALE 1:1	DESIGN UNITS INCH	THIRD ANGLE PROJECTION	
		4 PLACES	mm ±---	INCH ±---	DRAWN BY BJANOWIA	DATE 11/19/2003	TITLE CC-LINK TERMINATOR 4-POLE MALE ST 110 OHM RESISTOR		
		3 PLACES	±---	±.005	CHECKED BY BJ	DATE ---	MOLEX INCORPORATED		
		2 PLACES	±.13	±.010	APPROVED BY ---	DATE ---	DOCUMENT NO. CC100		
		1 PLACE	±.25	±.020	MATERIAL NO.	SHEET NO. 1 OF 1			
		ANGULAR ±1/2°		DRAFT WHERE APPLICABLE MUST REMAIN WITHIN DIMENSIONS		THIS DRAWING CONTAINS INFORMATION THAT IS PROPRIETARY TO MOLEX INCORPORATED AND SHOULD NOT BE USED WITHOUT WRITTEN PERMISSION			

6

5

4

3

2

1

E

E

D

D

C

C

B

B

A

A

MALE INSERT  
FACE VIEW

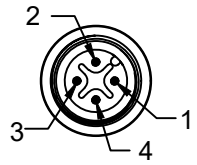

- 1 NO CONNECTION
- 2 RESISTOR
- 3 NO CONNECTION
- 4 RESISTOR

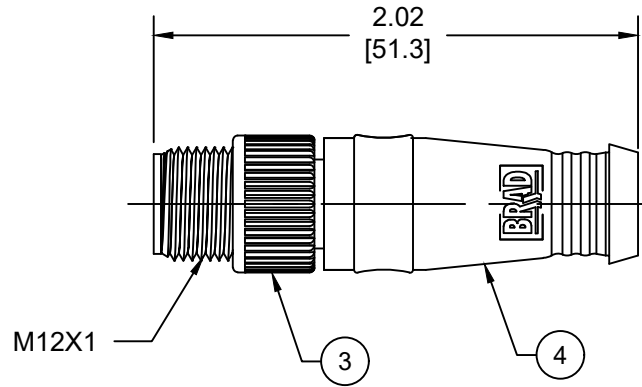
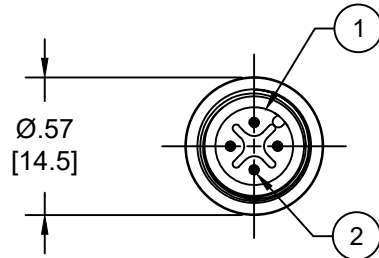

MATERIAL NUMBER	ENGINEERING NUMBER
1300460001	CC100

NOTES:

1. MATERIAL: AS NOTED
2. FINISH: AS NOTED
3. ELECTRICAL:  
VOLTAGE: 24V DC  
CURRENT: 50mA
4. TEMP RATING: 0°C TO +60°C (B)
5. PROTECTION: IP67 (WHEN MATED)
6. ALL DIMENSIONS ARE FOR REFERENCE UNLESS TOLERANCED OR NOTED OTHERWISE

SCHEMATIC

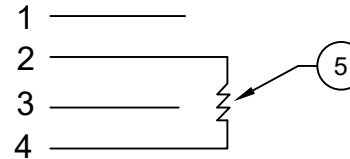

5	RESISTOR	110 OHM 1/2 WATT	
4	OVERMOLD	TPC	GRAY (B)
3	COUPLNG NUT	BRASS	NICKEL PLATED (B)
2	CONTACT PIN	COPPER ALLOY	GOLD OVER NICKEL
1	INSERT	NYLON	BLACK
ITEM	COMPONENT	MATERIAL	FINISH

FUNCTIONAL SYMBOLS	THIS DRAWING CONTAINS INFORMATION THAT IS PROPRIETARY TO MOLEX ELECTRONIC TECHNOLOGIES, LLC AND SHOULD NOT BE USED WITHOUT WRITTEN PERMISSION			
	DIMENSION UNITS	SCALE		CURRENT REV DESC: ITEM #4 WAS PVC. ITEM #3 WAS ZINC DIE CAST. ADDED TEMP RATING
DIVISIONAL SYMBOLS	INCH/MM	NTS		EC NO: 704134 DRWN: ABENJAMINLW 2021/06/04 CHK'D: RSTONE 2022/04/27 APPR: BWOODMAN 2022/05/04
	GENERAL TOLERANCES (UNLESS SPECIFIED)			
		mm	INCH	
	4 PLACES	±----	±----	INITIAL REVISION:
	3 PLACES	±----	±----	DRWN: TWOLDEGE 2012/10/18
	2 PLACES	±----	±----	APPR: JFMURPHY 2012/11/01
	1 PLACE	±----	±----	
	0 PLACES	±----	±----	
	ANGULAR TOL ± ---- °			
	DRAFT WHERE APPLICABLE MUST REMAIN WITHIN DIMENSIONS		THIRD ANGLE PROJECTION	DRAWING A-SIZE
			SERIES 130046	MATERIAL NUMBER SEE CHART
				CUSTOMER GENERAL MARKET
				SHEET NUMBER 1 OF 1

**molex**

MICRO-CHANGE TERMINATOR, M12,  
4-POLE, MALE, STRAIGHT, SINGLE KEY,  
#22 AWG

PRODUCT CUSTOMER DRAWING

DOCUMENT NUMBER	DOC TYPE	DOC PART	REVISION
SD-130046-013	PSD	001	B

DOCUMENT STATUS	P1	RELEASE DATE	2022/05/04	21:13:43
-----------------	----	--------------	------------	----------