

2	1
PART NUMBER	DESCRIPTION
2036030003	MINI-FIT CPA

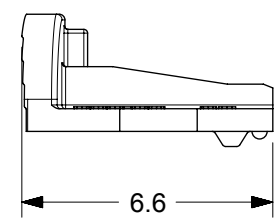

- NOTES:
- 1) MATERIAL:
NYLON V-0, LOW HALOGEN
COLOR: RED
 - 2) FINISH: NOT APPLICABLE;
 - 3) PRODUCT SPECIFICATION: PS-172718-0000
 - 4) PACKAGING: 2036030000-PK
 - 5) PART TO BE USED WITH MOLEX TPA SERIES 172709
 - 6) PART SURFACE AND GEOMETRY TO CONFORM TO CLASS "B" REQUIREMENTS OF COSMETIC SPECIFICATION PS-45499-002.
 - 7) PART COLOR TO CONFORM TO CLASS "C" REQUIREMENTS OF COSMETIC SPECIFICATION PS-45499-002.
 - 8) ENGRAVING LOCATION MAY VARY ON ACTUAL PARTS

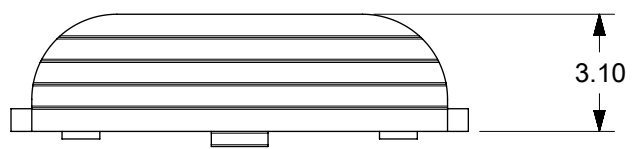
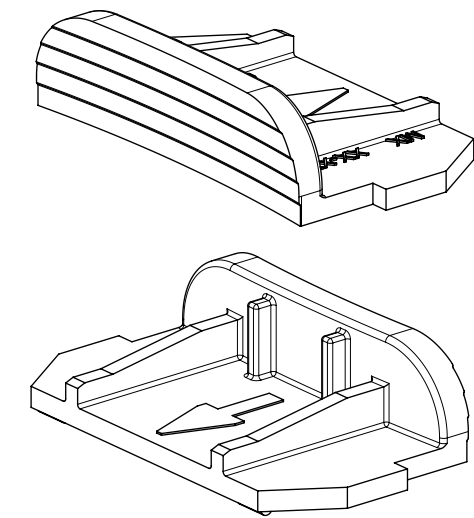
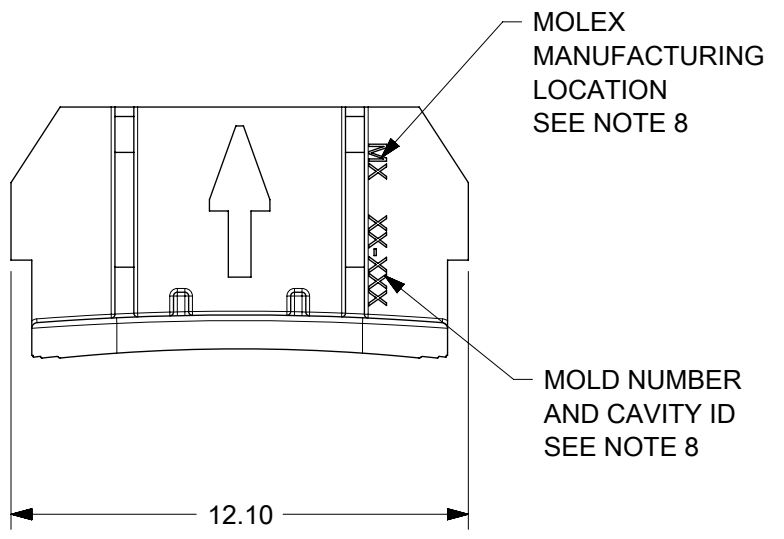
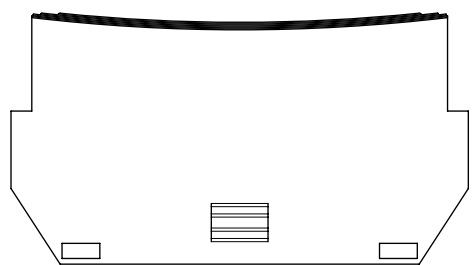

QUALITY SYMBOLS ∇ = 0 ∇ = 0 ∇ = 2 ▼ = 0 ∇ = 0 ⊠ = 0 ■ = 0 ∇ = 0	THIS DRAWING CONTAINS INFORMATION THAT IS PROPRIETARY TO MOLEX ELECTRONIC TECHNOLOGIES, LLC AND SHOULD NOT BE USED WITHOUT WRITTEN PERMISSION											
	EC NO: 600007 DRWN: T GREGORI CHKD: RHODGE APPR: RHODGE	2017/12/20 2017/12/20 2017/12/20	GENERAL TOLERANCES (UNLESS SPECIFIED) ANGULAR TOL ± ° 4 PLACES ± 3 PLACES ± 2 PLACES ± 0.13 1 PLACE ± 0.25 0 PLACES ± DRAFT WHERE APPLICABLE MUST REMAIN WITHIN DIMENSIONS	DIMENSION UNITS: mm SCALE: 10:1 DRWN BY: PPEREZ03 DATE: 2016/12/20 CHK'D BY: DATE: APPR BY: RHODGE DATE: 2016/12/21 DRAWING SIZE: B THIRD ANGLE PROJECTION				MINI-FIT CPA			PRODUCT CUSTOMER DRAWING	
B1	REV	B	3	203603	MATERIAL NUMBER	CUSTOMER	SERIES: 203603	DOCUMENT NUMBER: 2036030000-SD	DOC TYPE: PSD	DOC PART: 000	SHEET NUMBER: 1 OF 1	