

推奨パネル切り取り寸法 (前面取り付け)
RECOMMENDED PANEL OPENING (FRONT MOUNTING)

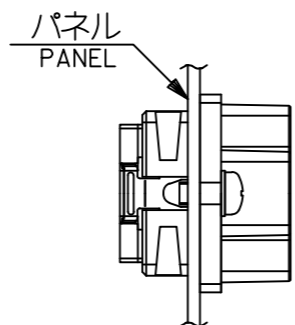
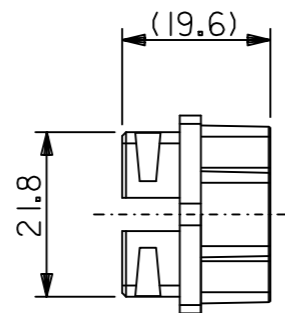

パネル前面取り付け
FRONT MOUNT TYPE

注記
NOTES

- 材質
MATERIAL
亜鉛合金, ニッケルメッキ
ZINC ALLOY, NI PLATING
- 適用ハウジングアッセンブリ: 51233-501* (PIN HS'G ASS'Y)
51238-501* (SOCKET HS'G ASS'Y)
APPLICABLE HOUSING ASS'Y: 51233-501* (PIN HS'G ASS'Y)
51238-501* (SOCKET HS'G ASS'Y)
- 推奨ねじ締め付けトルク: 5~6 kgf・cm
RECOMENDED SCREW TIGHTENING TORQUE: 5~6 kgf・cm

563775000	56377-5000	56377-****
MATERIAL NO.	ENG. NO.	MODEL NO.

FUNCTIONAL SYMBOLS F=0 E=0 P=0	THIS DRAWING CONTAINS INFORMATION THAT IS PROPRIETARY TO MOLEX ELECTRONIC TECHNOLOGIES, LLC AND SHOULD NOT BE USED WITHOUT WRITTEN PERMISSION						
	DIMENSION UNITS MM	SCALE 1:1			CURRENT REV DESC: CONVERTED TO AUTOCAD. TRADEMARK LOGO "MOLEX" CHANGED		
	GENERAL TOLERANCES (UNLESS SPECIFIED)		EC NO: 652148				
	4 PLACES ±--- ±---		DRWN: ABENJAMINLW	2020/11/26			
3 PLACES ±--- ±---		CHK'D: MBIZZOZERO	2021/03/02				
2 PLACES ±--- ±---		APPR: MBIZZOZERO	2021/03/02				
1 PLACE ±--- ±---		INITIAL REVISION:					
0 PLACES ±--- ±---		DRWN: SAKIYAMA	2002/02/05				
ANGULAR TOL ± --- °		APPR: JMIYAZAWA	2002/02/07				
DRAFT WHERE APPLICABLE MUST REMAIN WITHIN DIMENSIONS		THIRD ANGLE PROJECTION	DRAWING	SERIES	MATERIAL NUMBER	CUSTOMER	SHEET NUMBER
			B-SIZE	56377	SEE CHART	GENERAL MARKET	1 OF 1

COMPACT ROBOT CONN. 50CKT. RECEPTACLE SHELL		
PRODUCT CUSTOMER DRAWING		
DOCUMENT NUMBER SD-56377-015	DOC TYPE PSD	DOC PART 001
REVISION A1		